

|                 |       |                  |       |           |       |
|-----------------|-------|------------------|-------|-----------|-------|
| PROJECT:        | _____ | UNIT TAG:        | _____ | QUANTITY: | _____ |
| REPRESENTATIVE: | _____ | TYPE OF SERVICE: | _____ | DATE:     | _____ |
| ENGINEER:       | _____ | SUBMITTED BY:    | _____ | DATE:     | _____ |
| CONTRACTOR:     | _____ | APPROVED BY:     | _____ | DATE:     | _____ |
|                 | _____ | ORDER NO.:       | _____ | DATE:     | _____ |



**CR 1S-15 A-B-A-E-HQQE**

Vertical, multistage centrifugal pump with suction and discharge ports on the same level. The pump head and base are in cast iron. All other wetted parts are in stainless steel (EN 1.4301)(AISI 304)

Product photo could vary from the actual product

| Conditions of Service   | Pump Data  | Motor Data                       |
|-------------------------|--|----------------------------------|
| Flow: _____             | Max pressure at stated temperature: 232 psi / 250 °F | Rated power - P2: 1 HP           |
| Head: _____             | Liquid temperature range: -4 .. 248 °F               | Rated voltage: 208-230YY/460Y V  |
| Efficiency: _____       | Maximum ambient temperature: 140 °F                  | Main frequency: 60 Hz            |
| Liquid: Water           | Approvals: CURUS,NSF61                               | Enclosure class: 55 Dust/Jetting |
| Temperature: 68 °F      | Shaft seal: HQQE                                     | Insulation class: F              |
| NPSH required: ft       | Product number: 96080900                             | Motor protection: NONE           |
| Viscosity: _____        |  | Motor type: 71BB                 |
| Specific Gravity: 1.000 |  | Motor_efficiency: 80.0 %         |

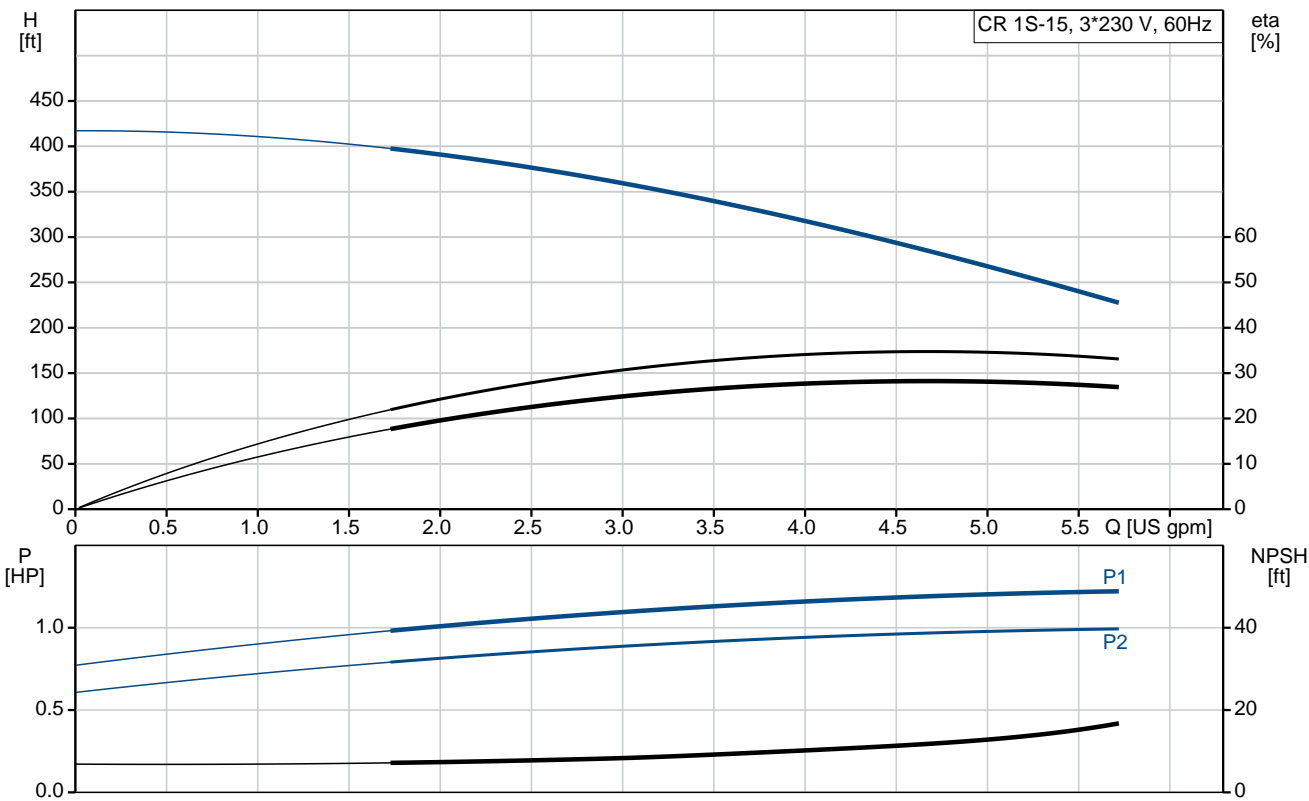

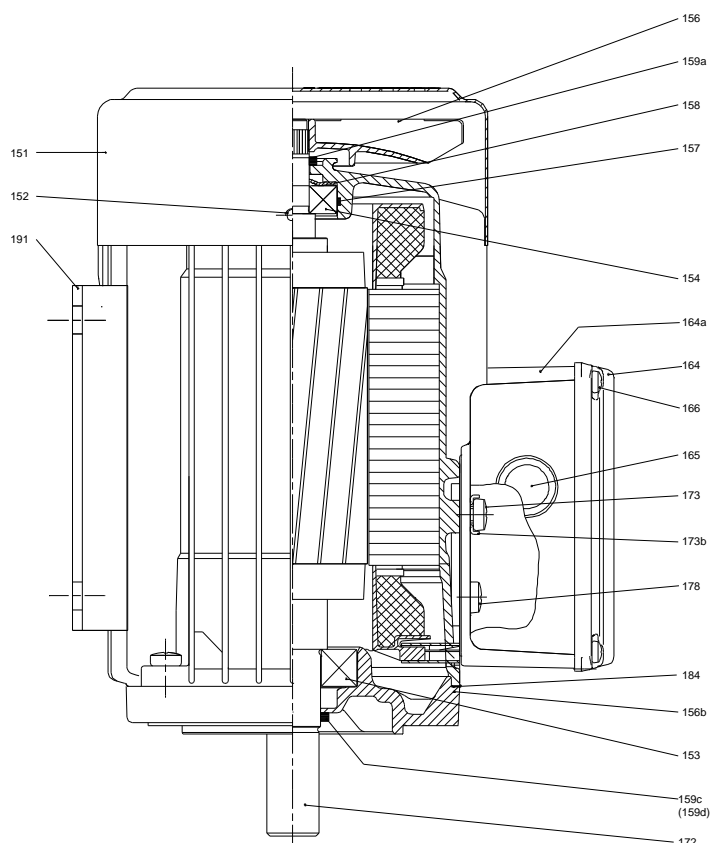
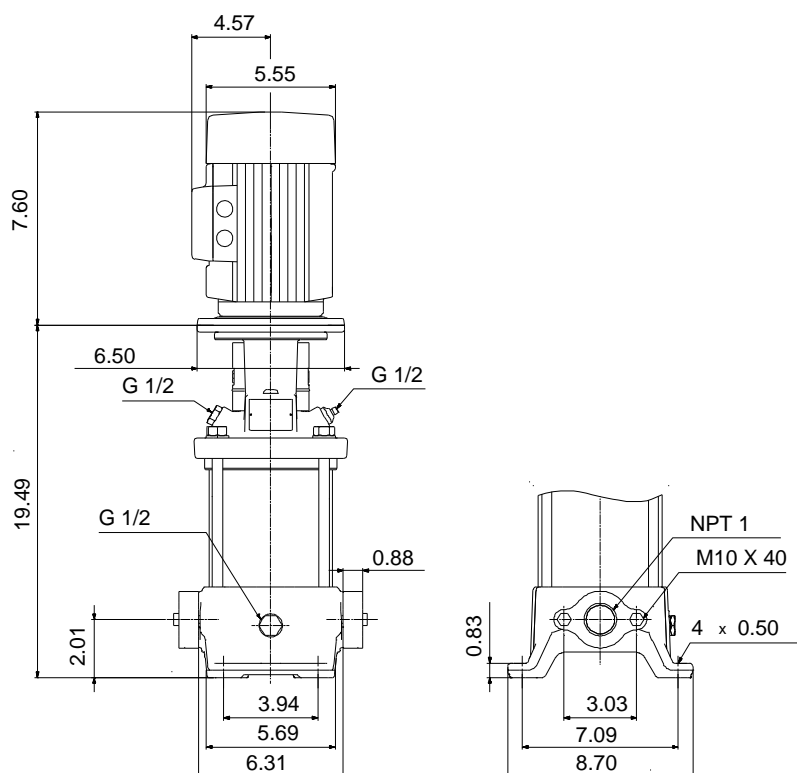

**Materials:**

Base:

Cast iron  
EN 1561 EN-GJL-200  
ASTM A48-25B

Impeller:

Stainless steel  
AISI 304  
EN 1.4301

Material code:

A

Code for rubber:

E

| Count | Description  |
|-------|--|
| 1     | <p><b>CR 1S-15 A-B-A-E-HQQE</b></p>  <p>Product No.: <a href="#">96080900</a><br/>           Vertical, non-self-priming, multistage, in-line, centrifugal pump for installation in pipe systems and mounting on a foundation.</p> <p>The pump has the following characteristics:</p> <ul style="list-style-type: none"> <li>- Impellers and intermediate chambers are made of</li> <li>- The shaft seal has assembly length according to EN 12756.</li> <li>- Power transmission is via cast iron split coupling.</li> </ul> <p>The motor is a 3-phase AC motor.</p> <p>Controls:<br/>           Frequency converter: NONE</p> <p><b>Liquid:</b><br/>           Pumped liquid: Water<br/>           Liquid temperature range: -4 .. 248 °F<br/>           Liquid temperature during operation: 68 °F<br/>           Density: 62.29 lb/ft³</p> <p><b>Technical:</b><br/>           Rated pump speed: 3484 rpm<br/>           Rated flow: 4.84 US gpm<br/>           Rated head: 279.9 ft<br/>           Pump orientation: Vertical<br/>           Shaft seal arrangement: Single<br/>           Code for shaft seal: HQQE<br/>           Approvals on nameplate: CURUS,NSF61<br/>           Curve tolerance: ISO9906:2012 3B</p> <p><b>Materials:</b><br/>           Base: Cast iron<br/>                     EN 1561 EN-GJL-200<br/>                     ASTM A48-25B<br/>           Impeller: Stainless steel<br/>                     EN 1.4301<br/>                     AISI 304<br/>           Bearing: SIC</p> <p><b>Installation:</b><br/>           Maximum ambient temperature: 140 °F<br/>           Maximum operating pressure: 232 psi<br/>           Max pressure at stated temperature: 232 psi / 250 °F<br/>             232 psi / -4 °F<br/>           Type of connection: Oval / NPT(F)</p> |



Company name:

Created by:

Phone:

Date:

12/28/2018

| Count | Description   |
|-------|---|
|       | Size of suction port: 1 inch<br>Size of outlet port: 1 inch<br>Pressure rating for pipe connection: PN 16<br>Flange size for motor: 56C<br><br><b>Electrical data:</b><br>Motor standard: NEMA<br>Motor type: 71BB<br>IE Efficiency class: NEMA Premium / IE3 60Hz<br>Rated power - P2: 1 HP<br>Power (P2) required by pump: 1 HP<br>Main frequency: 60 Hz<br>Rated voltage: 3 x 208-230YY/460Y V<br>Service factor: 1.25<br>Rated current: 3,25-3,35/1,68 A<br>Starting current: 590-650 %<br>Cos phi - power factor: 0.81-0.72<br>Rated speed: 3430-3460 rpm<br>IE efficiency: IE3 77,0%<br>Motor efficiency at full load: 80.0 %<br>Motor efficiency at 3/4 load: 79.5 %<br>Motor efficiency at 1/2 load: 75.0 %<br>Number of poles: 2<br>Enclosure class (IEC 34-5): 55 Dust/Jetting<br>Insulation class (IEC 85): F<br><br><b>Others:</b><br>Net weight: 57.2 lb<br>Gross weight: 68.2 lb<br>Shipping volume: 6.11 ft <sup>3</sup><br>Country of origin: US<br>Custom tariff no.: 8413.70.2040 |

## 96080900 CR 1S-15 A-B-A-E-HQQE 60 Hz

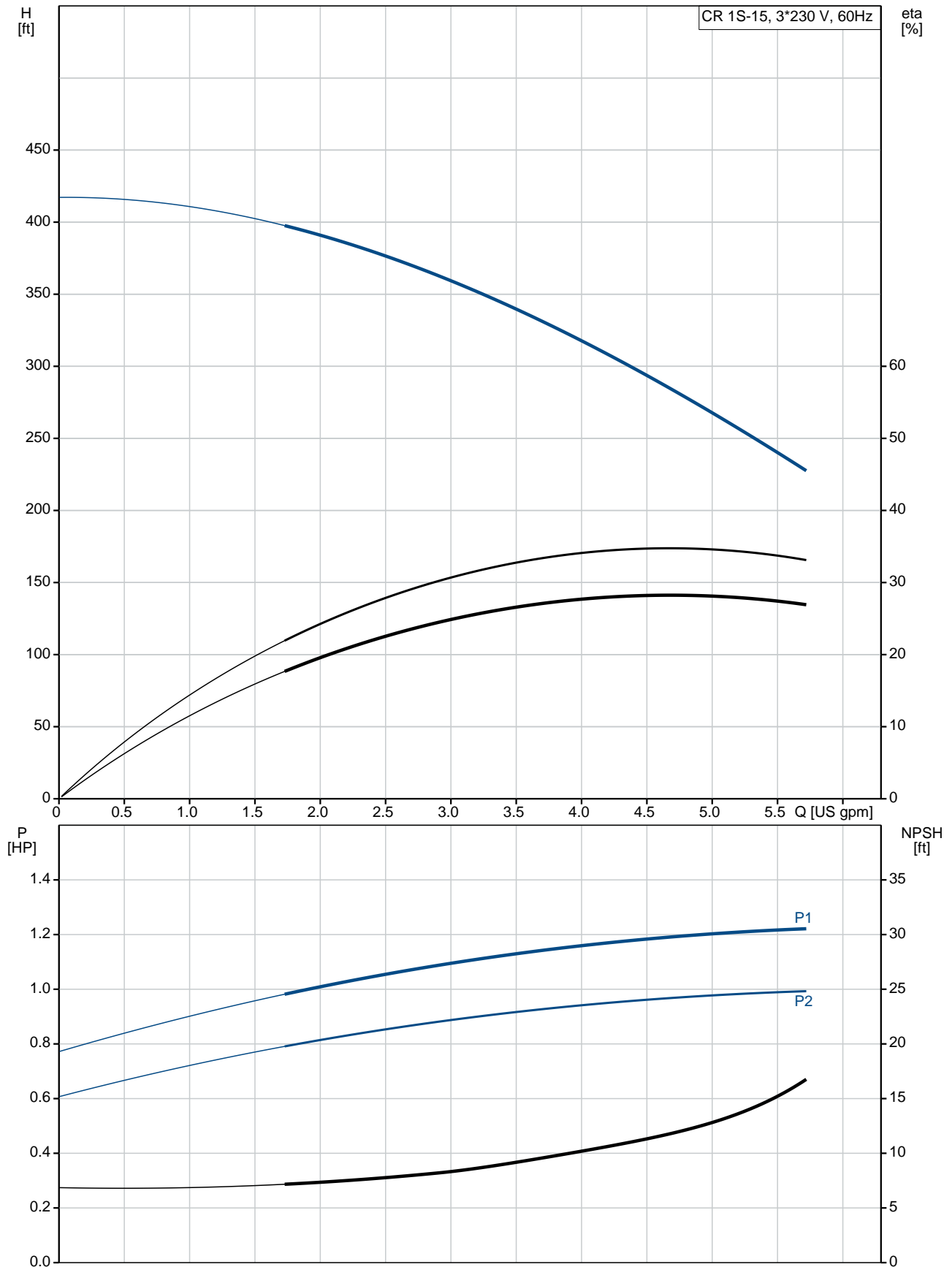

| Description                           | Value                   |
|---------------------------------------|-------------------------|
| <b>General information:</b>           |                         |
| Product name:                         | CR 1S-15 A-B-A-E-HQQE   |
| Product No.:                          | 96080900                |
| EAN:                                  | 5700395153583           |
| <b>Technical:</b>                     |                         |
| Rated pump speed:                     | 3484 rpm                |
| Rated flow:                           | 4.84 US gpm             |
| Rated head:                           | 279.9 ft                |
| Head max:                             | 419.6 ft                |
| Stages:                               | 15                      |
| Impellers:                            | 15                      |
| Number of reduced-diameter impellers: | 0                       |
| Low NPSH:                             | No                      |
| Pump orientation:                     | Vertical                |
| Shaft seal arrangement:               | Single                  |
| Code for shaft seal:                  | HQQE                    |
| Approvals on nameplate:               | CURUS, NSF61            |
| Curve tolerance:                      | ISO9906:2012 3B         |
| Pump version:                         | A                       |
| Model:                                | A                       |
| Cooling:                              | TEFC                    |
| <b>Materials:</b>                     |                         |
| Base:                                 | Cast iron               |
|                                       | EN 1561 EN-GJL-200      |
|                                       | ASTM A48-25B            |
| Impeller:                             | Stainless steel         |
|                                       | EN 1.4301               |
|                                       | AISI 304                |
| Material code:                        | A                       |
| Code for rubber:                      | E                       |
| Bearing:                              | SIC                     |
| <b>Installation:</b>                  |                         |
| Maximum ambient temperature:          | 140 °F                  |
| Maximum operating pressure:           | 232 psi                 |
| Max pressure at stated temperature:   | 232 psi / 250 °F        |
|                                       | 232 psi / -4 °F         |
| Type of connection:                   | Oval / NPT(F)           |
| Size of suction port:                 | 1 inch                  |
| Size of outlet port:                  | 1 inch                  |
| Pressure rating for pipe connection:  | PN 16                   |
| Flange size for motor:                | 56C                     |
| Connect code:                         | B                       |
| <b>Liquid:</b>                        |                         |
| Pumped liquid:                        | Water                   |
| Liquid temperature range:             | -4 .. 248 °F            |
| Liquid temperature during operation:  | 68 °F                   |
| Density:                              | 62.29 lb/ft³            |
| <b>Electrical data:</b>               |                         |
| Motor standard:                       | NEMA                    |
| Motor type:                           | 71BB                    |
| IE Efficiency class:                  | NEMA Premium / IE3 60Hz |
| Rated power - P2:                     | 1 HP                    |
| Power (P2) required by pump:          | 1 HP                    |
| Main frequency:                       | 60 Hz                   |
| Rated voltage:                        | 3 x 208-230YY/460Y V    |
| Service factor:                       | 1.25                    |
| Rated current:                        | 3,25-3,35/1,68 A        |

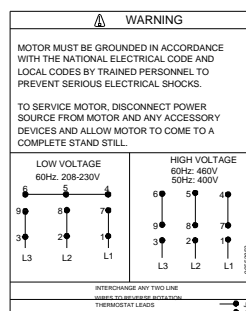
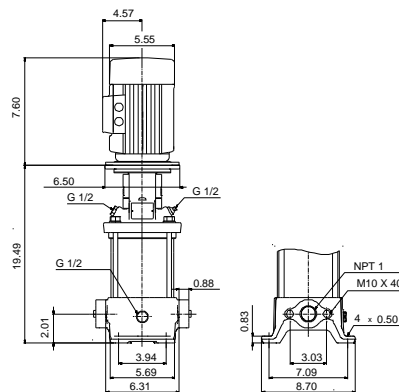
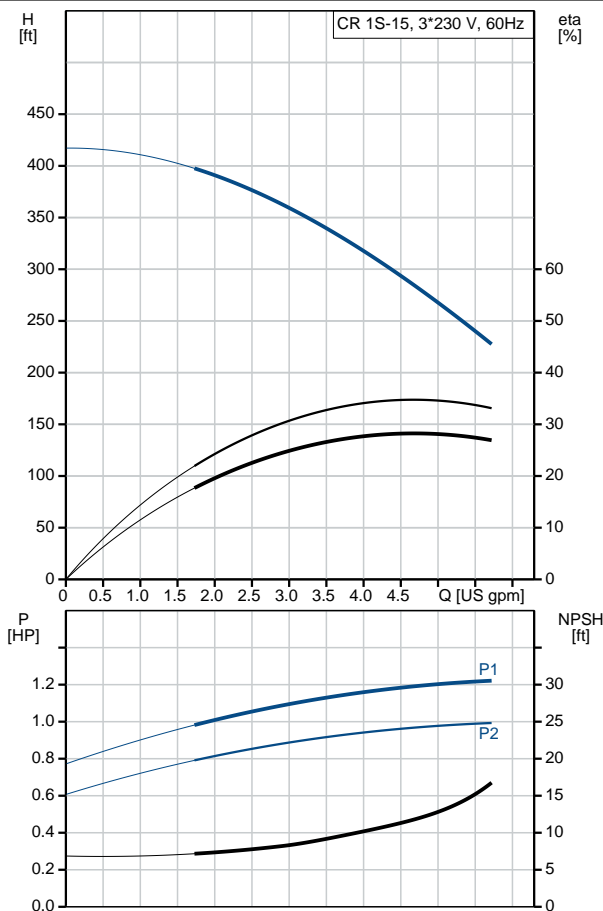



Company name:

Created by:

Phone:

Date:

12/28/2018

| Description                    | Value                |
|--------------------------------|----------------------|
| Starting current:              | 590-650 %            |
| Load current:                  | 4,0-3,9/1,95 A       |
| Cos phi - power factor:        | 0.81-0.72            |
| Rated speed:                   | 3430-3460 rpm        |
| IE efficiency:                 | IE3 77,0%            |
| Motor efficiency at full load: | 80.0 %               |
| Motor efficiency at 3/4 load:  | 79.5 %               |
| Motor efficiency at 1/2 load:  | 75.0 %               |
| Number of poles:               | 2                    |
| Enclosure class (IEC 34-5):    | 55 Dust/Jetting      |
| Insulation class (IEC 85):     | F                    |
| Motor protection:              | NONE                 |
| Motor Number:                  | 85900703             |
| <b>Controls:</b>               |                      |
| Frequency converter:           | NONE                 |
| <b>Others:</b>                 |                      |
| Net weight:                    | 57.2 lb              |
| Gross weight:                  | 68.2 lb              |
| Shipping volume:               | 6.11 ft <sup>3</sup> |
| Country of origin:             | US                   |
| Custom tariff no.:             | 8413.70.2040         |

## 96080900 CR 1S-15 A-B-A-E-HQQE 60 Hz

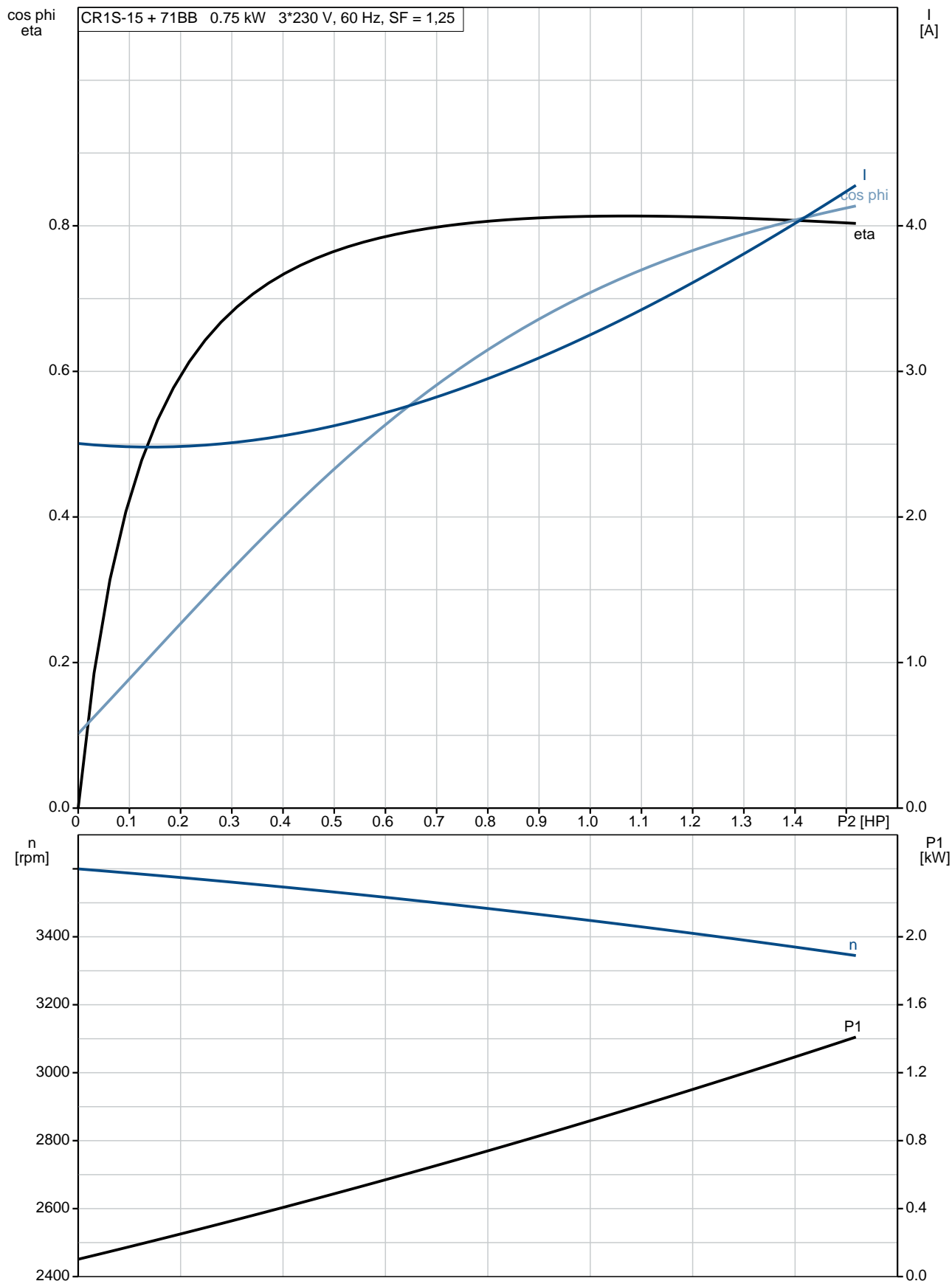



## 96080900 CR 1S-15 A-B-A-E-HQQE 60 Hz

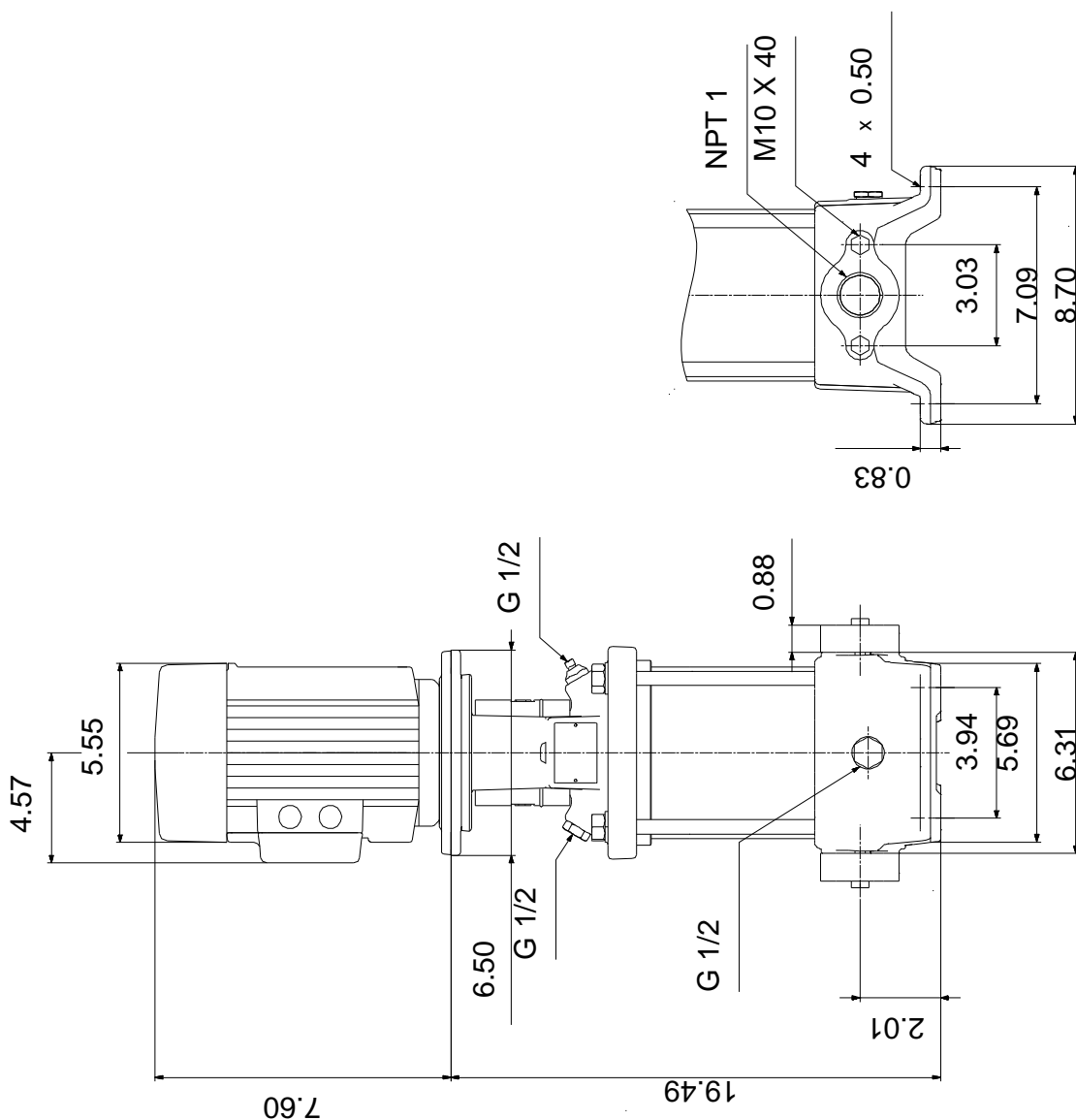

Note! All units are in [mm] unless otherwise stated.  
Disclaimer: This simplified dimensional drawing does not show all details.

## 96080900 CR 1S-15 A-B-A-E-HQQE 60 Hz



### WARNING

MOTOR MUST BE GROUNDED IN ACCORDANCE WITH THE NATIONAL ELECTRICAL CODE AND LOCAL CODES BY TRAINED PERSONNEL TO PREVENT SERIOUS ELECTRICAL SHOCKS.

TO SERVICE MOTOR, DISCONNECT POWER SOURCE FROM MOTOR AND ANY ACCESSORY DEVICES AND ALLOW MOTOR TO COME TO A COMPLETE STAND STILL.

#### LOW VOLTAGE 60Hz. 208-230V



#### HIGH VOLTAGE 60Hz: 460V 50Hz: 400V



INTERCHANGE ANY TWO LINE  
WIRES TO REVERSE ROTATION

THERMOSTAT LEADS  
(WHEN PROVIDED)

