

| Count | Description   |
|-------|---|
| 1     | <p><b>CRN 1S-8 A-P-A-V-HQQV</b></p>  <p>Product No.: <a href="#">96081697</a></p> <p>Vertical, non-self-priming, multistage, in-line, centrifugal pump for installation in pipe systems and mounting on a foundation.</p> <p>The pump has the following characteristics:</p> <ul style="list-style-type: none"> <li>- Impellers, intermediate chambers and outer sleeve are made of</li> <li>- Pump head cover and base are made of</li> <li>- The shaft seal has assembly length according to EN 12756.</li> <li>- Power transmission is via cast iron split coupling.</li> </ul> <p>flanges/couplings.</p> <p>The motor is a 1-phase AC motor.</p> <p><b>Controls:</b></p> <p>Frequency converter: NONE</p> <p><b>Liquid:</b></p> <p>Pumped liquid: Water</p> <p>Liquid temperature range: -4 .. 194 °F</p> <p>Selected liquid temperature: 68 °F</p> <p>Density: 62.29 lb/ft³</p> <p><b>Technical:</b></p> <p>Rated pump speed: 3443 rpm</p> <p>Rated flow: 4.84 US gpm</p> <p>Rated head: 147.3 ft</p> <p>Pump orientation: Vertical</p> <p>Shaft seal arrangement: Single</p> <p>Code for shaft seal: HQQV</p> <p>Approvals on nameplate: CURUS</p> <p>Curve tolerance: ISO9906:2012 3B</p> <p><b>Materials:</b></p> <p>Base: Stainless steel<br/>EN 1.4408<br/>AISI 316</p> <p>Impeller: Stainless steel<br/>EN 1.4401<br/>AISI 316</p> <p>Bearing: SIC</p> <p><b>Installation:</b></p> <p>Maximum ambient temperature: 104 °F</p> <p>Maximum operating pressure: 362.59 psi</p> |



Company name:

Created by:

Phone:

Date:

7/23/2019

| Count | Description  |
|-------|--|
|       | <p>Max pressure at stated temperature: 363 psi / 194 °F<br/>363 psi / -4 °F</p> <p>Type of connection: PJE<br/>Size of inlet connection: DN 32<br/>Size of suction port: 1 1/4 inch<br/>Size of outlet connection: DN 32<br/>Size of outlet port: 1 1/4 inch<br/>Pressure rating for pipe connection: PN 50<br/>Flange size for motor: 56C</p> <p><b>Electrical data:</b></p> <p>Motor standard: NEMA<br/>Motor type: Baldor<br/>Rated power - P2: 0.5 HP<br/>Power (P2) required by pump: 0.5 HP<br/>Main frequency: 60 Hz<br/>Rated voltage: 1 x 115/230 V<br/>Service factor: 1.60<br/>Rated current: 7.4/3.7 A<br/>Rated speed: 3450 rpm<br/>Number of poles: 2<br/>Enclosure class (IEC 34-5): 54 Dust/Splashing<br/>Insulation class (IEC 85): B<br/>Motor Number: 85700002</p> <p><b>Others:</b></p> <p>Net weight: 52.4 lb<br/>Gross weight: 63.4 lb<br/>Shipping volume: 4.94 ft³<br/>Country of origin: US<br/>Custom tariff no.: 8413.70.2040</p> |

## 96081697 CRN 1S-8 A-P-A-V-HQQV 60 Hz

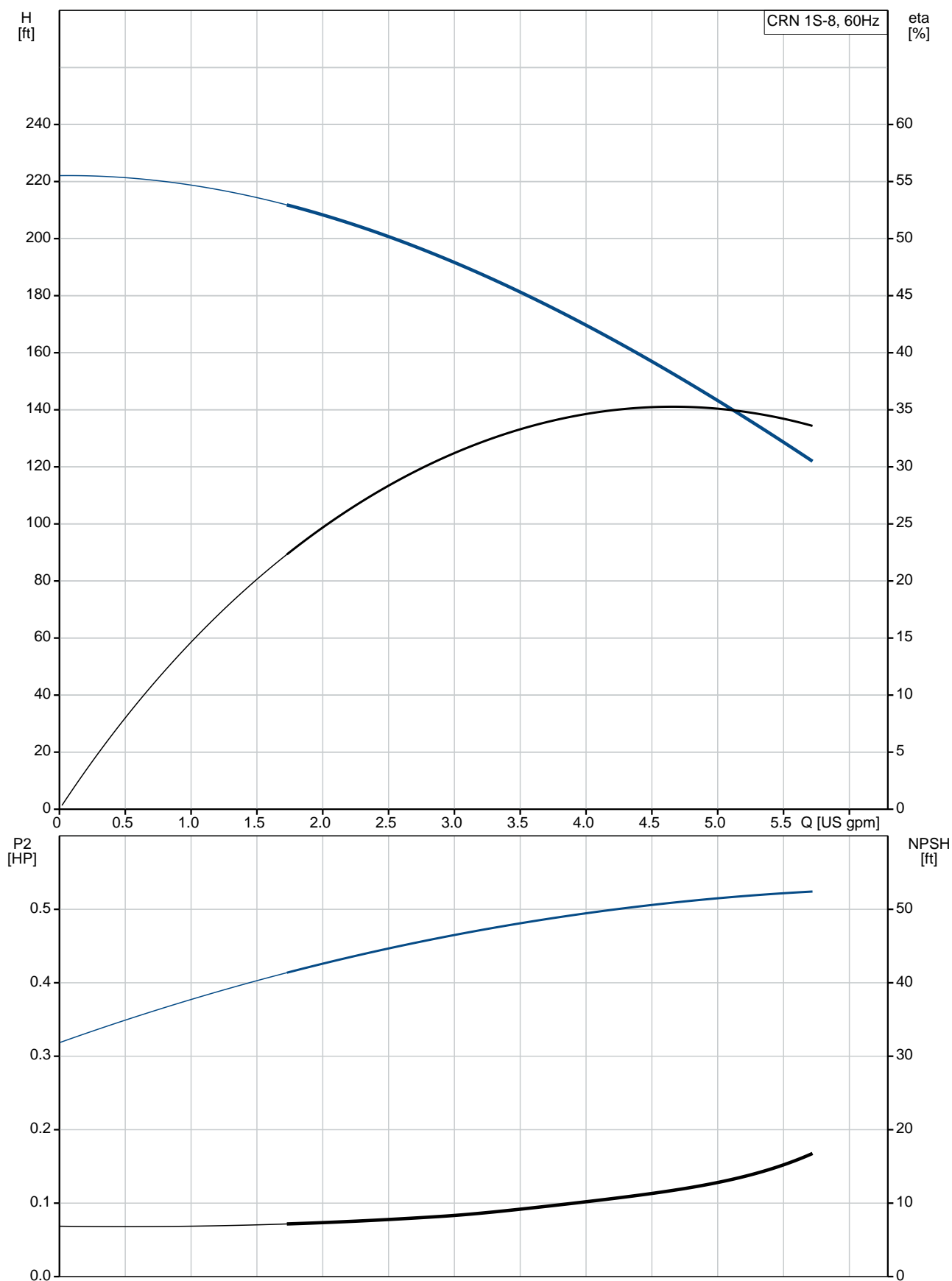

| Description                           | Value                 |
|---------------------------------------|-----------------------|
| <b>General information:</b>           |                       |
| Product name:                         | CRN 1S-8 A-P-A-V-HQQV |
| Product No.:                          | 96081697              |
| EAN:                                  | 5700395161410         |
| <b>Technical:</b>                     |                       |
| Rated pump speed:                     | 3443 rpm              |
| Rated flow:                           | 4.84 US gpm           |
| Rated head:                           | 147.3 ft              |
| Head max:                             | 220.5 ft              |
| Stages:                               | 8                     |
| Impellers:                            | 8                     |
| Number of reduced-diameter impellers: | 0                     |
| Low NPSH:                             | N                     |
| Pump orientation:                     | Vertical              |
| Shaft seal arrangement:               | Single                |
| Code for shaft seal:                  | HQQV                  |
| Approvals on nameplate:               | CURUS                 |
| Curve tolerance:                      | ISO9906:2012 3B       |
| Pump version:                         | A                     |
| Model:                                | A                     |
| Cooling:                              | TEFC                  |
| <b>Materials:</b>                     |                       |
| Base:                                 | Stainless steel       |
|                                       | EN 1.4408             |
|                                       | AISI 316              |
| Impeller:                             | Stainless steel       |
|                                       | EN 1.4401             |
|                                       | AISI 316              |
| Material code:                        | A                     |
| Code for rubber:                      | V                     |
| Bearing:                              | SIC                   |
| <b>Installation:</b>                  |                       |
| Maximum ambient temperature:          | 104 °F                |
| Maximum operating pressure:           | 362.59 psi            |
| Max pressure at stated temperature:   | 363 psi / -4 °F       |
|                                       | 363 psi / -4 °F       |
| Type of connection:                   | PJE                   |
| Size of inlet connection:             | DN 32                 |
| Size of suction port:                 | 1 1/4 inch            |
| Size of outlet connection:            | DN 32                 |
| Size of outlet port:                  | 1 1/4 inch            |
| Pressure rating for pipe connection:  | PN 50                 |
| Flange size for motor:                | 56C                   |
| Connect code:                         | P                     |
| <b>Liquid:</b>                        |                       |
| Pumped liquid:                        | Water                 |
| Liquid temperature range:             | -4 .. 194 °F          |
| Selected liquid temperature:          | 68 °F                 |
| Density:                              | 62.29 lb/ft³          |
| <b>Electrical data:</b>               |                       |
| Motor standard:                       | NEMA                  |
| Motor type:                           | Baldor                |
| Rated power - P2:                     | 0.5 HP                |
| Power (P2) required by pump:          | 0.5 HP                |
| Main frequency:                       | 60 Hz                 |
| Rated voltage:                        | 1 x 115/230 V         |
| Service factor:                       | 1.60                  |

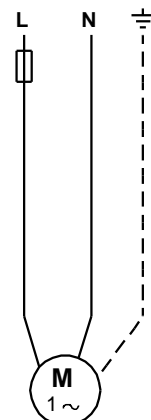
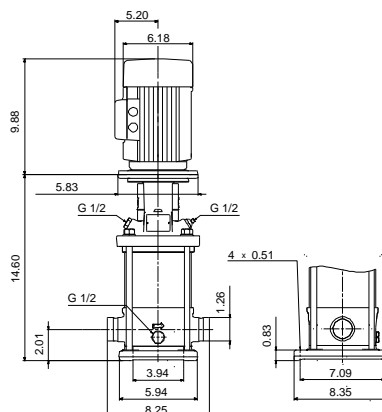
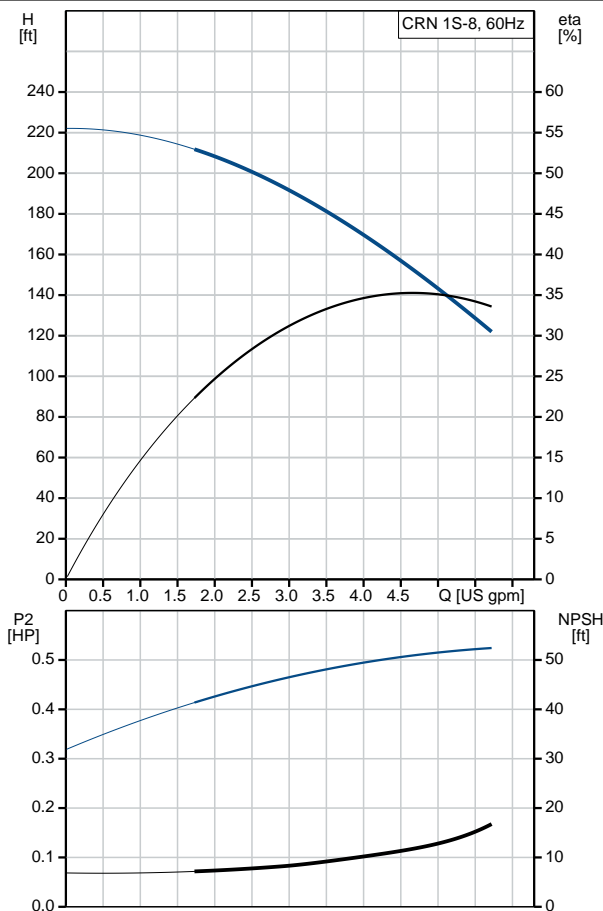



Company name:

Created by:

Phone:

Date:

7/23/2019

| Description                 | Value                |
|-----------------------------|----------------------|
| Rated current:              | 7.4/3.7 A            |
| Load current:               | 9.8/4.9 A            |
| Rated speed:                | 3450 rpm             |
| Number of poles:            | 2                    |
| Enclosure class (IEC 34-5): | 54 Dust/Splashing    |
| Insulation class (IEC 85):  | B                    |
| Motor Number:               | 85700002             |
| <b>Controls:</b>            |                      |
| Frequency converter:        | NONE                 |
| <b>Others:</b>              |                      |
| Net weight:                 | 52.4 lb              |
| Gross weight:               | 63.4 lb              |
| Shipping volume:            | 4.94 ft <sup>3</sup> |
| Country of origin:          | US                   |
| Custom tariff no.:          | 8413.70.2040         |

## 96081697 CRN 1S-8 A-P-A-V-HQQV 60 Hz

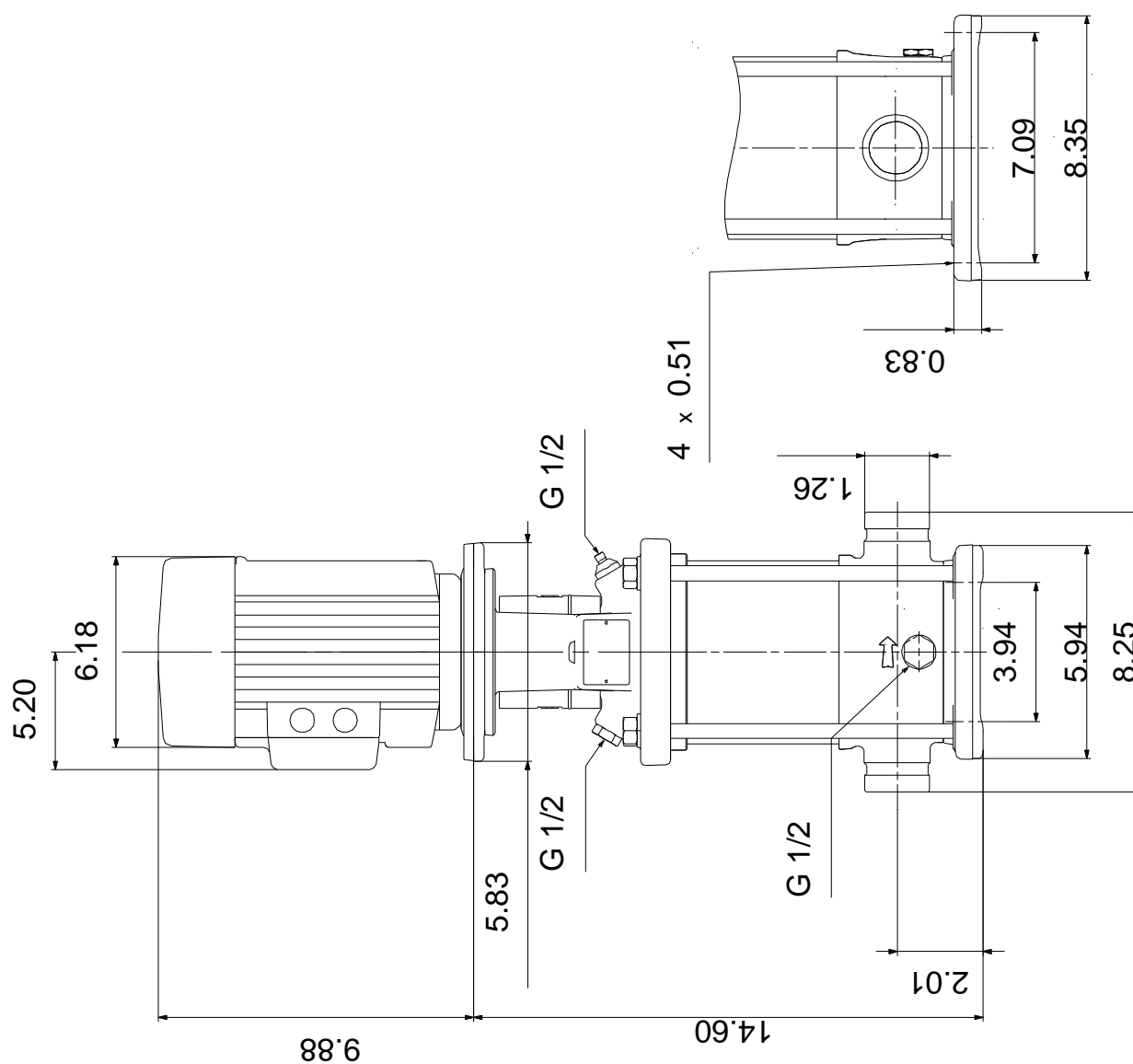

Note! All units are in [in] unless otherwise stated.

Disclaimer: This simplified dimensional drawing does not show all details.

**96081697 CRN 1S-8 A-P-A-V-HQQV 60 Hz**



All units are [in] unless otherwise presented.