

| Count | Description |
|-------|---|
| 1 | <p>CRN 1S-8 A-P-A-V-HQQV</p>  <p>Product No.: 96081698 Vertical, non-self-priming, multistage, in-line, centrifugal pump for installation in pipe systems and mounting on a foundation.</p> <p>The pump has the following characteristics:</p> <ul style="list-style-type: none"> - Impellers, intermediate chambers and outer sleeve are made of - Pump head cover and base are made of - The shaft seal has assembly length according to EN 12756. - Power transmission is via cast iron split coupling. <p>flanges/couplings.</p> <p>The motor is a 3-phase AC motor.</p> <p>Controls: Frequency converter: NONE</p> <p>Liquid: Pumped liquid: Water Liquid temperature range: -4 .. 194 °F Selected liquid temperature: 68 °F Density: 62.29 lb/ft³</p> <p>Technical: Rated pump speed: 3485 rpm Rated flow: 4.84 US gpm Rated head: 149.3 ft Pump orientation: Vertical Shaft seal arrangement: Single Code for shaft seal: HQQV Approvals on nameplate: CURUS Curve tolerance: ISO9906:2012 3B</p> <p>Materials: Base: Stainless steel EN 1.4408 AISI 316 Impeller: Stainless steel EN 1.4401 AISI 316 Bearing: SIC</p> <p>Installation: Maximum ambient temperature: 104 °F Maximum operating pressure: 362.59 psi</p> |

| Count | Description |
|-------|---|
| | <p>Max pressure at stated temperature: 363 psi / 194 °F 363 psi / -4 °F</p> <p>Type of connection: PJE Size of inlet connection: DN 32 Size of suction port: 1 1/4 inch Size of outlet connection: DN 32 Size of outlet port: 1 1/4 inch Pressure rating for pipe connection: PN 50 Flange size for motor: 56C</p> <p>Electrical data:</p> <p>Motor standard: NEMA Motor type: 71AB Rated power - P2: 0.5 HP Power (P2) required by pump: 0.5 HP Main frequency: 60 Hz Rated voltage: 3 x 208-230YY/460Y V Service factor: 1.25 Rated current: 1,64-1,55/0,78 A Starting current: 590-650 % Cos phi - power factor: 0.84-0.78 Rated speed: 3430-3460 rpm Motor efficiency at full load: 78.5 % Number of poles: 2 Enclosure class (IEC 34-5): 55 Dust/Jetting Insulation class (IEC 85): F Motor Number: 85900701</p> <p>Others:</p> <p>Net weight: 46.1 lb Gross weight: 57.1 lb Shipping volume: 4.94 ft³ Country of origin: US Custom tariff no.: 8413.70.2040</p> |

96081698 CRN 1S-8 A-P-A-V-HQQV 60 Hz

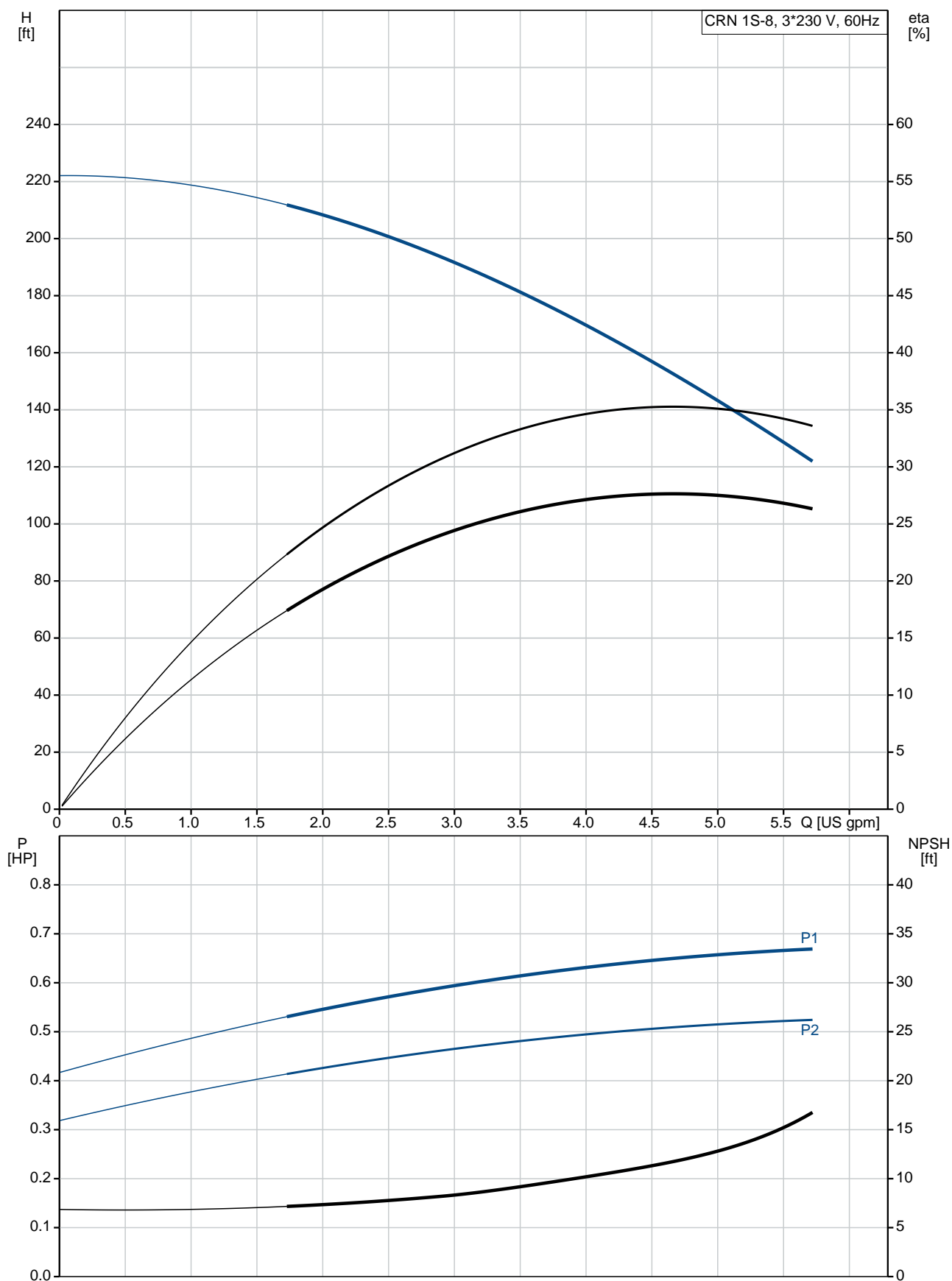

| Description | Value |
|---------------------------------------|-----------------------|
| General information: | |
| Product name: | CRN 1S-8 A-P-A-V-HQQV |
| Product No.: | 96081698 |
| EAN: | 5700395161427 |
| Technical: | |
| Rated pump speed: | 3485 rpm |
| Rated flow: | 4.84 US gpm |
| Rated head: | 149.3 ft |
| Head max: | 222.5 ft |
| Stages: | 8 |
| Impellers: | 8 |
| Number of reduced-diameter impellers: | 0 |
| Low NPSH: | N |
| Pump orientation: | Vertical |
| Shaft seal arrangement: | Single |
| Code for shaft seal: | HQQV |
| Approvals on nameplate: | CURUS |
| Curve tolerance: | ISO9906:2012 3B |
| Pump version: | A |
| Model: | A |
| Cooling: | TEFC |
| Materials: | |
| Base: | Stainless steel |
| | EN 1.4408 |
| | AISI 316 |
| Impeller: | Stainless steel |
| | EN 1.4401 |
| | AISI 316 |
| Material code: | A |
| Code for rubber: | V |
| Bearing: | SIC |
| Installation: | |
| Maximum ambient temperature: | 104 °F |
| Maximum operating pressure: | 362.59 psi |
| Max pressure at stated temperature: | 363 psi / 194 °F |
| | 363 psi / -4 °F |
| Type of connection: | PJE |
| Size of inlet connection: | DN 32 |
| Size of suction port: | 1 1/4 inch |
| Size of outlet connection: | DN 32 |
| Size of outlet port: | 1 1/4 inch |
| Pressure rating for pipe connection: | PN 50 |
| Flange size for motor: | 56C |
| Connect code: | P |
| Liquid: | |
| Pumped liquid: | Water |
| Liquid temperature range: | -4 .. 194 °F |
| Selected liquid temperature: | 68 °F |
| Density: | 62.29 lb/ft³ |
| Electrical data: | |
| Motor standard: | NEMA |
| Motor type: | 71AB |
| Rated power - P2: | 0.5 HP |
| Power (P2) required by pump: | 0.5 HP |
| Main frequency: | 60 Hz |
| Rated voltage: | 3 x 208-230YY/460Y V |
| Service factor: | 1.25 |

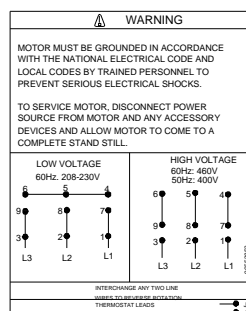
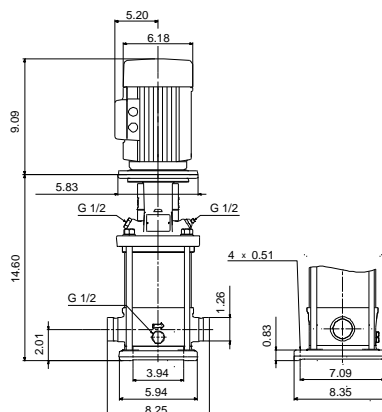
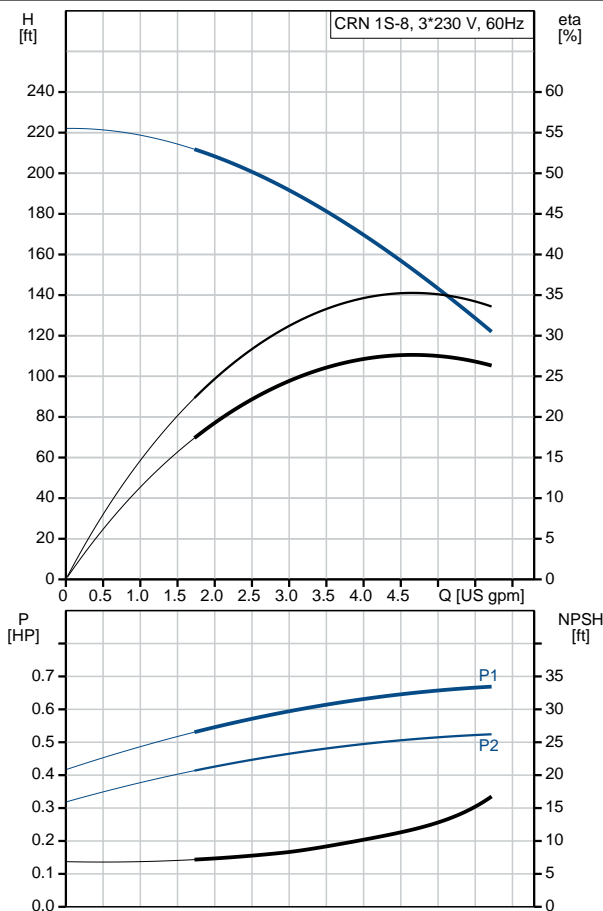



Company name:

Created by:

Phone:

Date:

7/23/2019

| Description | Value |
|--------------------------------|----------------------|
| Rated current: | 1,64-1,55/0,78 A |
| Starting current: | 590-650 % |
| Load current: | 2,0-1,9/0,95 A |
| Cos phi - power factor: | 0.84-0.78 |
| Rated speed: | 3430-3460 rpm |
| Motor efficiency at full load: | 78.5 % |
| Number of poles: | 2 |
| Enclosure class (IEC 34-5): | 55 Dust/Jetting |
| Insulation class (IEC 85): | F |
| Motor protection: | NONE |
| Motor Number: | 85900701 |
| Controls: | |
| Frequency converter: | NONE |
| Others: | |
| Net weight: | 46.1 lb |
| Gross weight: | 57.1 lb |
| Shipping volume: | 4.94 ft ³ |
| Country of origin: | US |
| Custom tariff no.: | 8413.70.2040 |

96081698 CRN 1S-8 A-P-A-V-HQQV 60 Hz

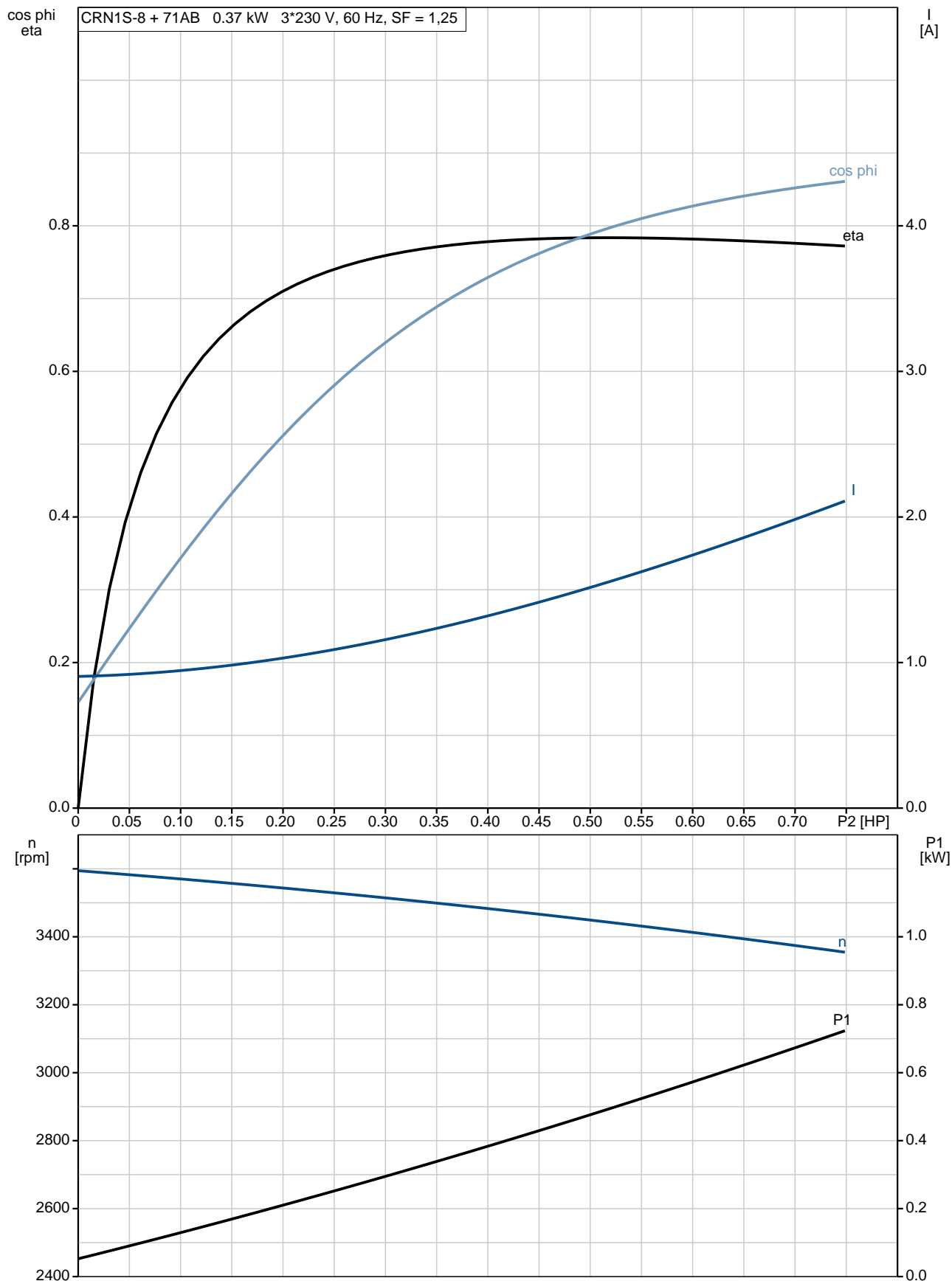

96081698 CRN 1S-8 A-P-A-V-HQQV 60 Hz

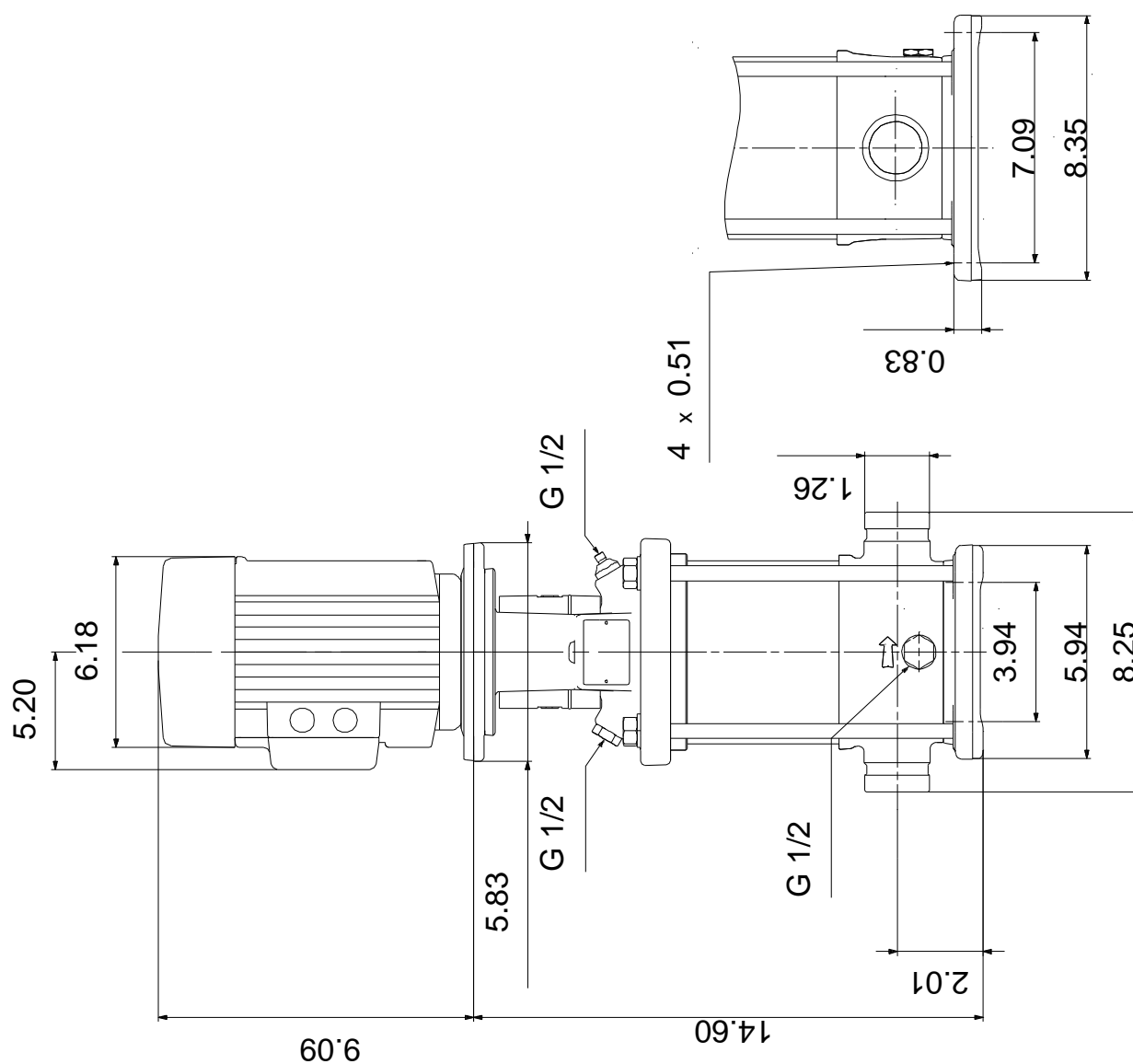

Note! All units are in [in] unless otherwise stated.

Disclaimer: This simplified dimensional drawing does not show all details.

96081698 CRN 1S-8 A-P-A-V-HQQV 60 Hz



WARNING

MOTOR MUST BE GROUNDED IN ACCORDANCE WITH THE NATIONAL ELECTRICAL CODE AND LOCAL CODES BY TRAINED PERSONNEL TO PREVENT SERIOUS ELECTRICAL SHOCKS.

TO SERVICE MOTOR, DISCONNECT POWER SOURCE FROM MOTOR AND ANY ACCESSORY DEVICES AND ALLOW MOTOR TO COME TO A COMPLETE STAND STILL.

LOW VOLTAGE 60Hz. 208-230V

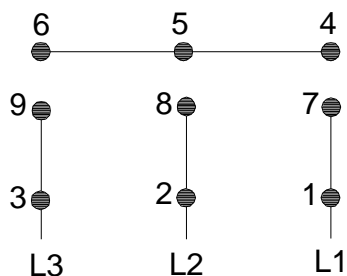

HIGH VOLTAGE 60Hz: 460V 50Hz: 400V

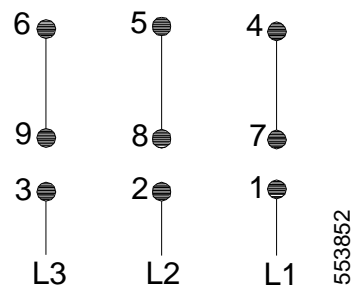

INTERCHANGE ANY TWO LINE
WIRES TO REVERSE ROTATION

THERMOSTAT LEADS
(WHEN PROVIDED)

