

| | | |
|-----------------------|------------------------|-----------------|
| PROJECT: _____ | UNIT TAG: _____ | QUANTITY: _____ |
| REPRESENTATIVE: _____ | TYPE OF SERVICE: _____ | DATE: _____ |
| ENGINEER: _____ | SUBMITTED BY: _____ | DATE: _____ |
| CONTRACTOR: _____ | APPROVED BY: _____ | DATE: _____ |
| | ORDER NO.: _____ | DATE: _____ |

MTR 5-10/10 A-WB-A-HUUV

Coolant and condensate pumps



Product photo could vary from the actual product

| Conditions of Service | Pump Data | Motor Data |
|-------------------------|--|----------------------------------|
| Efficiency: _____ | Max pressure at stated temperature: 363 psi / 194 °F | Rated power - P2: 5 HP |
| Liquid: Water | Liquid temperature range: 14 .. 194 °F | Rated voltage: 208-230YY/460Y V |
| Temperature: 68 °F | Maximum ambient temperature: 140 °F | Main frequency: 60 Hz |
| NPSH required: ft | Shaft seal: HUUV | Enclosure class: 55 Dust/Jetting |
| Specific Gravity: 1.000 | Product number: 96515437 | Insulation class: F |
| | | Motor protection: PTC |
| | | Motor type: 112CA |
| | | Eff. 1/1: 88.5 % |

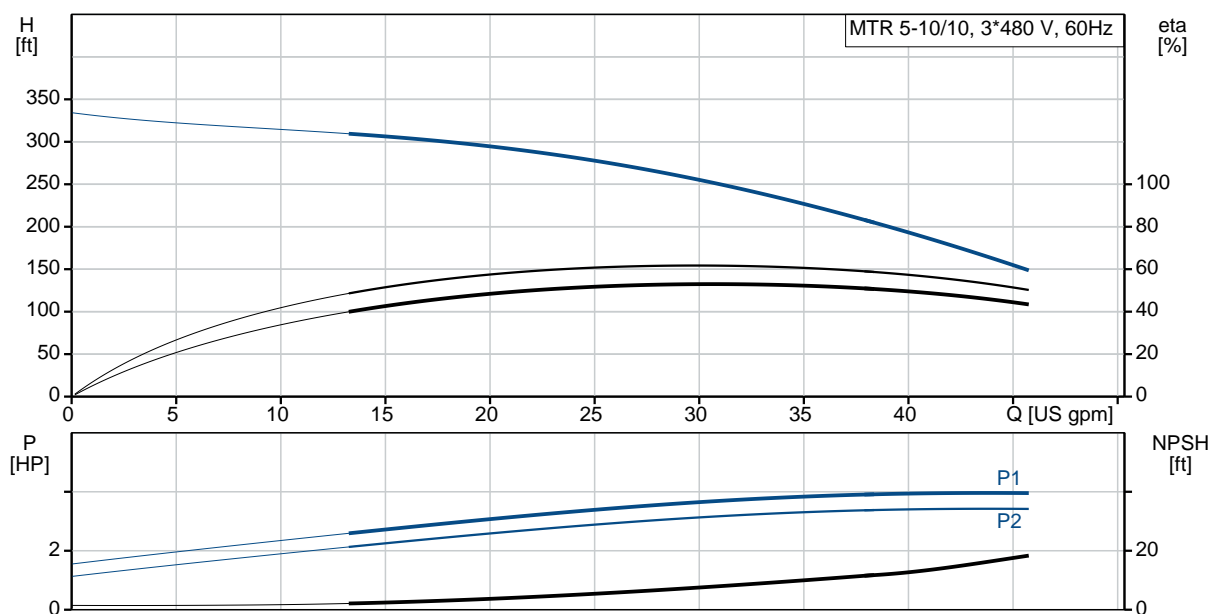

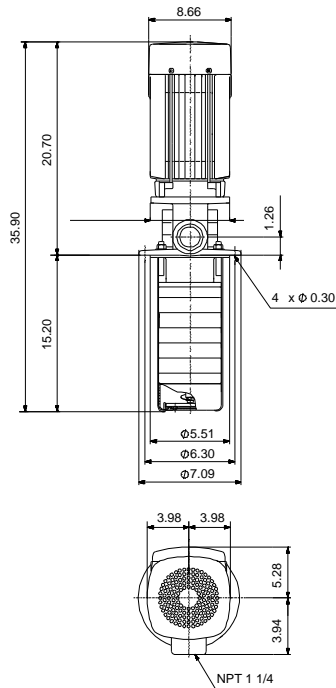

Materials:

Impeller: Stainless steel
 Impeller: AISI 304
 Impeller: EN 1.4301
 Material code: A

| Count | Description |
|-------|---|
| 1 | <p>MTR 5-10/10 A-WB-A-HUUV</p>  <p>Product No.: 96515437</p> <p>Multistage, immersible, self-priming, centrifugal pump for vertical installation in tanks etc. The pump head and base are in cast iron – all other wetted parts are in stainless steel. The pump has the following characteristics:</p> <ul style="list-style-type: none"> • Dimensions according to DIN 5440. • Impellers, intermediate chambers and spline shaft are made of {IMPELLER_MATR}. • Mechanical shaft seal according to EN 12756. • Power transmission via sintered metal split coupling. <p>A cartridge shaft seal ensures high reliability, safe handling, and easy access and service. The pump is fitted with a 3-phase, fan-cooled asynchronous motor.</p> <p>Immesion depth: 15.2 in</p> <p>Controls: Frequency converter: NONE</p> <p>Liquid: Pumped liquid: Water Liquid temperature range: 14 .. 194 °F Selected liquid temperature: 68 °F Density: 62.29 lb/ft³</p> <p>Technical: Rated pump speed: 3461 rpm Rated flow: 30.4 US gpm Rated head: 245.1 ft Chambers: 10 Drainage back to tank: N Pump orientation: Vertical Code for shaft seal: HUUV Curve tolerance: ISO9906:2012 3B</p> <p>Materials: Pump head: Cast iron EN 1561 EN-GJL-200 ASTM A48-25B</p> |



Company name:

Created by:

Phone:

Date:

9/28/2020

| Count | Description |
|-------|--|
| | Impeller: Stainless steel EN 1.4301 AISI 304 |
| | Installation: Maximum ambient temperature: 140 °F Maximum operating pressure: 362.59 psi Max pressure at stated temperature: 363 psi / 194 °F Type of connection: NPT(F) Size of outlet port: 1 1/4 inch Immersion depth: 15.2 in Flange size for motor: 182TC |
| | Electrical data: Motor standard: NEMA Motor type: 112CA IE Efficiency class: NEMA Premium / IE3 60Hz Rated power - P2: 5 HP Main frequency: 60 Hz Suitable for 50/60 Hz: N Rated voltage: 3 x 208-230YY/460Y V Service factor: 1.15 Rated current: 14,1-13,1/7,29 A Starting current: 1000-1470 % Cos phi - power factor: 0.89-0.86 Rated speed: 3525-3540 rpm IE efficiency: IE3 88,5% Motor efficiency at full load: 88.5 % Motor efficiency at 3/4 load: 88.6 % Motor efficiency at 1/2 load: 85.2 % Number of poles: 2 Enclosure class (IEC 34-5): 55 Dust/Jetting Insulation class (IEC 85): F Motor Number: 85904389 |
| | Others: Terminal box position: 6 Minimum efficiency index, MEI $\eta_{\%}$: 0.57 Net weight: 116 lb Gross weight: 123 lb Shipping volume: 4.94 ft ³ Country of origin: GB Custom tariff no.: 8413.70.2040 |



Company name:
Created by:
Phone:

Date: 9/28/2020

96515437 MTR 5-10/10 A-WB-A-HUUV 60 Hz

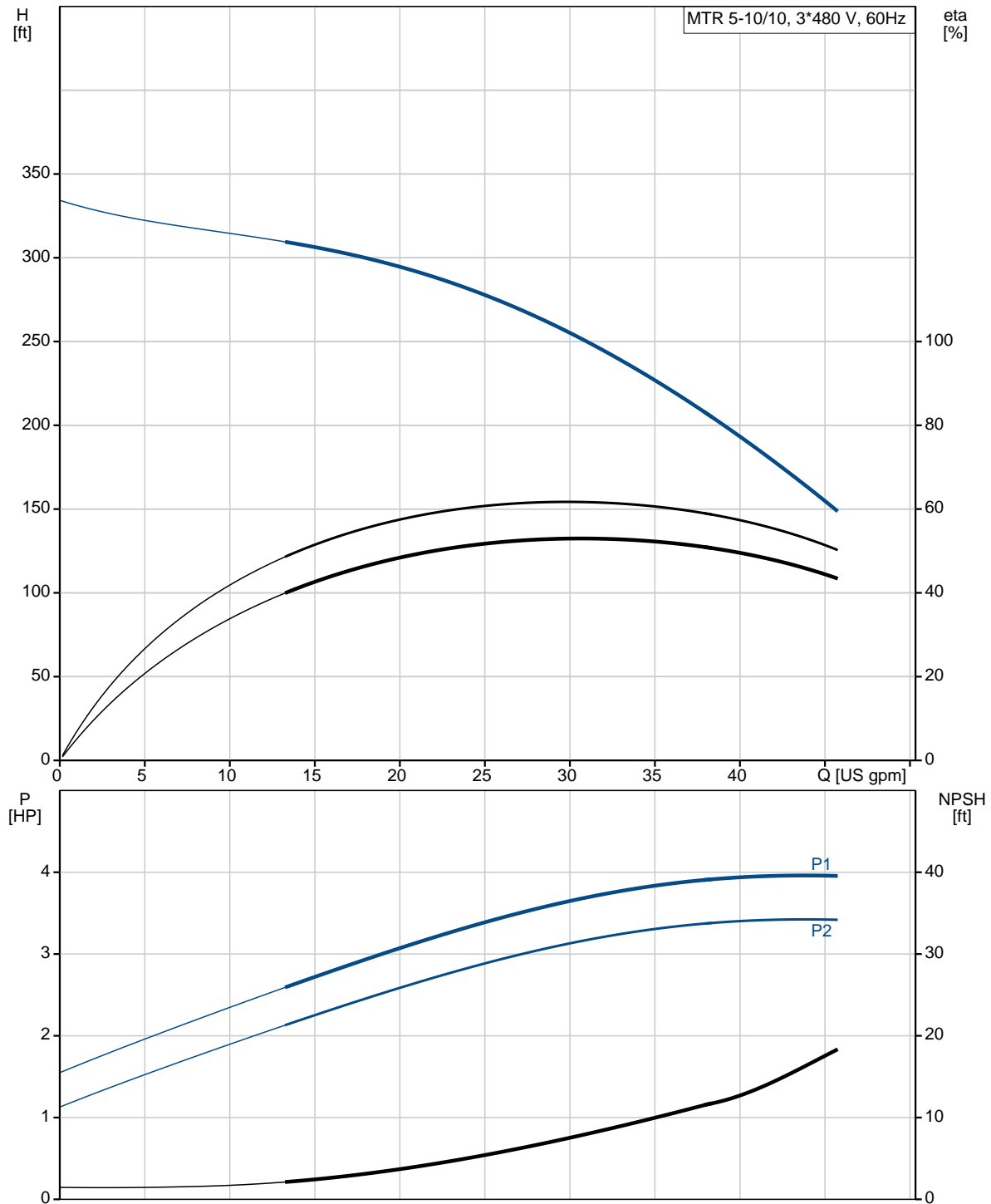

| Description | Value |
|---------------------------------------|----------------------------|
| General information: | |
| Product name: | MTR 5-10/10 A-WB-A-HUUV |
| Product No.: | 96515437 |
| EAN: | 5700396722801 |
| Price: | |
| Technical: | |
| Rated pump speed: | 3461 rpm |
| Rated flow: | 30.4 US gpm |
| Rated head: | 245.1 ft |
| Chambers: | 10 |
| Impellers: | 10 |
| Number of reduced-diameter impellers: | 0 |
| Drainage back to tank: | N |
| Pump orientation: | Vertical |
| Code for shaft seal: | HUUV |
| Curve tolerance: | ISO9906:2012 3B |
| Pump version: | A |
| Model: | A |
| Materials: | |
| Pump head: | Cast iron |
| Pump head: | EN 1561 EN-GJL-200 |
| Pump head: | ASTM A48-25B |
| Impeller: | Stainless steel |
| Impeller: | EN 1.4301 |
| Impeller: | AISI 304 |
| Material code: | A |
| Installation: | |
| Maximum ambient temperature: | 140 °F |
| Maximum operating pressure: | 362.59 psi |
| Max pressure at stated temperature: | 363 psi / 194 °F |
| Type of connection: | NPT(F) |
| Size of outlet port: | 1 1/4 inch |
| Immersion depth: | 15.2 in |
| Flange size for motor: | 182TC |
| Connect code: | WB |
| Liquid: | |
| Pumped liquid: | Water |
| Liquid temperature range: | 14 .. 194 °F |
| Selected liquid temperature: | 68 °F |
| Density: | 62.29 lb/ft³ |
| Electrical data: | |
| Motor standard: | NEMA |
| Motor type: | 112CA |
| IE Efficiency class: | NEMA Premium / IE3 60Hz |
| Rated power - P2: | 5 HP |

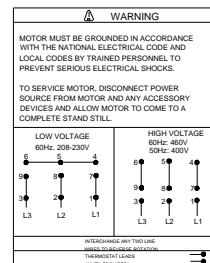
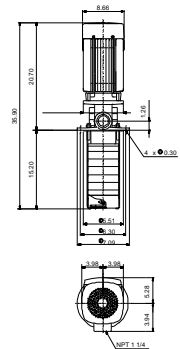
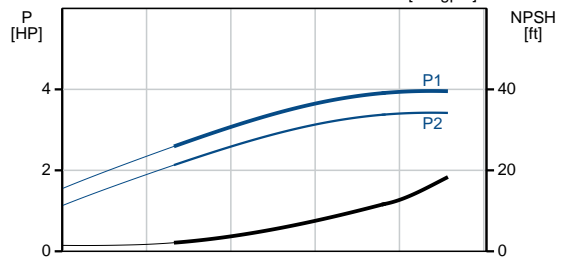
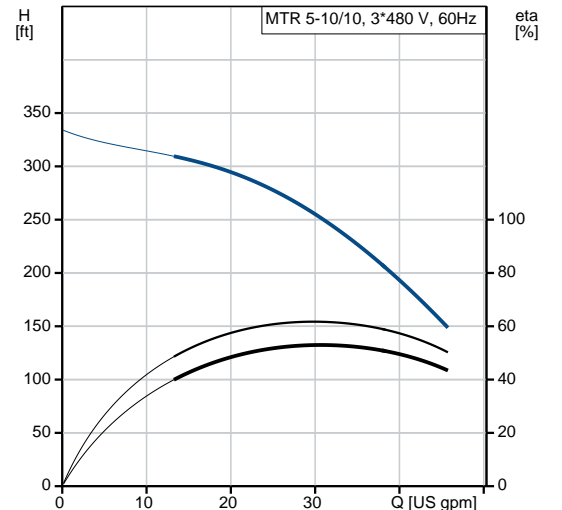



Company name:

Created by:

Phone:

Date:

9/28/2020

| Description | Value |
|--|----------------------|
| Main frequency: | 60 Hz |
| Suitable for 50/60 Hz: | N |
| Rated voltage: | 3 x 208-230YY/460Y V |
| Service factor: | 1.15 |
| Rated current: | 14,1-13,1/7,29 A |
| Starting current: | 1000-1470 % |
| Cos phi - power factor: | 0.89-0.86 |
| Rated speed: | 3525-3540 rpm |
| IE efficiency: | IE3 88,5% |
| Motor efficiency at full load: | 88.5 % |
| Motor efficiency at 3/4 load: | 88.6 % |
| Motor efficiency at 1/2 load: | 85.2 % |
| Number of poles: | 2 |
| Enclosure class (IEC 34-5): | 55 Dust/Jetting |
| Insulation class (IEC 85): | F |
| Motor protection: | PTC |
| Motor Number: | 85904389 |
| Controls: | |
| Frequency converter: | NONE |
| Others: | |
| Terminal box position: | 6 |
| Minimum efficiency index, MEI â‰¥%: | 0.57 |
| Net weight: | 116 lb |
| Gross weight: | 123 lb |
| Shipping volume: | 4.94 ft³ |
| Sales region: | Namreg |
| Country of origin: | GB |
| Custom tariff no.: | 8413.70.2040 |

96515437 MTR 5-10/10 A-WB-A-HUUV 60 Hz

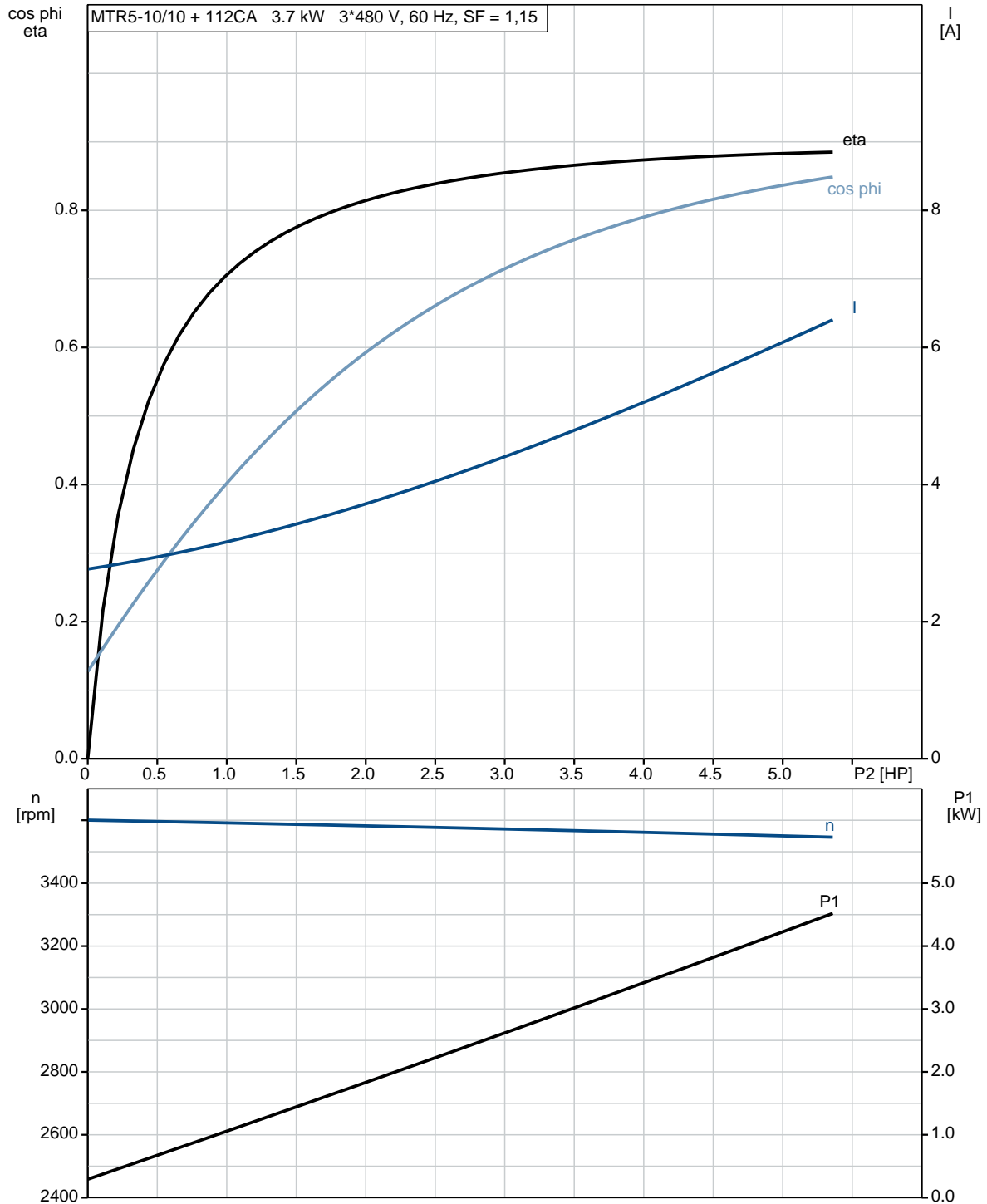

96515437 MTR 5-10/10 A-WB-A-HUUV 60 Hz

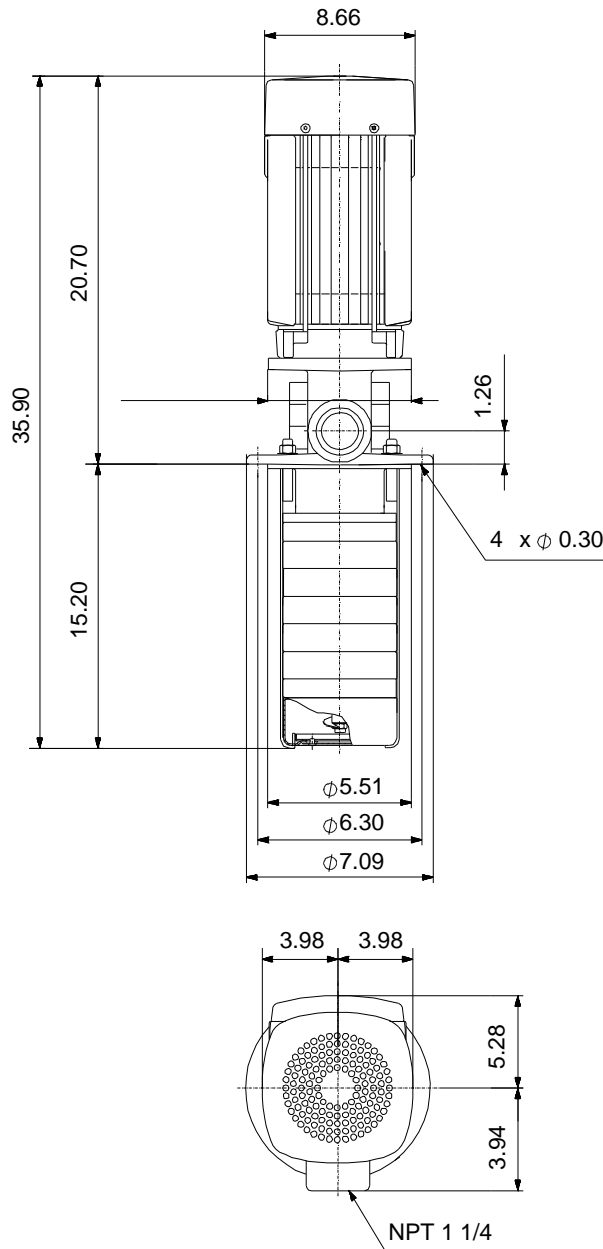

Note! All units are in [in] unless otherwise stated.
Disclaimer: This simplified dimensional drawing does not show all details.

96515437 MTR 5-10/10 A-WB-A-HUUV 60 Hz



WARNING

MOTOR MUST BE GROUNDED IN ACCORDANCE WITH THE NATIONAL ELECTRICAL CODE AND LOCAL CODES BY TRAINED PERSONNEL TO PREVENT SERIOUS ELECTRICAL SHOCKS.

TO SERVICE MOTOR, DISCONNECT POWER SOURCE FROM MOTOR AND ANY ACCESSORY DEVICES AND ALLOW MOTOR TO COME TO A COMPLETE STAND STILL.

LOW VOLTAGE 60Hz. 208-230V

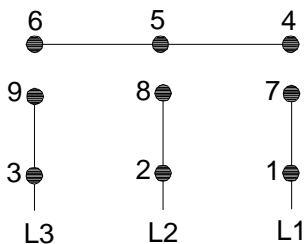

HIGH VOLTAGE 60Hz: 460V 50Hz: 400V

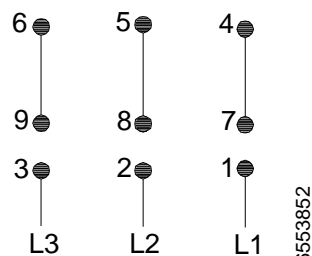

INTERCHANGE ANY TWO LINE
WIRES TO REVERSE ROTATION
THERMOSTAT LEADS
(WHEN PROVIDED)



All units are [in] unless otherwise presented.