

|                       |                  |             |
|-----------------------|------------------|-------------|
| PROJECT:              | UNIT TAG:        | QUANTITY:   |
| REPRESENTATIVE: _____ | TYPE OF SERVICE: | DATE: _____ |
| ENGINEER:             | SUBMITTED BY:    | DATE:       |
| CONTRACTOR:           | APPROVED BY:     | DATE:       |
|                       | ORDER NO.:       | DATE:       |



Product photo could vary from the actual product

### Hydro Multi-E 2 CRE 5-6

Energy efficient pressure boosting system for boosting of clean water. Available with 2 or 3 parallel connected frequency controlled pumps, integrated advanced controller and all necessary fittings.

| Conditions of Service   | Pump Data                              | Motor Data            |
|-------------------------|--|-----------------------|
| Efficiency: _____       | Maximum operating pressure: 232.06 psi | Rated voltage: 460 V  |
| Liquid: Water           | Liquid temperature range: 32 .. 140 °F | Main frequency: 60 Hz |
| Temperature: 68 °F      | Product number: On request             |                       |
| NPSH required: ft       |  |                       |
| Specific Gravity: 1.000 |  |                       |

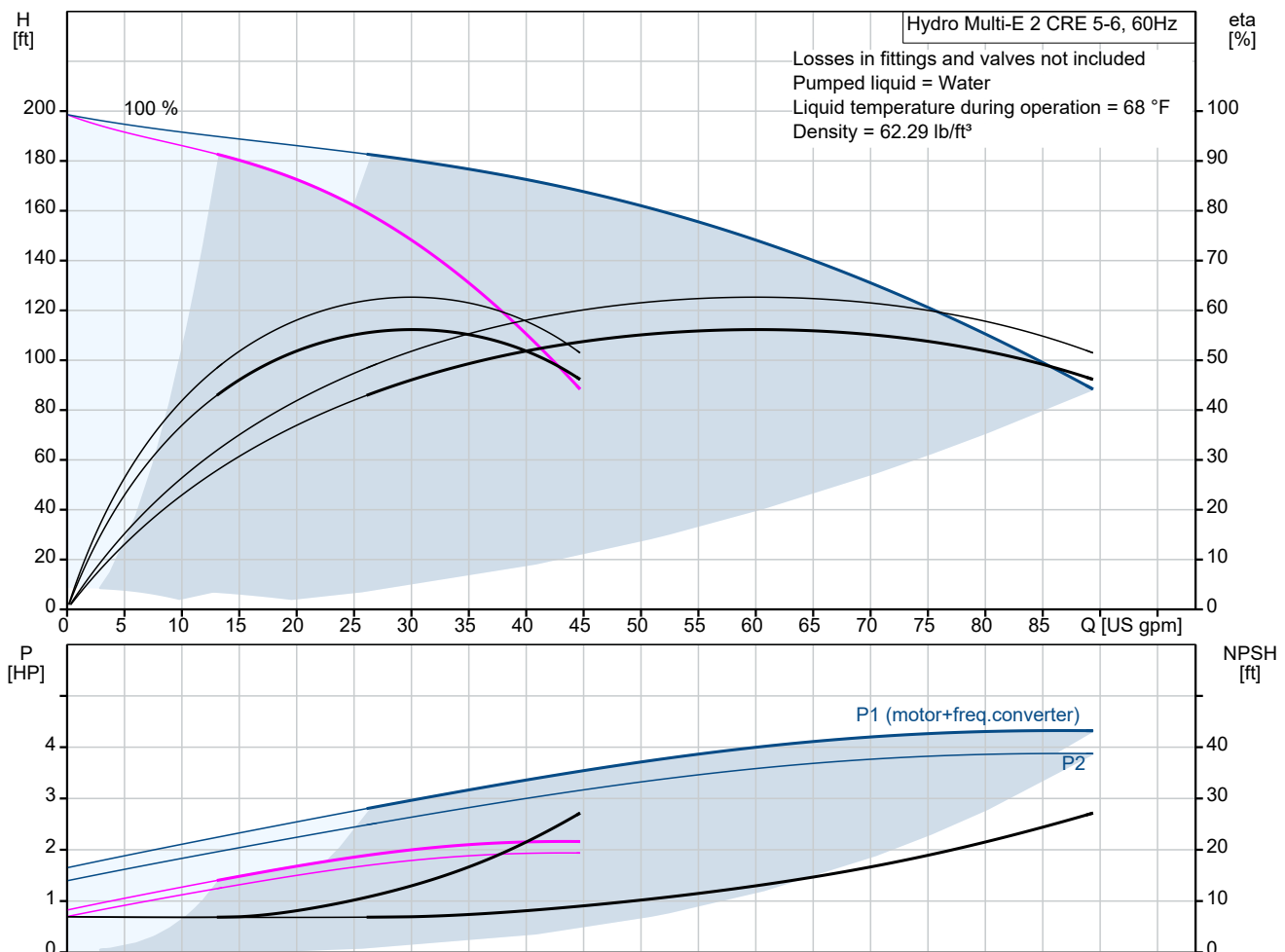

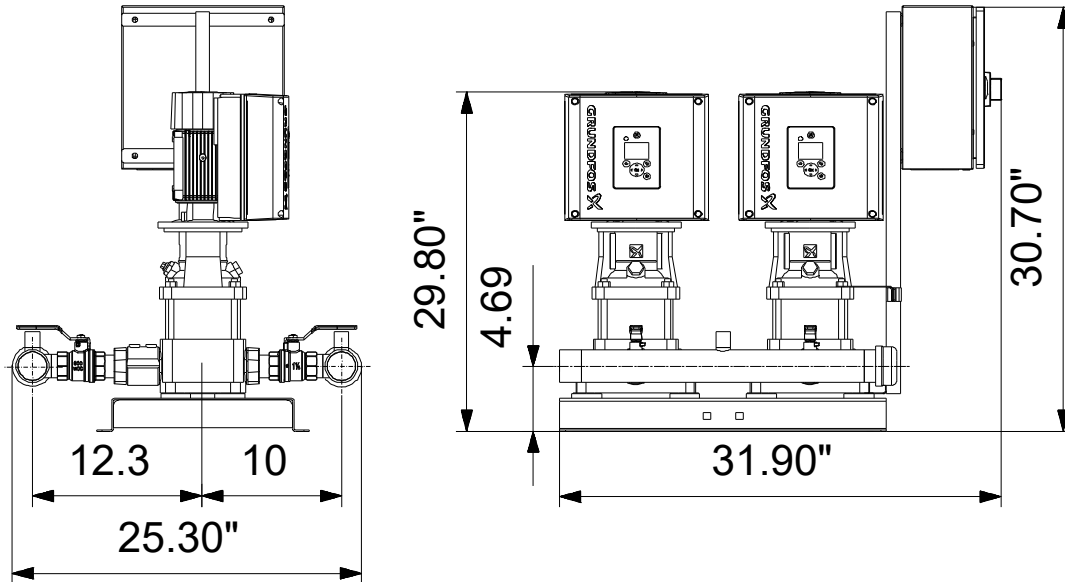

**Materials:**

Pump housing: Cast iron

Manifolds: Stainless steel

| Count | Description  |
|-------|--|
| 1     | <p><b>Hydro Multi-E 2 CRE 5-6</b></p>  <p>Product photo could vary from the actual product</p> <p>Product No.: On request</p> <p>A GRUNDFOS Hydro Multi-E booster set consists of 2 to 4 speed controlled CR pumps (CRE pumps). Each CRE pump is equipped with an integrated variable frequency drive motor (MLE motor).</p> <ul style="list-style-type: none"> <li>- Hydro Multi-E maintains constant pressure through continuous adjustment of the speed of the pumps.</li> <li>- The system performance is adapted to the demand through cutting in/out the required number of pumps and through parallel control of the pumps in operation.</li> <li>- Pump cascade control is based on first on first off to ensure equal pump wear.</li> <li>- All pumps in operation will run at equal speed.</li> </ul> <p>GRUNDFOS Hydro Multi-E booster sets are designed for pressure boosting of clean water in residential/commercial building, municipal, industrial, and irrigation applications.</p> <p>The control of the Hydro Multi-E system is accomplished through Proportional-Integral control via a multi-pump controller card mounted in one of the MLE motors.</p> <p>The Hydro Multi-E system start/stop and set-point adjustment is possible through the use of two push buttons located on the MLE motor or with the R100 remote controller.</p> <p>The system consists of these parts:</p> <ul style="list-style-type: none"> <li>- Suction manifold and discharge manifold made of 316 stainless steel.</li> <li>- Base frame made of 304 stainless steel.</li> <li>- One non-return valve (check valve), and two isolating valves for each pump.</li> <li>- Adapter with isolating valve for connection diaphragm tank.</li> <li>- Pressure gauge on suction and discharge manifolds.</li> <li>- Pressure transducer on discharge manifold.</li> <li>- Dry-running protection is standard with use of differential pressure switch on suction manifold.</li> <li>- A service disconnect switch located in a NEMA 3R enclosure is mounted to each pump for ease of service.</li> <li>- Grundfos bus communication with optional gateway connections for LON, Modbus, Profibus, BACnet, GSM</li> </ul> <p>When delivered, the GRUNDFOS Hydro Multi-E booster set is factory tested and ready for operation.</p> <p>Diaphragm tank is available as an accessory.</p> <p>Liquid:</p> <p>Pumped liquid: Water</p> <p>Liquid temperature range: 32 .. 140 °F</p> <p>Selected liquid temperature: 68 °F</p> <p>Density: 62.29 lb/ft³</p> <p>Materials:</p> <p>Pump housing: Cast iron</p> <p>Installation:</p> <p>Maximum operating pressure: 232.06 psi</p> |



Company name:

Created by:

Phone:

Date:

1/31/2022

| Count | Description  |
|-------|--|
|       | Maximum permissible inlet pressure: 145.04 psi<br>Manifold inlet: 2" NPT<br>Manifold outlet: 2" NPT<br><br>Electrical data:<br>Power (P2) main pump: 2 HP<br>Main frequency: 60 Hz<br>Rated voltage: 3 x 460 V<br>Rated voltage main pump: 3 x 460 V<br>Rated current: 5.3 A<br>Start. method: electronically<br>Radio interference supression: IEC/CISPR 11-1B<br><br>Tank:<br>Diaphragm tank: No<br><br>Others:<br>Net weight: 210 lb<br>Gross weight: 303 lb<br>Shipping volume: 33.9 ft³<br>Country of origin: US<br>Custom tariff no.: 8413.70.2040 |

## On request Hydro Multi-E 2 CRE 5-6 60 Hz

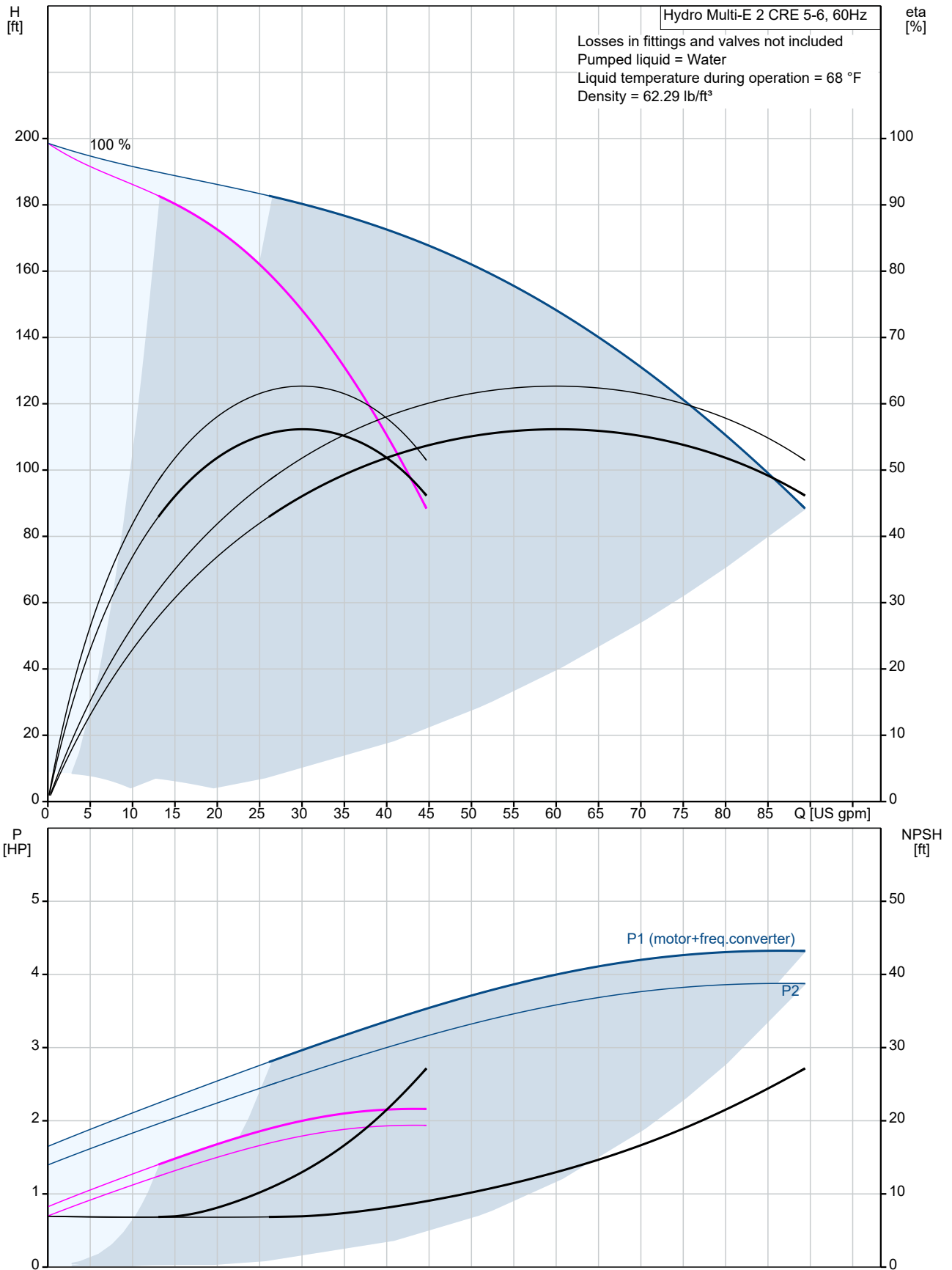

| Description                         | Value                   |
|-------------------------------------|-------------------------|
| <b>General information:</b>         |                         |
| Product name:                       | Hydro Multi-E 2 CRE 5-6 |
| Product No.:                        | On request              |
| EAN:                                | On request              |
| <b>Technical:</b>                   |                         |
| Min flow system:                    | 0 US gpm                |
| Max flow system:                    | 88.1 US gpm             |
| Maximum head:                       | 204.1 ft                |
| Pump name:                          | CRE5-6                  |
| Number of pumps:                    | 2                       |
| <b>Materials:</b>                   |                         |
| Pump housing:                       | Cast iron               |
| Manifolds:                          | Stainless steel         |
| <b>Installation:</b>                |                         |
| Maximum operating pressure:         | 232.06 psi              |
| Maximum permissible inlet pressure: | 145.04 psi              |
| Manifold inlet:                     | 2" NPT                  |
| Manifold outlet:                    | 2" NPT                  |
| <b>Liquid:</b>                      |                         |
| Pumped liquid:                      | Water                   |
| Liquid temperature range:           | 32 .. 140 °F            |
| Selected liquid temperature:        | 68 °F                   |
| Density:                            | 62.29 lb/ft³            |
| <b>Electrical data:</b>             |                         |
| Power (P2) main pump:               | 2 HP                    |
| Main frequency:                     | 60 Hz                   |
| Rated voltage:                      | 3 x 460 V               |
| Rated voltage main pump:            | 3 x 460 V               |
| Rated current:                      | 5.3 A                   |
| Start. method:                      | electronically          |
| Radio interference supression:      | IEC/CISPR 11-1B         |
| <b>Tank:</b>                        |                         |
| Diaphragm tank:                     | No                      |
| <b>Others:</b>                      |                         |
| Net weight:                         | 210 lb                  |
| Gross weight:                       | 303 lb                  |
| Shipping volume:                    | 33.9 ft³                |
| Sales region:                       | Namreg                  |
| Product range:                      | NAMREG                  |
| Country of origin:                  | US                      |
| Custom tariff no.:                  | 8413.70.2040            |

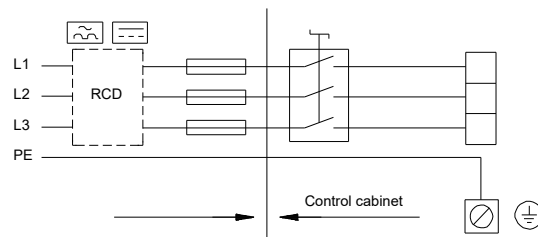
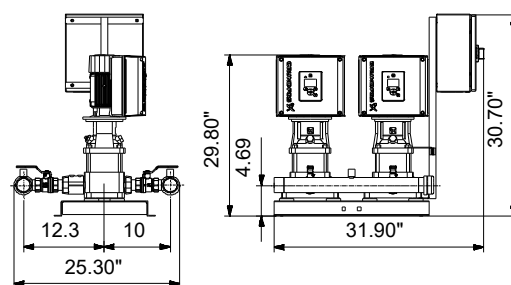
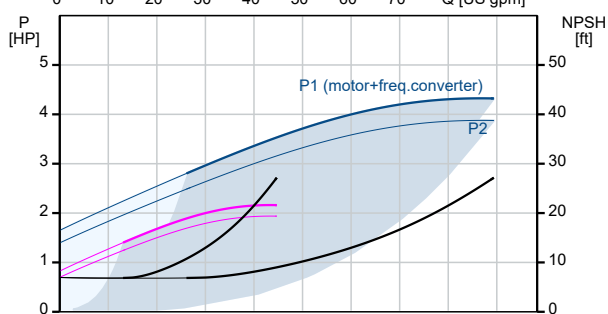
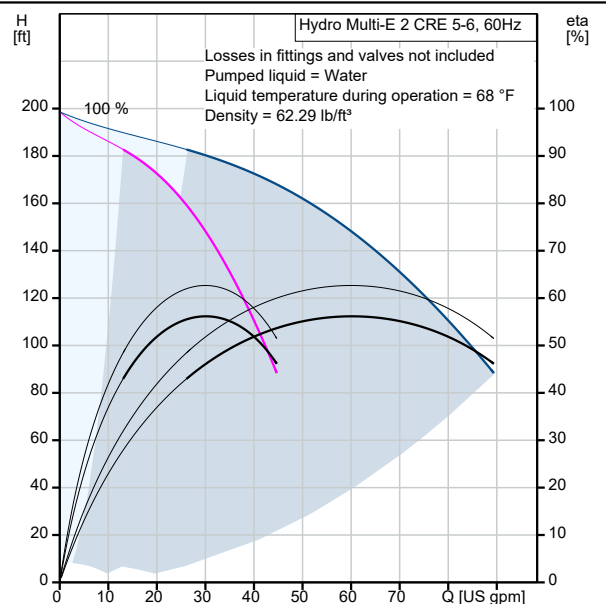

## On request Hydro Multi-E 2 CRE 5-6 60 Hz

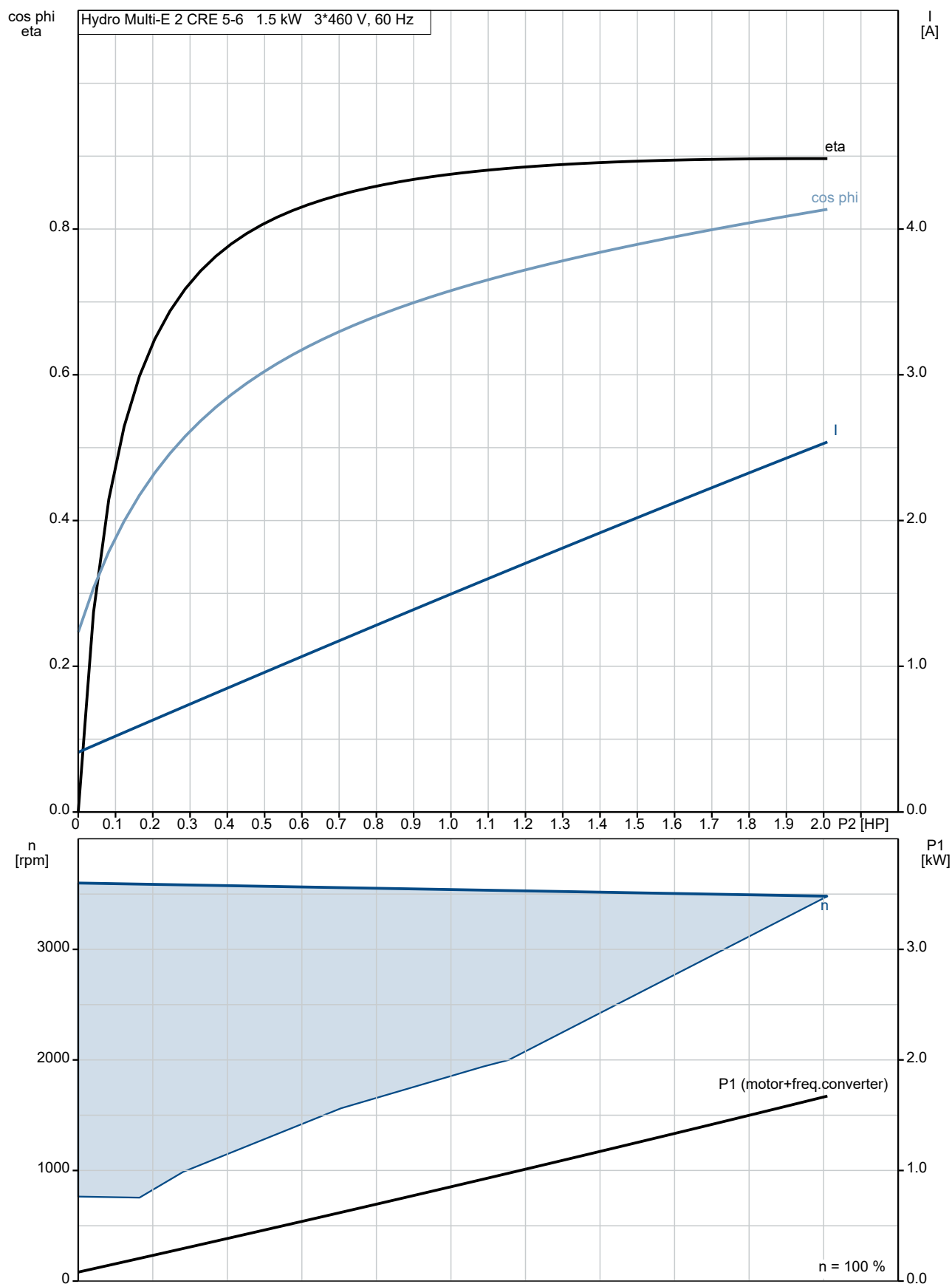

## On request Hydro Multi-E 2 CRE 5-6 60 Hz

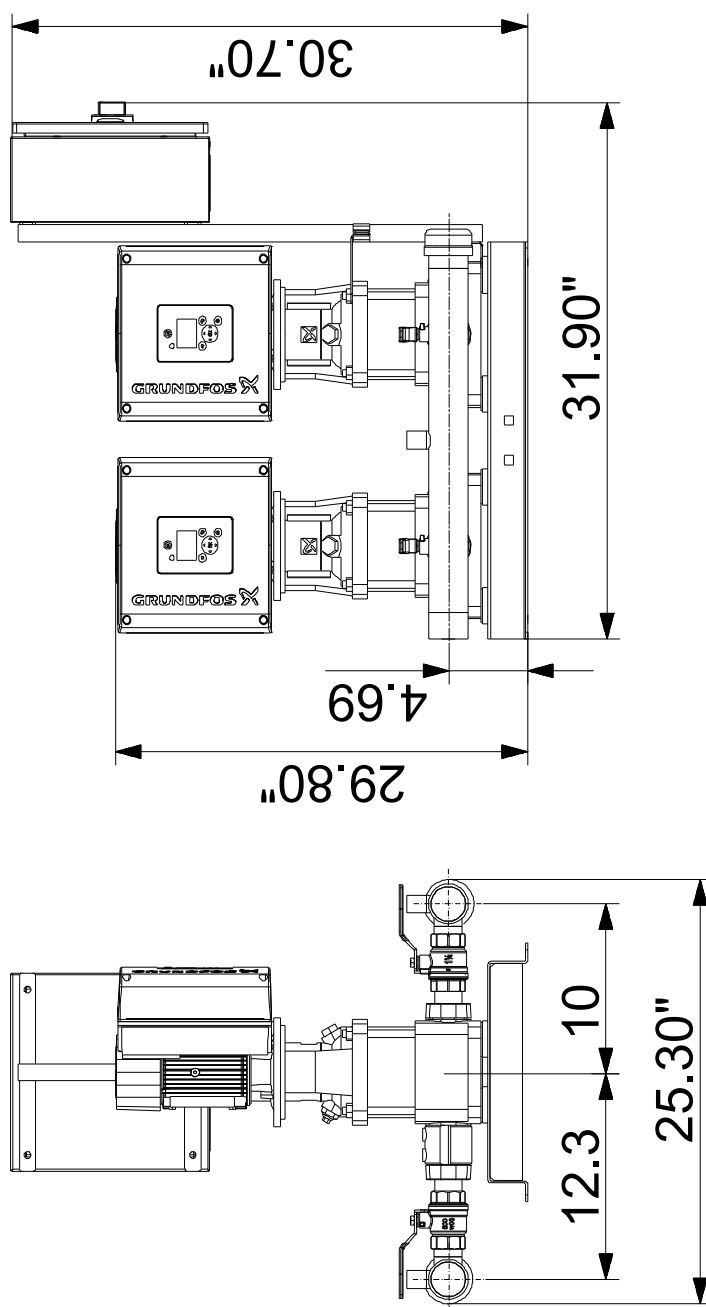

Note! All units are in [in] unless otherwise stated.

Disclaimer: This simplified dimensional drawing does not show all details.



## 9/9