

PROJECT: _____	UNIT TAG: _____	QUANTITY: _____
REPRESENTATIVE: _____	TYPE OF SERVICE: _____	DATE: _____
ENGINEER: _____	SUBMITTED BY: _____	DATE: _____
CONTRACTOR: _____	APPROVED BY: _____	DATE: _____
	ORDER NO.: _____	DATE: _____



Product photo could vary from the actual product

### Hydro Multi-E 2 CRE 15-1

Energy efficient pressure boosting system for boosting of clean water. Available with 2 or 3 parallel connected frequency controlled pumps, integrated advanced controller and all necessary fittings.

Conditions of Service	Pump Data	Motor Data
Efficiency: _____	Maximum operating pressure: 232.06 psi	Rated voltage: 460 V
Liquid: Water	Liquid temperature range: 32 .. 176 °F	Main frequency: 60 Hz
Temperature: 68 °F	Product number: 99334026	
NPSH required: ft		
Specific Gravity: 1.000		

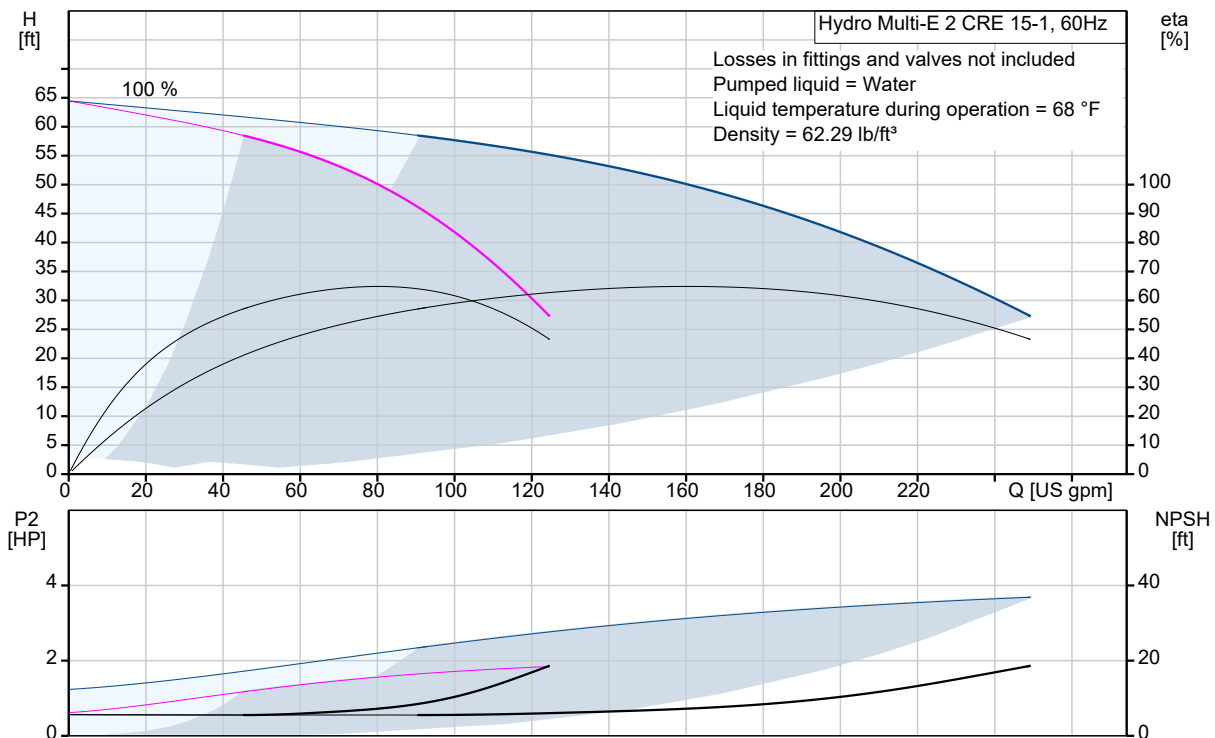

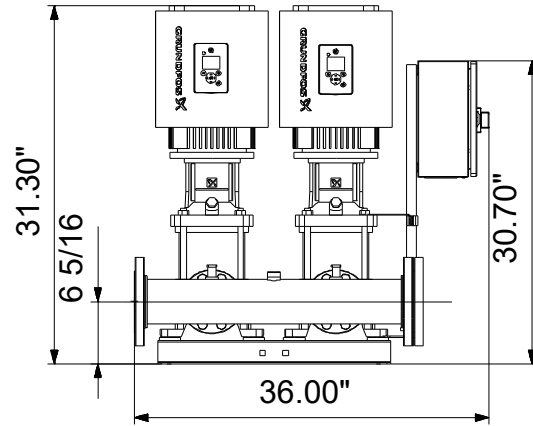
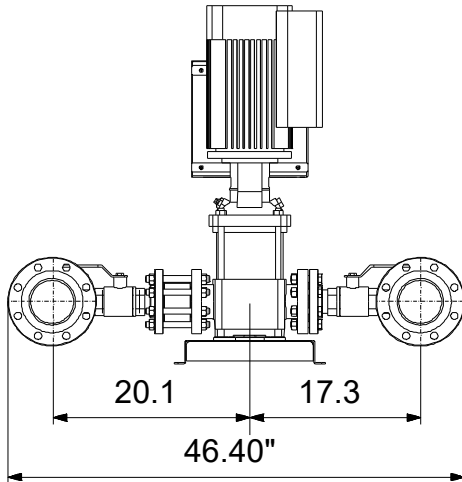

**Materials:**

Pump housing: Cast iron

Manifolds: Stainless steel

Count	Description
1	<p><b>Hydro Multi-E 2 CRE 15-1</b></p>  <p>Product photo could vary from the actual product</p> <p>Product No.: <a href="#">99334026</a></p> <p>A GRUNDFOS Hydro Multi-E booster set consists of 2 to 4 speed controlled CR pumps (CRE pumps).</p> <p>Each CRE pump is equipped with an integrated variable frequency drive motor (MLE motor).</p> <ul style="list-style-type: none"> <li>- Hydro Multi-E maintains constant pressure through continuous adjustment of the speed of the pumps.</li> <li>- The system performance is adapted to the demand through cutting in/out the required number of pumps and through parallel control of the pumps in operation.</li> <li>- Pump cascade control is based on first on first off to ensure equal pump wear.</li> <li>- All pumps in operation will run at equal speed.</li> </ul> <p>GRUNDFOS Hydro Multi-E booster sets are designed for pressure boosting of clean water in residential/commercial building, municipal, industrial, and irrigation applications.</p> <p>The control of the Hydro Multi-E system is accomplished through Proportional-Integral control via a multi-pump controller card mounted in one of the MLE motors.</p> <p>The Hydro Multi-E system start/stop and set-point adjustment is possible through the use of two push buttons located on the MLE motor or with the R100 remote controller.</p> <p>The system consists of these parts:</p> <ul style="list-style-type: none"> <li>- Suction manifold and discharge manifold made of 316 stainless steel.</li> <li>- Base frame made of 304 stainless steel.</li> <li>- One non-return valve (check valve), and two isolating valves for each pump.</li> <li>- Adapter with isolating valve for connection diaphragm tank.</li> <li>- Pressure gauge on suction and discharge manifolds.</li> <li>- Pressure transducer on discharge manifold.</li> <li>- Dry-running protection is standard with use of differential pressure switch on suction manifold.</li> <li>- A service disconnect switch located in a NEMA 3R enclosure is mounted to each pump for ease of service.</li> <li>- Grundfos bus communication with optional gateway connections for LON, Modbus, Profibus, BACnet, GSM</li> </ul> <p>When delivered, the GRUNDFOS Hydro Multi-E booster set is factory tested and ready for operation.</p> <p>Diaphragm tank is available as an accessory.</p>



Company name:

Created by:

Phone:

Date:

1/10/2022

Count	Description
	<p>Liquid:</p> <p>Pumped liquid: Water</p> <p>Liquid temperature range: 32 .. 176 °F</p> <p>Selected liquid temperature: 68 °F</p> <p>Density: 62.29 lb/ft³</p> <p>Materials:</p> <p>Pump housing: Cast iron</p> <p>Installation:</p> <p>Maximum operating pressure: 232.06 psi</p> <p>Maximum permissible inlet pressure: 116.03 psi</p> <p>Manifold inlet: 4" ANSI</p> <p>Manifold outlet: 4" ANSI</p> <p>Electrical data:</p> <p>Power (P2) main pump: 2 HP</p> <p>Main frequency: 60 Hz</p> <p>Rated voltage: 3 x 460 V</p> <p>Rated voltage main pump: 3 x 460 V</p> <p>Rated current: 5.3 A</p> <p>Start. method: electronically</p> <p>Radio interference supression: IEC/CISPR 11-1B</p> <p>Tank:</p> <p>Diaphragm tank: No</p> <p>Others:</p> <p>Net weight: 378 lb</p> <p>Gross weight: 601 lb</p> <p>Shipping volume: 89.7 ft³</p> <p>Country of origin: US</p> <p>Custom tariff no.: 8413.70.2040</p>



Company name:

Created by:

Phone:

Date:

1/10/2022

## 99334026 Hydro Multi-E 2 CRE 15-1 60 Hz

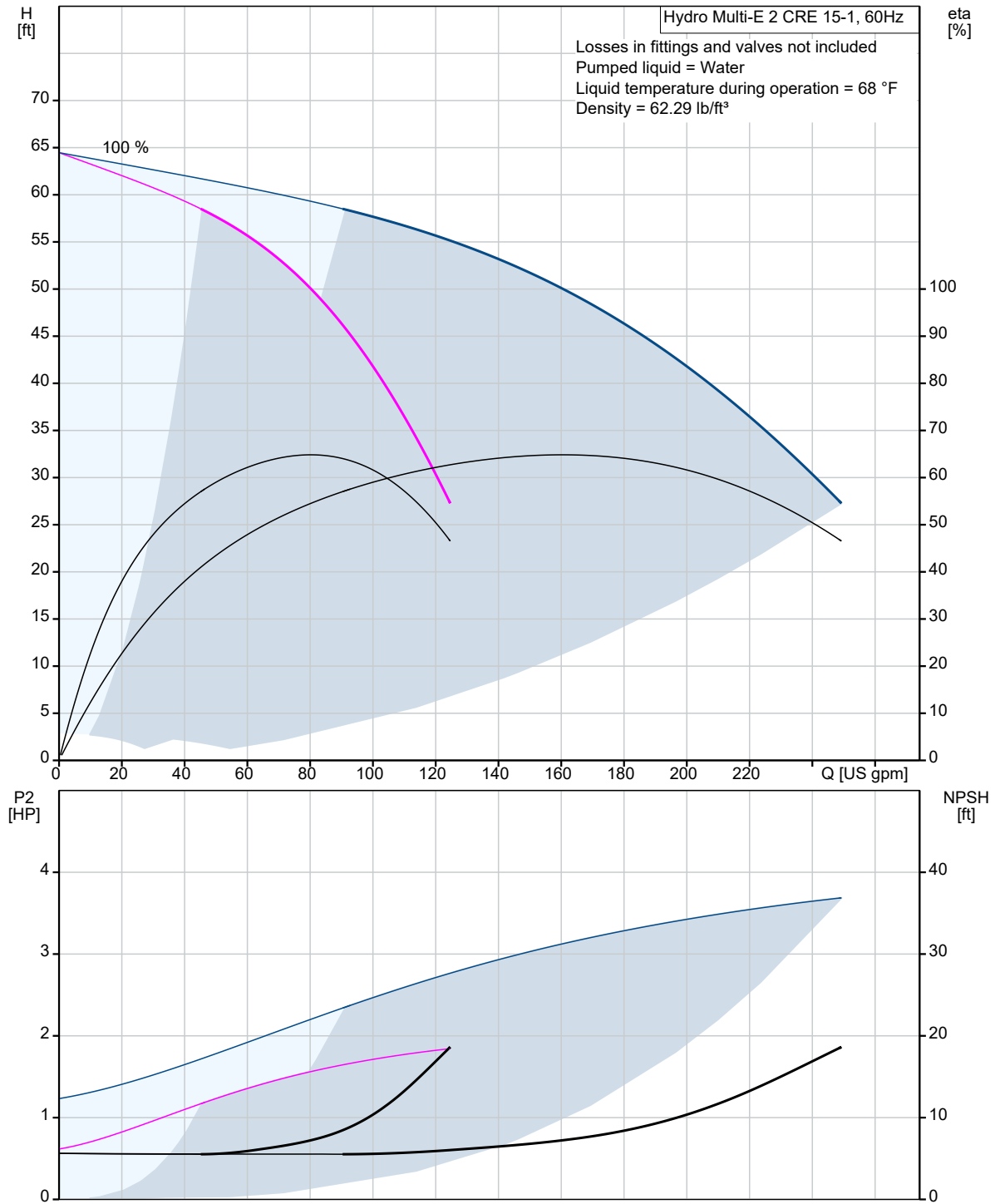

Description	Value
<b>General information:</b>	
Product name:	Hydro Multi-E 2 CRE 15-1
Product No.:	99334026
EAN:	5712609650856
<b>Technical:</b>	
Min flow system:	0 US gpm
Max flow system:	242 US gpm
Maximum head:	63.98 ft
Pump name:	CRE15-1
Number of pumps:	2
<b>Materials:</b>	
Pump housing:	Cast iron
Manifolds:	Stainless steel
<b>Installation:</b>	
Maximum operating pressure:	232.06 psi
Maximum permissible inlet pressure:	116.03 psi
<b>Liquid:</b>	
Pumped liquid:	Water
Liquid temperature range:	32 .. 176 °F
Selected liquid temperature:	68 °F
Density:	62.29 lb/ft³
<b>Electrical data:</b>	
Power (P2) main pump:	2 HP
Main frequency:	60 Hz
Rated voltage:	3 x 460 V
Rated voltage main pump:	3 x 460 V
Rated current:	5.3 A
Start. method:	electronically
Radio interference supression:	IEC/CISPR 11-1B
<b>Tank:</b>	
Diaphragm tank:	No
<b>Others:</b>	
Net weight:	378 lb
Gross weight:	601 lb
Shipping volume:	89.7 ft³
Sales region:	Namreg
Product range:	NAMREG
Country of origin:	US
Custom tariff no.:	8413.70.2040

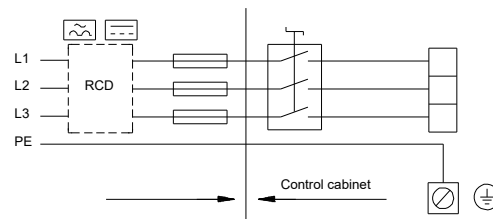
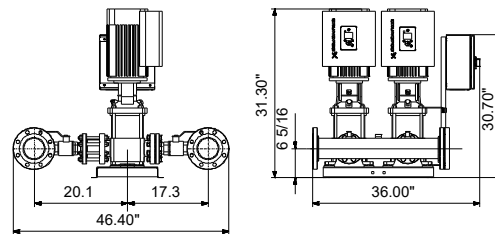
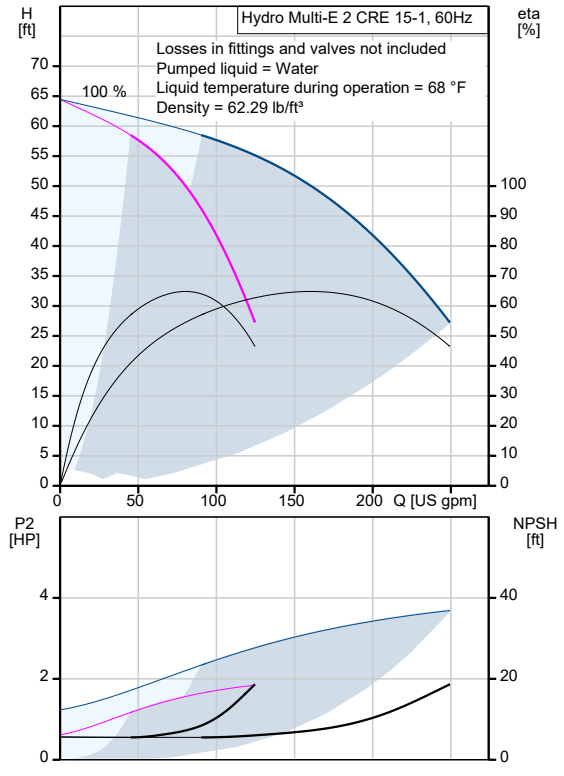

## 99334026 Hydro Multi-E 2 CRE 15-1 60 Hz

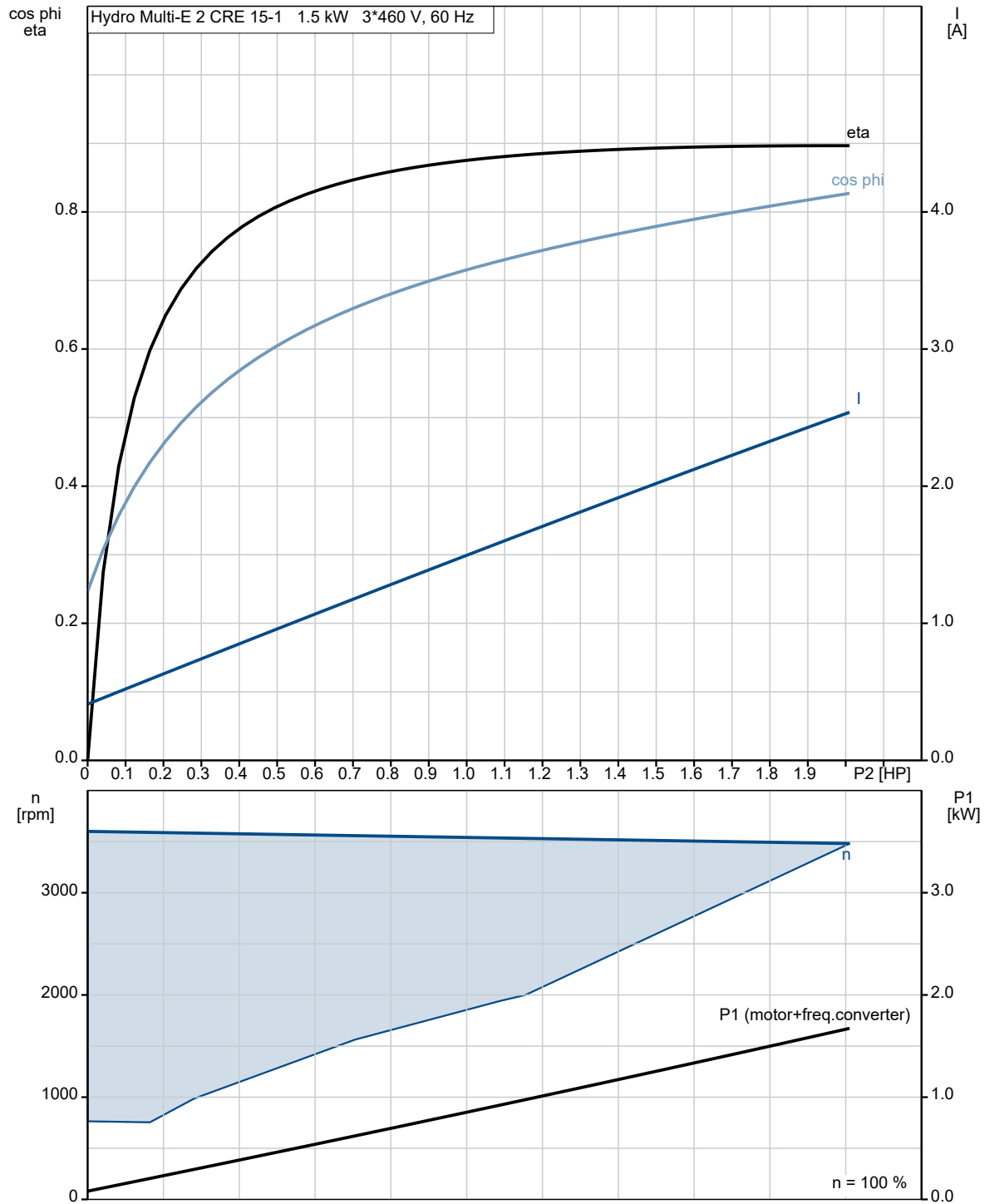



Company name:

Created by:

Phone:

Date:

1/10/2022

## 99334026 Hydro Multi-E 2 CRE 15-1 60 Hz

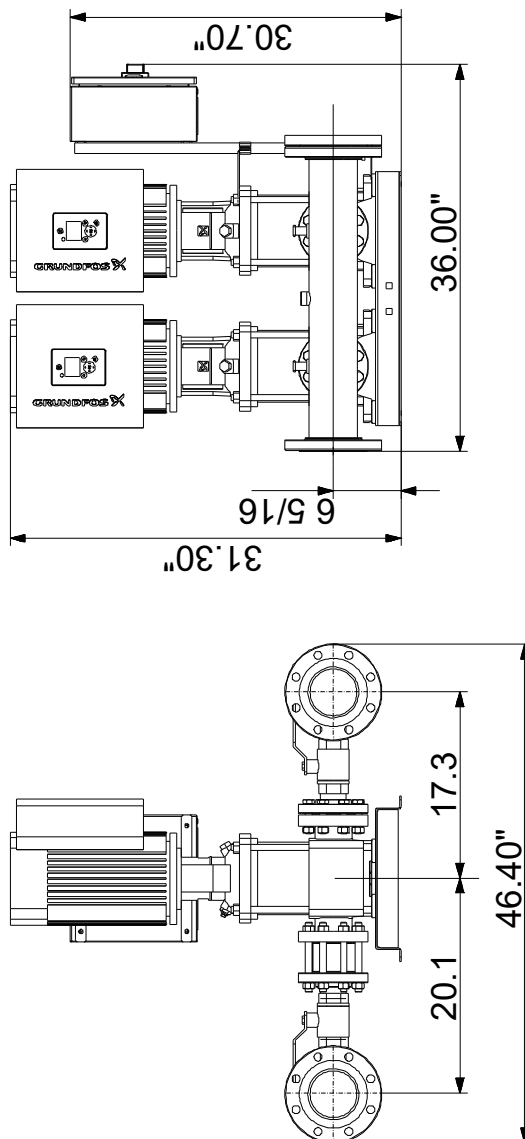

Note! All units are in [in] unless otherwise stated.  
Disclaimer: This simplified dimensional drawing does not show all details.



## 99334026 Hydro Multi-E 2 CRE 15-1 60 Hz

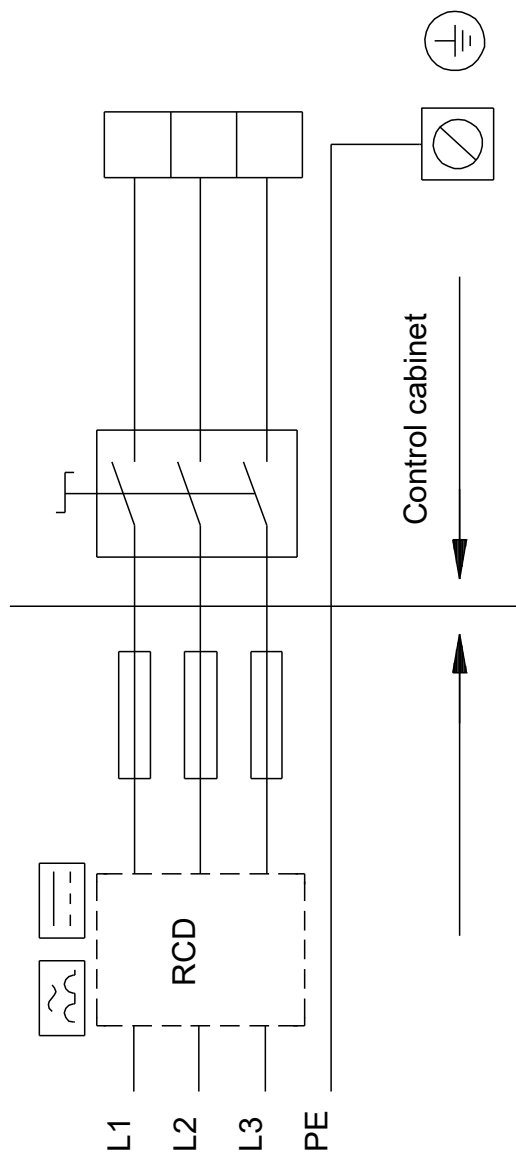

All units are [in] unless otherwise presented.