

# Submittal Data

PROJECT:	UNIT TAG:	QUANTITY:
REPRESENTATIVE: _____	TYPE OF SERVICE:	DATE: _____
ENGINEER:	SUBMITTED BY:	DATE:
CONTRACTOR:	APPROVED BY:	DATE:
	ORDER NO.:	DATE:



## Hydro Multi-E 3 CRE 3-15 UK A-A-A-U-A

Compact pump system with energy efficient integrated VFD/ECM motors with one motor having graphical interface controller for control of pump system. Available with 2-3 parallel connected pumps, single point power connection, and dual master motors for complete pump system control redundancy.

Note! Product picture may differ from actual product

Conditions of Service	Pump Data	Motor Data
Liquid: Water	Maximum operating pressure: 232.06 psi	Mains frequency: 60 Hz
Temperature: 68 °F	Liquid temperature range: 41 .. 179.6 °F	
Specific Gravity: 1.000	Maximum ambient temperature: 104 °F	
	Product number: 99445647	

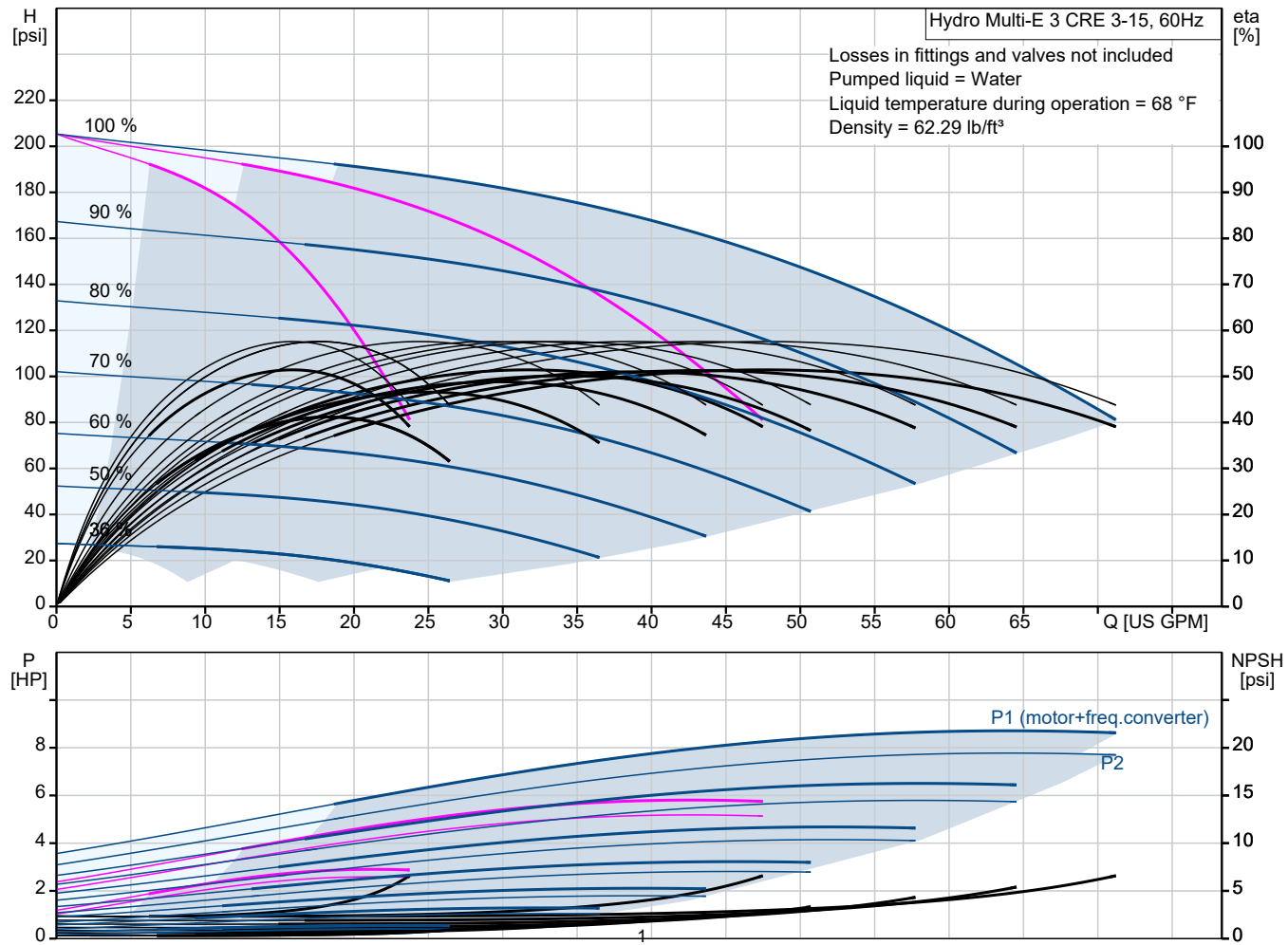

Submittal Data

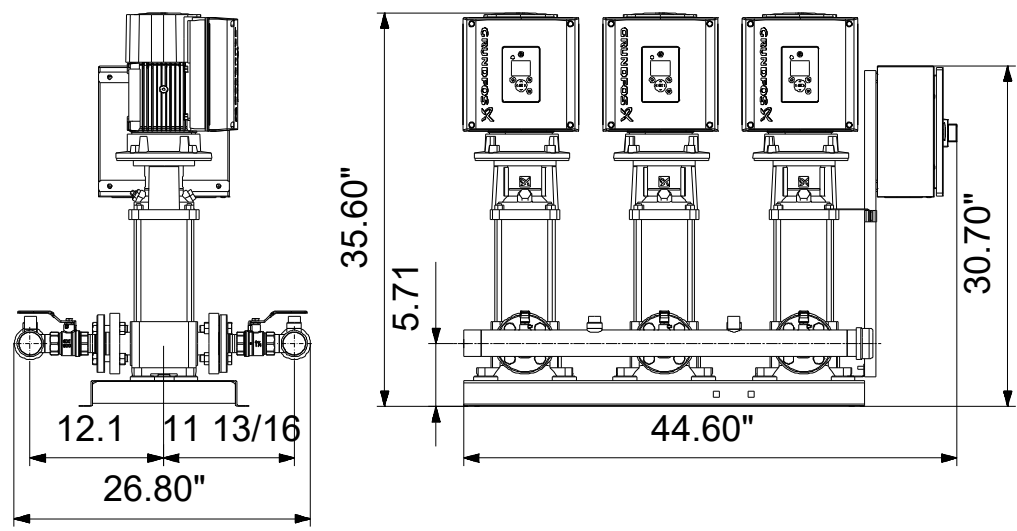

**Materials:**  
Pump housing: Cast iron

Project:

Reference Number:

Client:

Client Number:

Contact:

Qty. Description

1 Hydro Multi-E 3 CRE 3-15 UK A-A-A-U-A



Note! Product picture may differ from actual product

Product No.: [99445647](#)

A Grundfos Hydro Multi-E booster set consists of two to three variable-speed CR pumps (CRE pumps). Each CRE pump is equipped with an integrated variable frequency drive motor (MLE motor).

- Hydro Multi-E maintains constant pressure through continuous adjustment of pump speed.
- The system performance is adjusted to the demand by starting and stopping the required number of pumps and through parallel control of the pumps in operation.
- Pump cascade control is based on first on/first off to ensure equal pump wear.
- All pumps in operation will run at equal speed.

Grundfos Hydro Multi-E booster sets are designed for pressure boosting of clean water in residential and commercial buildings, municipal, industrial and irrigation applications.

All motors are capable of system control and two outlet sensors are mounted on the outlet manifold as a standard. This allows 100 % system control redundancy.

The system consists of these parts:

- single-point power connection: Disconnect panel with individual pump disconnect inside panel
- advanced control interface: System controller installed in one pump
- Inlet and outlet manifolds are made of 316 stainless steel.
- Base frame is made of 304 stainless steel.
- One non-return valve (check valve) and two isolating valves for each pump.
- adapter with isolating valve for connection of diaphragm tank
- pressure gauge on inlet and outlet manifolds
- pressure transducer on outlet manifold
- dry-running protection is standard with use of differential pressure switch on inlet manifold
- Grundfos bus communication with optional gateway connections for LON, Modbus, Profibus, BACnet, GSM.

When delivered, the Grundfos Hydro Multi-E booster set is factory tested and ready for operation.

Diaphragm tank is available as an accessory.

Controls:

Dry running protection: Pressure switch

Liquid:

Pumped liquid: Water

Liquid temperature range: 41 .. 179.6 °F

Selected liquid temperature: 68 °F

Density: 62.29 lb/ft<sup>3</sup>



Company name:

Created by:

Phone:

Date: 16/09/2025

Project:

Reference Number:

Client:

Client Number:

Contact:

Qty.	Description
1	<p>Technical:</p> <p>Rated flow: 46.2 US GPM</p> <p>Rated head: 152.6 psi</p> <p>Main pump type: CRE 3-15</p> <p>Materials:</p> <p>Pump housing: Cast iron</p> <p>Manifold: Stainless steel</p> <p>Installation:</p> <p>Maximum ambient temperature: 104 °F</p> <p>Maximum operating pressure: 232.06 psi</p> <p>Maximum permissible inlet pressure: 145.04 psi</p> <p>Manifold inlet: 2" NPT</p> <p>Manifold outlet: 2" NPT</p> <p>Electrical data:</p> <p>Power (P2) main pump: 3 HP</p> <p>Mains frequency: 60 Hz</p> <p>Rated voltage: 3 x 208-230 V</p> <p>Rated current: 24.9 A</p> <p>Method of start: E</p> <p>Radio interference supression: IEC/CISPR 11-1B</p> <p>Number of phases of main pump: 3</p> <p>Tank:</p> <p>Diaphragm tank: No</p> <p>Others:</p> <p>Net weight: 442 lb</p> <p>Gross weight: 664 lb</p> <p>Shipping volume: 89.7 ft³</p> <p>Country of origin: US</p> <p>Custom tariff no.: 8413.70.2040</p>



Company name:  
Created by:  
Phone:

Date: 16/09/2025

Project:  
Reference Number:

Client:  
Client Number:  
Contact:

## 99445647 Hydro Multi-E 3 CRE 3-15 UK A-A-A-U-A 60 Hz

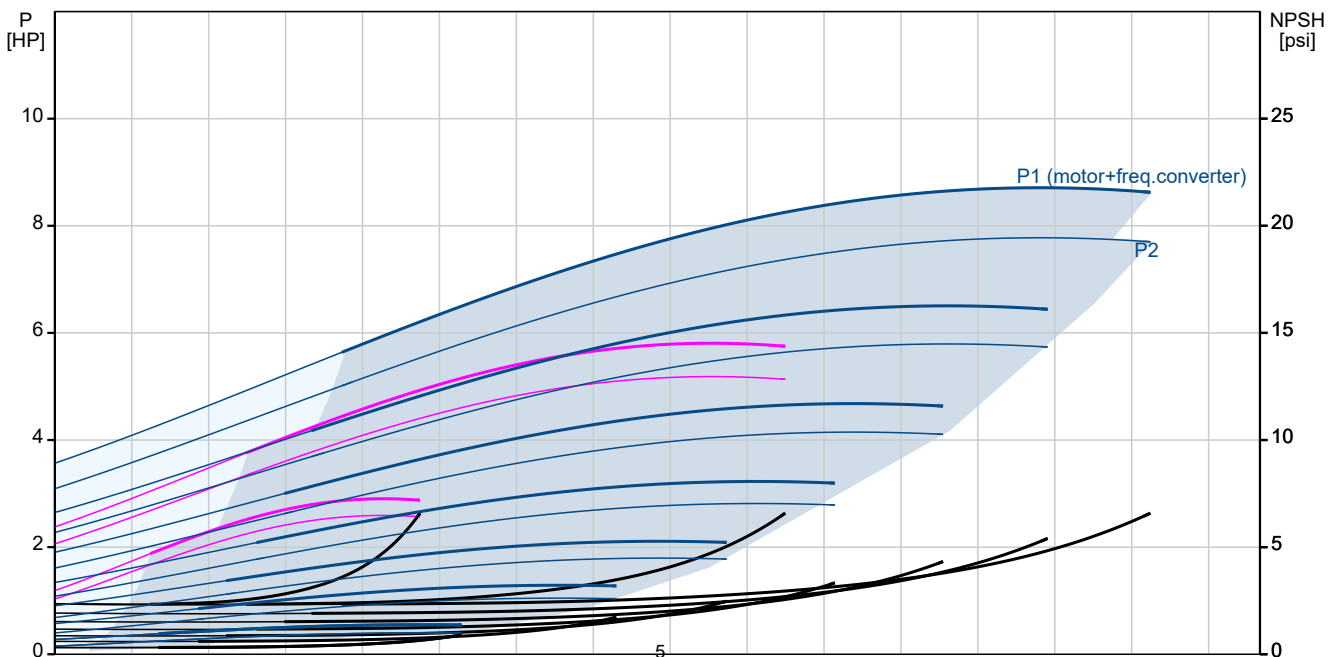
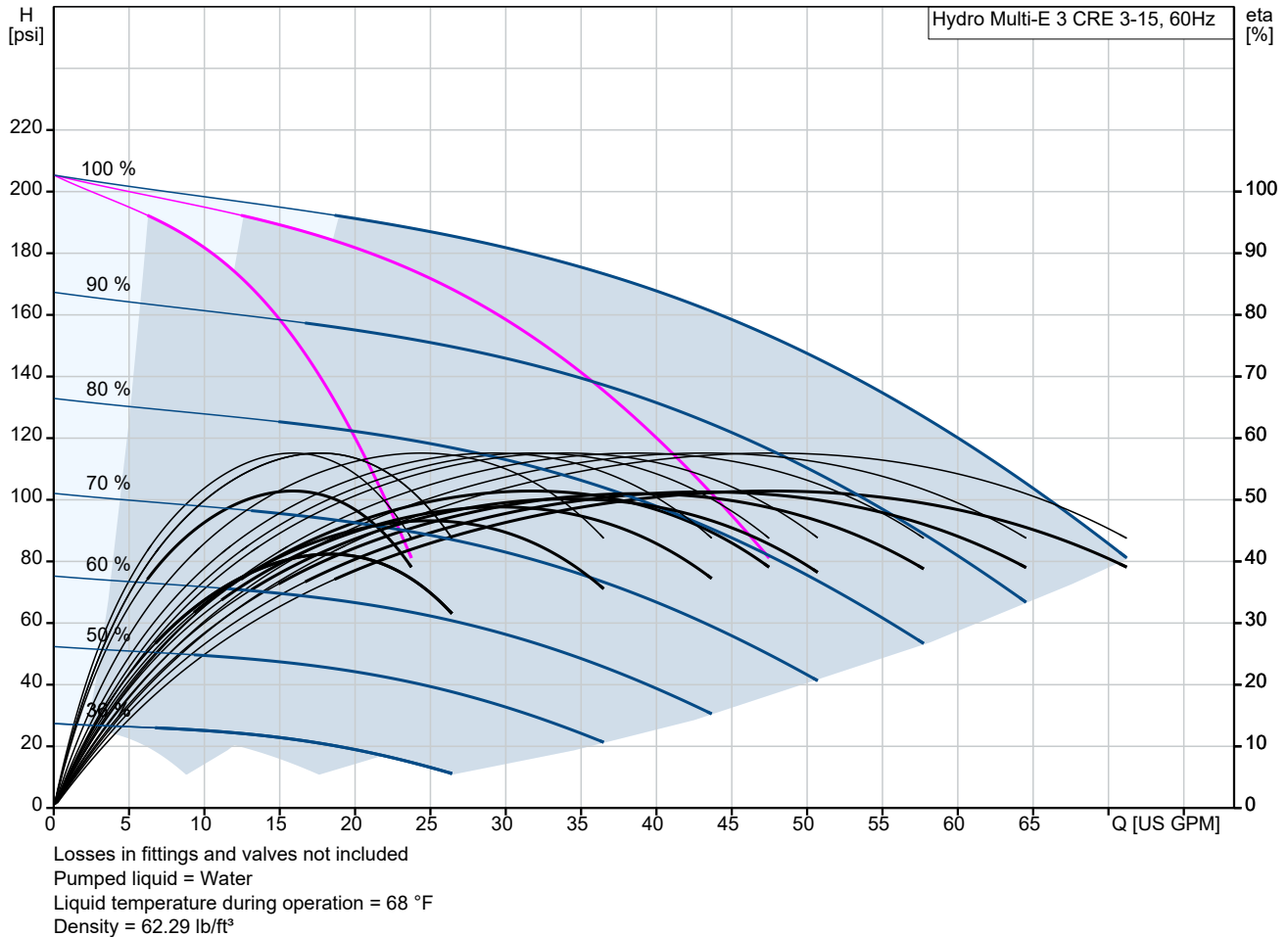

**Project:**

Reference Number:

**Client:**

Client Number:

Contact:

Description	Value
<b>General information:</b>	
Product name:	Hydro Multi-E 3 CRE 3-15 UK A-A-A-U-A
Product No:	99445647
EAN number:	5713829246997
<b>Technical:</b>	
Rated flow:	46.2 US GPM
Min flow system:	0 US GPM
Max flow system:	70.4 US GPM
Rated head:	152.6 psi
Maximum head:	204.3 psi
Number of pumps:	3
Main pump type:	CRE 3-15
<b>Materials:</b>	
Pump housing:	Cast iron
Manifold:	Stainless steel
<b>Installation:</b>	
Maximum ambient temperature:	104 °F
Maximum operating pressure:	232.06 psi
Maximum permissible inlet pressure:	145.04 psi
Manifold inlet:	2" NPT
Manifold outlet:	2" NPT
<b>Liquid:</b>	
Pumped liquid:	Water
Liquid temperature range:	41 .. 179.6 °F
Selected liquid temperature:	68 °F
Density:	62.29 lb/ft³
<b>Electrical data:</b>	
Power (P2) main pump:	3 HP
Mains frequency:	60 Hz
Rated voltage:	3 x 208-230 V
Rated current:	24.9 A
Method of start:	E
Radio interference suppression:	IEC/CISPR 11-1B
Number of phases of main pump:	3
<b>Controls:</b>	
Dry running protection:	Pressure switch
<b>Tank:</b>	
Diaphragm tank:	No
<b>Others:</b>	
Net weight:	442 lb
Gross weight:	664 lb
Shipping volume:	89.7 ft³
Sales region:	Namreg
Country of origin:	US
Custom tariff no.:	8413.70.2040

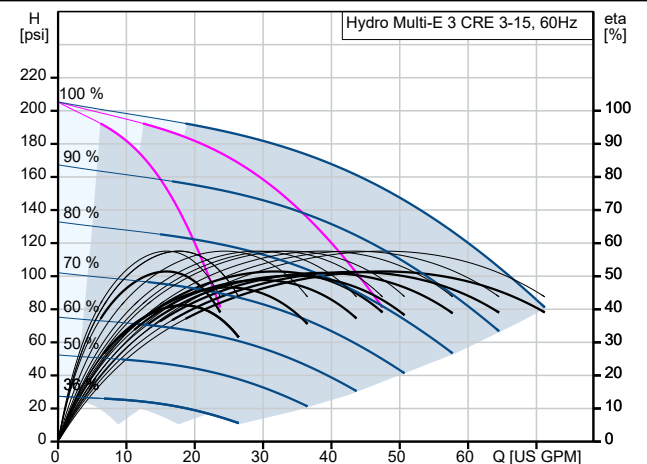

Losses in fittings and valves not included  
Pumped liquid = Water  
Liquid temperature during operation = 68 °F  
Density = 62.29 lb/ft³

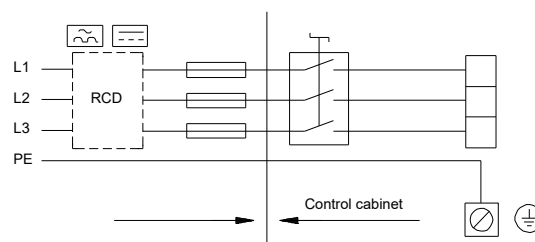
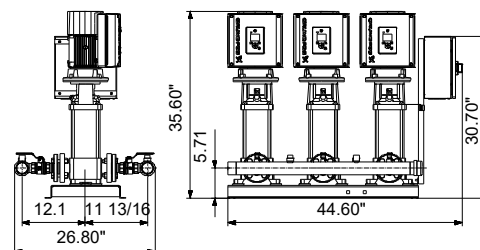
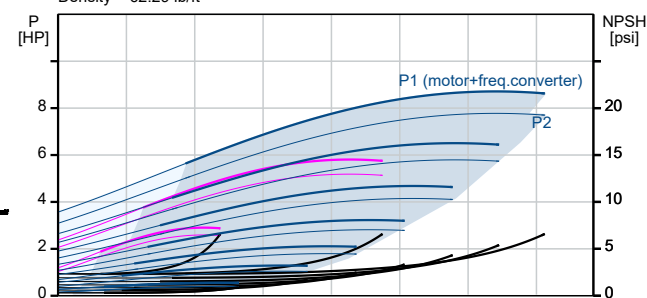

## 99445647 Hydro Multi-E 3 CRE 3-15 UK A-A-A-U-A 60 Hz

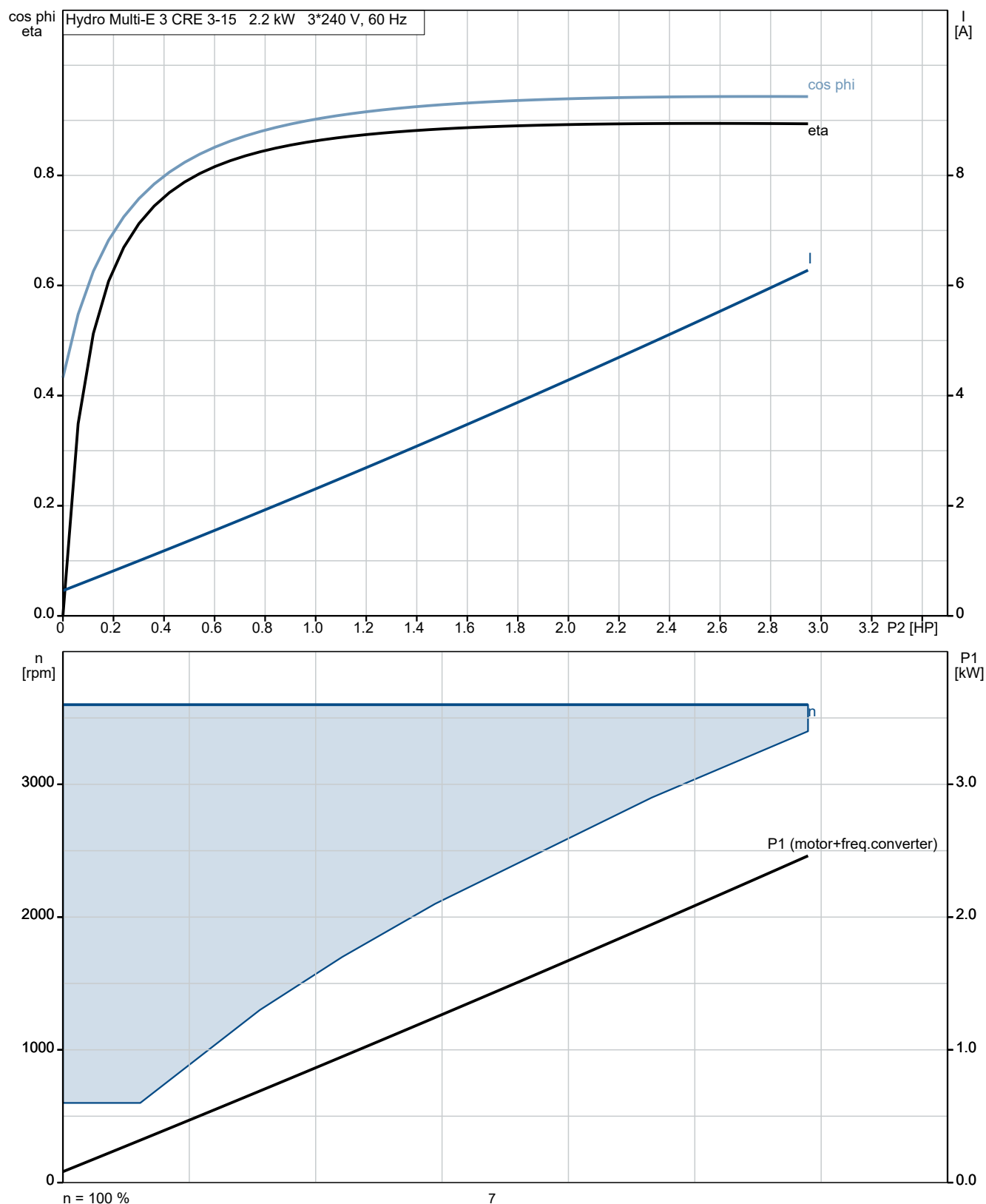



Company name:

Created by:

Phone:

Date:

16/09/2025

Project:

Reference Number:

Client:

Client Number:

Contact:

**99445647 Hydro Multi-E 3 CRE 3-15 UK A-A-A-U-A 60 Hz**

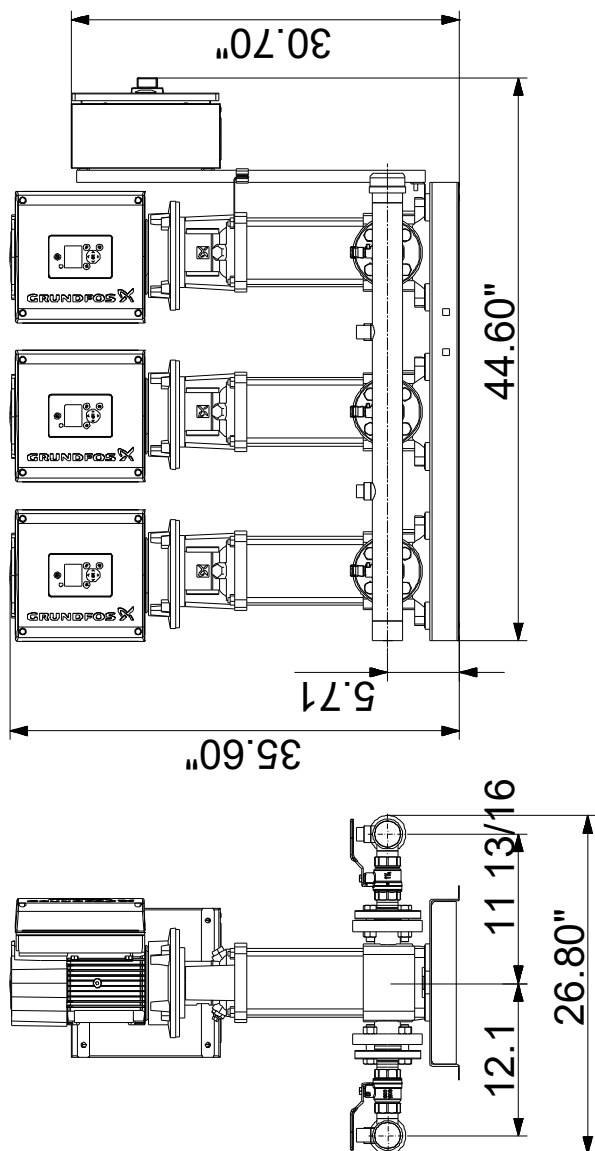

Note! All units are in [in] unless others are stated.

Disclaimer: This simplified dimensional drawing does not show all details.



Project:

Reference Number:

Client:

Client Number:

Contact:

**99445647 Hydro Multi-E 3 CRE 3-15 UK A-A-A-U-A 60 Hz**