

16 APPENDIX G – PUMP DIMENSIONS

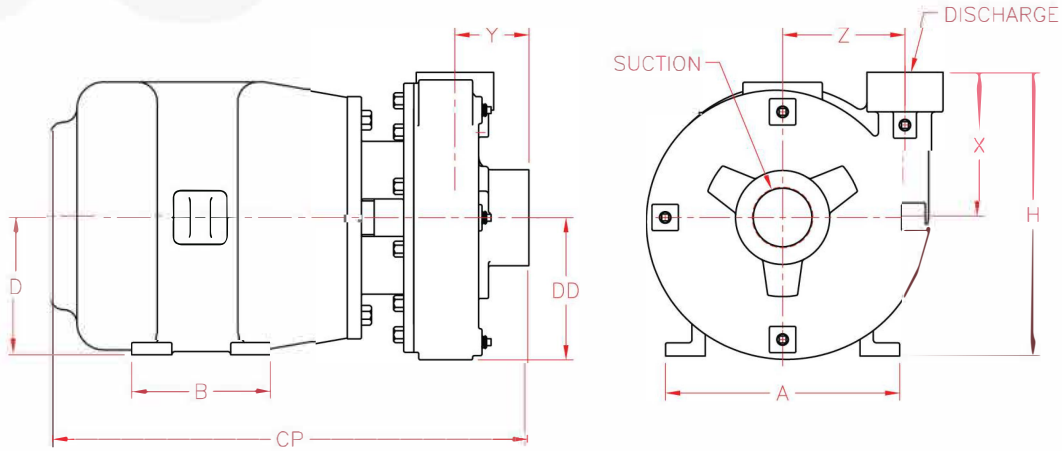

CLOSE COUPLED PUMP DIMENSIONS (in)



CC PUMP UNIT DIMENSIONS IN INCHES

Summit DOE Basic Model No.	Frame Size	Pump Size	PEI _{CL}		Max Impeller Dia. (in)	Dis.	Suc.	X	Y	Z	D *(max)*	DD	H* (max)
			1800 RPM (1440-2160)	3600 RPM (2880-4320)									
CC1-1x2-6	F1	1x2-6	*	0.94	6.00	1 NPT	2 NPT	4 3/4	2 5/8	3 3/8	5 1/4	4 1/4	1 1/2
CC1-1.5x2-6A	F1	1.5x2-6A	*	0.92	6.00	1 1/2 NPT	2 NPT	5	2 3/4	3 5/8	5 1/4	4 5/16	10
CC1-1.5x2-6J	F1	1.5x2-6J	*	0.98	6.00	1 1/2 NPT	2 NPT	5	2 3/4	3 5/8	5 1/4	4 5/16	10 1/4
CC1-2x2.5-6	F1	2x2.5-6	0.99	RTF	6.00	2 NPT	2 1/2 NPT	5 3/8	3 1/4	3 5/8	5 1/4	4 5/8	10 5/8
N/A	F1	4x5-7	RTF	RTF	7.00								
CC2-4x5-7	F2	4x5-7	0.99	RTF	7.00	4 Flg	5 Flg	7 3/8	2 5/8	5 1/2	8	6 13/16	15 3/8
CC1-1x2-8A	F1	1x2-8A	0.93	0.87	8.00								
CC2-1x2-8A	F2	1x2-8A	0.85	0.88	8.00	1 NPT	2 NPT	5 1/8	2 3/4	4 3/8	7	5 1/4	12 1/8
CC1-1x2-8G	F1	1x2-8G	0.92	0.87	8.00								
CC2-1x2-8G	F2	1x2-8G	0.95	0.91	8.00	1 NPT	2 NPT	5 1/8	2 3/4	4 3/8	8	5 1/4	13 1/8
CC1-1.5x2-8A	F1	1.5x2-8A	0.84	0.80	8.00	1 1/2 NPT	2 NPT	5 1/2	2 3/4	4 5/8	8	5 3/8	13 1/2
CC2-1.5x2-8A	F2	1.5x2-8A	0.93	0.88	8.00	1 1/2 NPT	2 NPT	5 1/2	2 3/4	4 5/8	8	5 3/8	13 1/2
CC1-1.5x2-8G	F1	1.5x2-8G	0.96	0.88	8.00								
CC2-1.5x2-8G	F2	1.5x2-8G	0.94	0.89	8.00	1 1/2 NPT	2 NPT	5 1/2	2 3/4	4 5/8	8	5 3/8	13 1/2
CC1-2x2.5-8A	F1	2x2.5-8A	0.96	0.96	8.00	2 NPT	2 1/2 NPT	6	3 1/8	4 5/8	8	5 1/2	13 1/2
CC2-2x2.5-8A	F2	2x2.5-8A	1.00	0.95	8.00								
CC1-2.5x3-8	F1	2.5x3-8	0.91	0.93	8.00	2 1/2 NPT	3 Flg	7 1/4	2 1/4	4 7/8	8	5 13/16	15 1/4
CC2-2.5x3-8	F2	2.5x3-8	0.96	0.95	8.00								
CC1-3x4-8A	F1	3x4-8A	0.95	0.97	8.00	3 Flg	4 Flg	7 1/2	2 3/16	5 1/4	8	6 9/16	15 1/2
N/A	F2	3x4-8A	RTF	RTF	8.00								
CC1-4x5-8	F1	4x5-8	0.96	Max 1800RPM	8.00	4 Flg	5 Flg	7 3/8	3 1/16	6	8	7 1/4	15 3/8
N/A	F2	4x5-8	RTF	Max 1800RPM	8.00								
N/A	F1	2x2.5-10A	RTF	Max 1800RPM	10.00	2 Flg	2 1/2 Flg	7	2 9/16	6	8	6 13/16	15
CC2-2x2.5-10A	F2	2x2.5-10A	0.89	Max 1800RPM	10.00								
CC1-2.5x3-10A	F1	2.5x3-10A	0.95	Max 1800RPM	10.00	2 1/2 Flg	3 Flg	7 1/2	2 5/16	6 1/16	8	7	15 1/2
N/A	F2	2.5x3-10A	RTF	RTF	10.00								
CC1-3x4-10A	F1	3x4-10A	0.96	Max 1800RPM	10.00	3 Flg	4 Flg	7 1/2	2 3/16	6 1/4	8	7 1/2	15 1/2
CC2-3x4-10A	F2	3x4-10A	0.98	Max 1800RPM	10.00								
CC1-4x5-10A	F1	4x5-10A	0.97	Max 1800RPM	10.00	4 Flg	5 Flg	8	2 7/8	7	8	8 1/8	16 1/8
CC2-4x5-10A	F2	4x5-10A	0.99	Max 1800RPM	10.00								
N/A	F1	5x6-10	RTF	Max 1800RPM	10.00	5 Flg	6 Flg	9	3 1/4	7 1/8	8	8 3/4	17 3/4
CC2-5x6-10	F2	5x6-10	0.94	Max 1800RPM	10.00								
CC1-2.5x3-11	F1	2.5x3-11	0.99	RTF	10.50	2 1/2 Flg	3 Flg	8 1/16	2 5/16	6 1/8	8	7 3/16	16 1/16
N/A	F2	2.5x3-11	RTF	RTF	10.50								
N/A	F1	4x5-11	N/A	N/A	10.50	4 Flg	5 Flg	9	2 5/8	6 1/2	8	7 13/16	17
N/A	F2	4x5-11	N/A	N/A	10.50								
CC2-1.5x2-12	F1	1.5x2-12	RTF	Max 1800RPM	12.00	1 1/2 NPT	2 NPT	7 1/2	3	6 3/4	8	7 3/8	15 9/16
CC2-1.5x2-12	F2	1.5x2-12	0.91	Max 1800RPM	12.00								
N/A	F1	2x2.5-12	RTF	Max 1800RPM	12.00	2 Flg	2 1/2 Flg	7 3/4	2 1/8	6 13/16	8	7 5/8	15 3/4
N/A	F2	2x2.5-12	RTF	Max 1800RPM	12.00								
N/A	F1	3x4-12	RTF	Max 1800RPM	12.00	3 Flg	4 Flg	9	2 1/4	7 1/8	8	8 3/8	17 3/8
N/A	F2	3x4-12	RTF	Max 1800RPM	12.00								
N/A	F1	4x5-12A	RTF	Max 1800RPM	12.00	4 Flg	5 Flg	9	2 7/16	7 1/2	8	9	18
N/A	F2	4x5-12A	RTF	Max 1800RPM	12.00								
N/A	F1	5x6-12	RTF	Max 1800RPM	12.00	5 Flg	6 Flg	9 3/8	3 1/2	8	8	9 3/4	19 1/8
N/A	F2	5x6-12	RTF	Max 1800RPM	12.00								
N/A	F1	6x8-12G	RTF	Max 1800RPM	12.00	6 Flg	8 Flg	8 7/8	6 5/16	9 7/8	8	12 3/8	21 1/4
N/A	F2	6x8-12G	RTF	Max 1800RPM	12.00								

MOTOR & PUMP DIMENSIONS*

RPM	Horse Power	A Max	B Max	CP Max	Approx. Wt. Lbs
1750	1	6 1/2	5 5/8	21	100
	1 1/2	6 1/2	6 1/8	22	105
	2	6 1/2	6 1/8	22	166
	3	8 5/8	6	24	191
	5	8 5/8	7	24	228
	7 1/2	9 3/4	7 3/8	27	256
	10	9 3/4	7 3/8	28	306
	15	12 1/8	10	31	377
	20	12 1/8	11 3/4	33	476
	25	13 5/8	11 1/2	33	508
	30	13 3/4	13	35	589
	40	15 3/16	13	36	734
3500	50	15 3/16	14 1/2	36	799
	60	15 3/16	14 1/2	38	812
	2	6 1/2	6 1/8	21	103
	3	8 5/8	6	24	130
	5	8 5/8	7	24	165
	7 1/2	8 5/8	7	27	235
	10	9 3/4	7 3/8	29	265
	15	9 3/4	8 7/8	31	365
	20	12 1/8	10	33	435
	25	12 1/8	11 3/4	33	452
	30	13 5/8	11 1/2	34	515
	40	13 3/4	13	35	640
50	15 3/16	13	37	705	
60	15 3/16	14 1/2	39	640	
75	17 1/8	15 3/8	41	731	
100	20	17 5/8	44	791	

* Largest pump size used with listed motor

PUMP & MOTOR FRAME SIZE RANGE

Pump Frame	Motor Frame Range
CC1	143JM - 215JM
CC2	254JM - 326JM
CC1 12" Impeller	213JM - 215JM

* Pump maximum height (H) includes centerline height through shaft to bottom of motor or bottom of casing; whichever is greater.
 i.e., Model 1x2-6, H = X + D
 Model 4x5-8, H = X + DD
 NPT = American standard taper pipe thread.
 Flg = Discharge; 125 lb. ANSI; Suction, equivalent to 125 lb. ANSI