



10SVE1GC4YM0

Created On: 1/8/26

10SVE1GC4YM0 | Configuration Summary



e-SVE series is equipped with an intelligent control that optimizes hydraulic performance while minimizing waste. It is a pre-programmed package combining the e-SV multi-stage pump with a Xylem Smart Motor – an “ultra-premium” level IES permanent magnet motor with a wide range of monitoring, control and safety features.

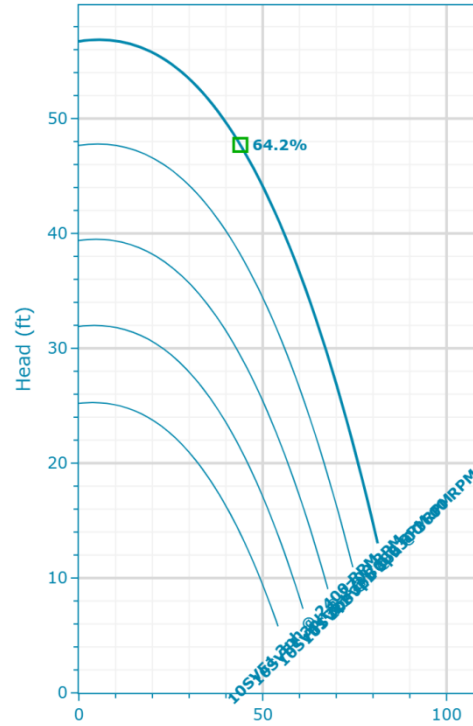

Performance according to ISO 9906:2012

PUMP

Installation
Complete Pump

MATERIALS

| | |
|--|--|
| Pump Body Material Cast Iron (ASTM Class 35/40B) | Impeller Material Stainless Steel (AISI 304) |
|--|--|

SEAL

| | |
|---|---|
| Type of Seal Mechanical Seals | Rotating Face Carbon |
| | Stationary Face Silicon Carbide Graphite Filled |
| | Elastomers Viton |
| | Spring 316 SS |
| | Metal Component 316 SS |

STANDARD OPTIONS

Special Configuration
Please Select

MOTOR

| | |
|--------------------------|-------------------------------------|
| Poles 2 | Power 1 hp |
| Enclosure TEFC | Phase (~) 3 |
| | Voltage 208-240/380-460 V |

FLANGE

Flange
[G] = Round Flanges (AISI 304/Cast Iron)

10SVE1GC4YM0 | Product Details

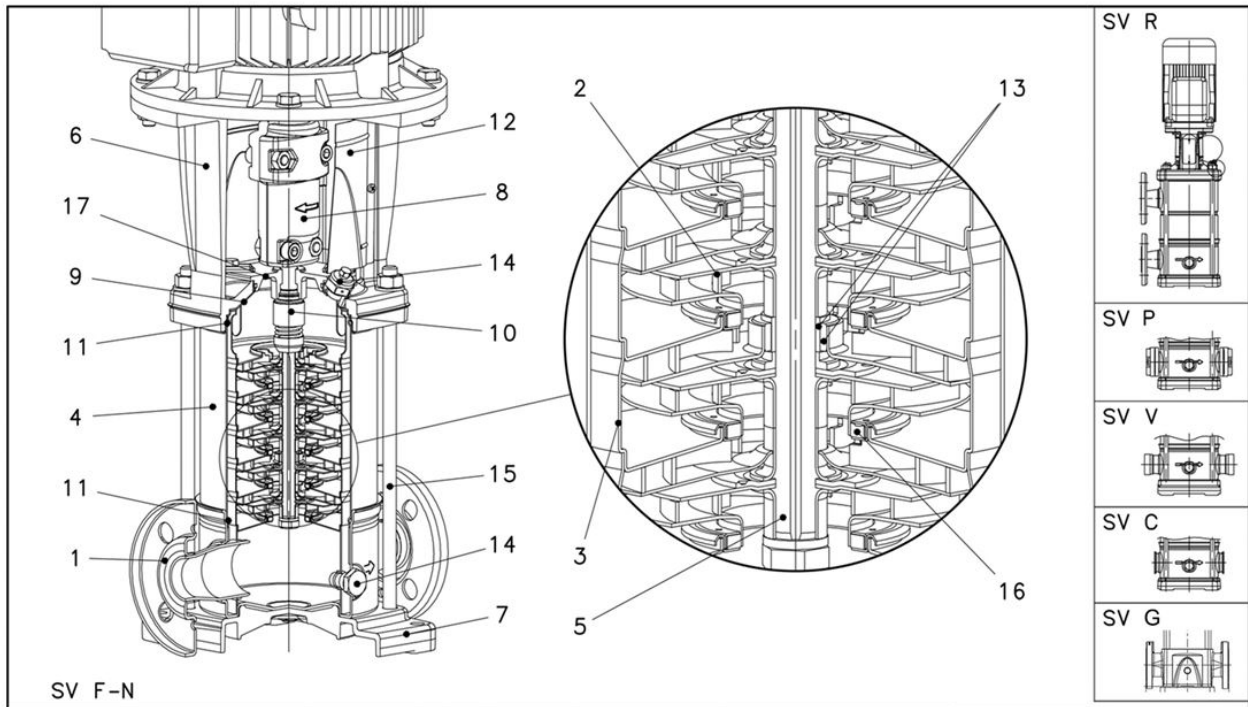

Construction Materials

| | | | |
|---|---|--|--|
| Pump Body (1) Cast Iron (ASTM Class 35/40B) | Shaft (5) Stainless Steel (AISI 316) | Seal Plate (9) Stainless Steel (AISI 316L) | Fill/Drain Plugs (14) Stainless Steel (AISI 316) |
| Impeller (2) Stainless Steel (AISI 304) | Adapter (6) Cast Iron (ASTM Class 35/40B) | Elastomers (11) Refer Mechanical Seals | Tie Rods (15) Carbon Steel / Zinc Plated (A29 Gr.1045) |
| Diffuser (3) Stainless Steel (AISI 304) | Base (7) N/A | Coupling Guard (12) Stainless Steel (AISI 304) | Wear Ring (16) PPS |
| Casing (4) Stainless Steel (AISI 316L) | Coupling (8) Aluminum (A384.0-F) | Shaft Sleeve and Bushing (13) Tungsten Carbide | Seal Gland (17) Stainless Steel (AISI 316) |

Motor

| | | | |
|----------------------------|---|-----------------------------------|-----------------------------------|
| Enclosure TEFC | Rated Power 1 Hp | Phase 3 | SLA 3.74-3.28/2.43-2.20 |
| Speed 3600.0 rpm | Rated Voltage 208-240/380-460 V | FLA 3.74-3.28/2.43-2.20 | |

10SVE1GC4YM0 | Hydraulic Data & Performance Curve

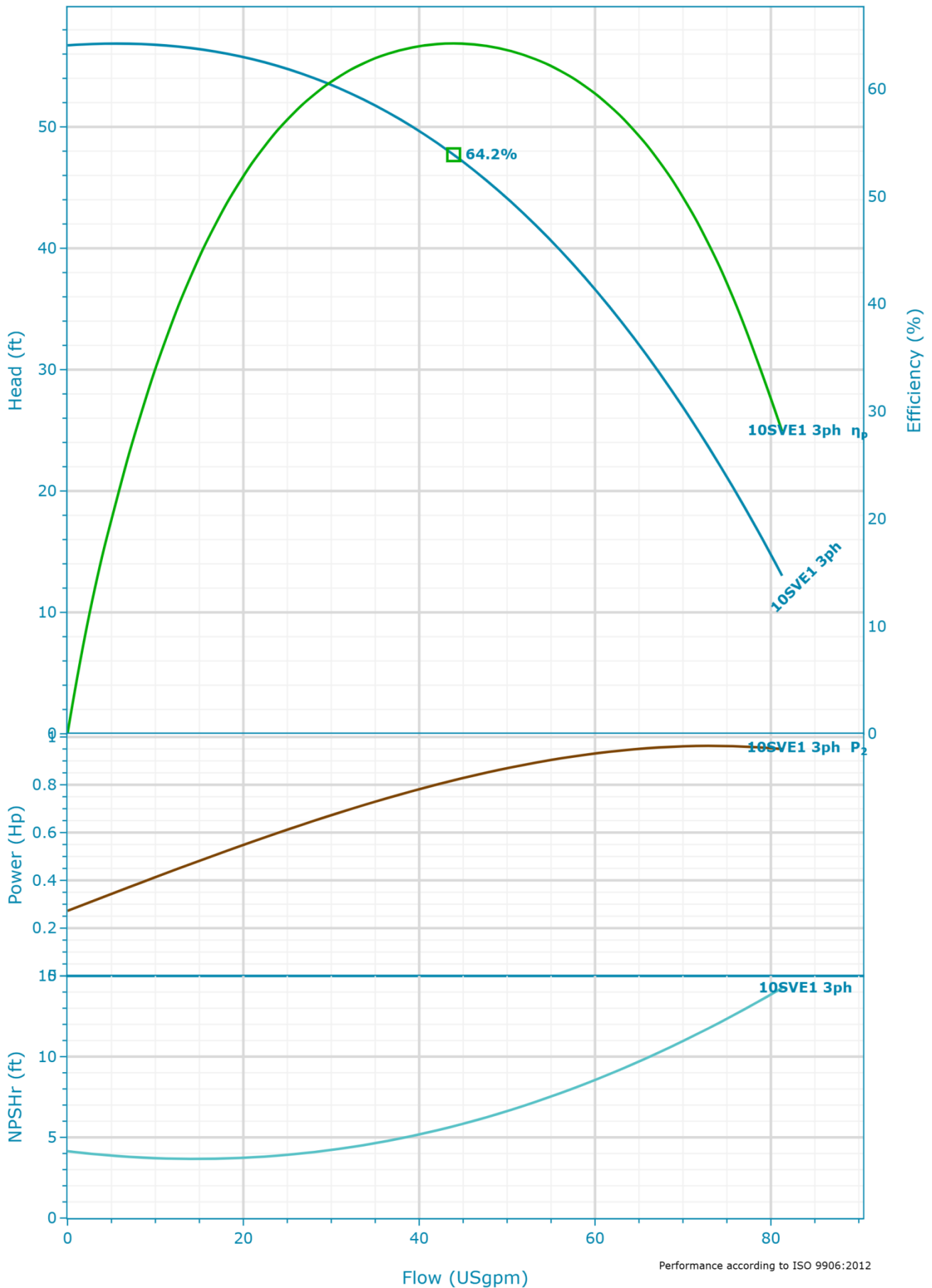

Selection

Series Standby Pumps
e-SVE No Standby Pump

Name
10SVE1 3ph 3600rpm

Stages
1

Frequency
60 Hz

Acceptance Grade
Manufacturer's Standard

System Type
Single Pump

Operating Pumps
1

Fluid and Operating Conditions

Fluid Type Density
Water 62.43 lb/ft³

Fluid Temperature Dynamic Viscosity
39.2 °F 1.57 cP

Specific Gravity Fluid Vapor Pressure
1 0.12 psi

Atmospheric Pressure
14.7 psi

Elevation
0 ft

Ambient Temperature
68 °F

NPSH Available
33.68 ft

Submergence
0 ft

Design Curve

Rated Speed BEP Flow
3,600 RPM 43.92 USgpm

Max Flow BEP Head
81.28 USgpm 47.71 ft

H@QMin Max Operating Pressure
56.72 ft 24.62 psi

H@QMax Max P2
13.02 ft 0.96 Hp

BEP
64.23 %

10SVE1GC4YM0 | Variable Speed Curve

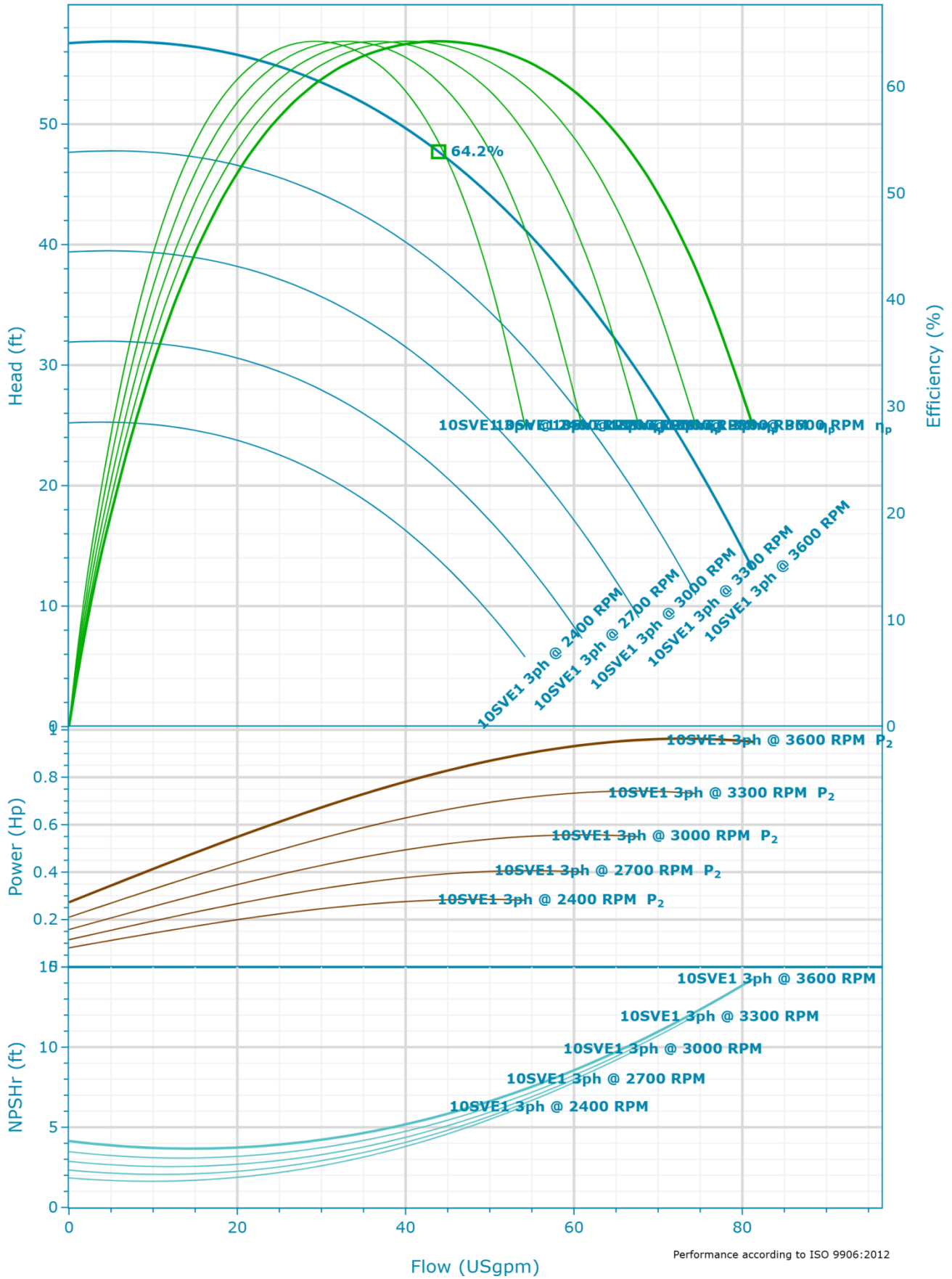

Performance according to ISO 9906:2012

10SVE1GC4YM0 | Dimensional Data & Drawing

**10 SVE SERIES - THREE PHASE VERSION
DIMENSIONS AND WEIGHTS**

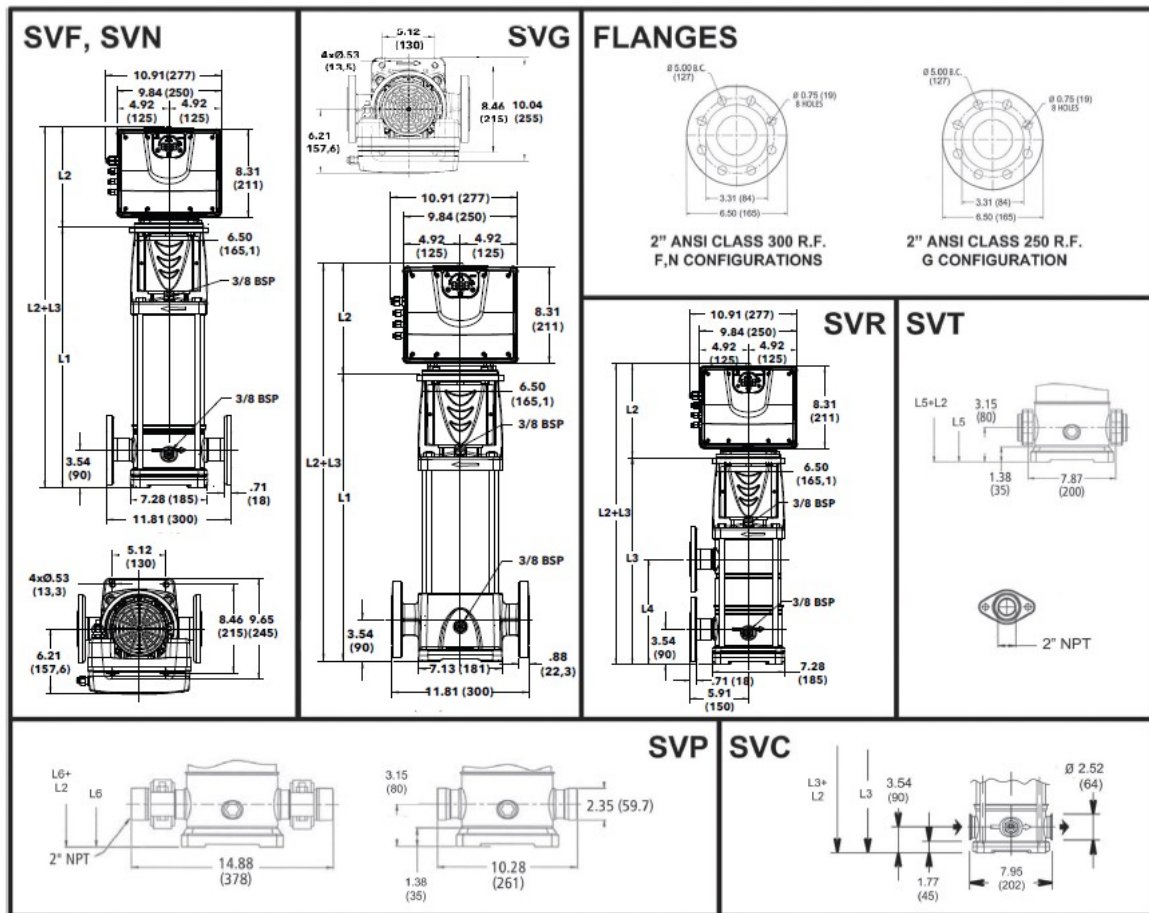

Drawing is preliminary and is subject to change.

Dimensions

| Dimension | Value | Total Weight |
|---------------------|-----------|--------------|
| L1 | 17.01 in | 64 lbs |
| L2 | 9.53 in | |
| L5 | 16.17 in | |
| L6 | 16.17 in | |
| D1 (MAX.) | 5.2 in | |
| NEMA Frame | 90R | |
| Weight (Pump Only) | 36 lbs | |
| Weight (Motor Only) | 27.78 lbs | |

| | |
|------------------|---------------------|
| Company | PFC Equipment |
| Contact | Kelly Kresa |
| Phone No. | 7633915856 |
| Email | kkresa@pfcequip.com |