



1SVE4GA4YM0

Created On: 1/8/26

1SVE4GA4YM0 | Configuration Summary



e-SVE series is equipped with an intelligent control that optimizes hydraulic performance while minimizing waste. It is a pre-programmed package combining the e-SV multi-stage pump with a Xylem Smart Motor – an “ultra-premium” level IES permanent magnet motor with a wide range of monitoring, control and safety features.

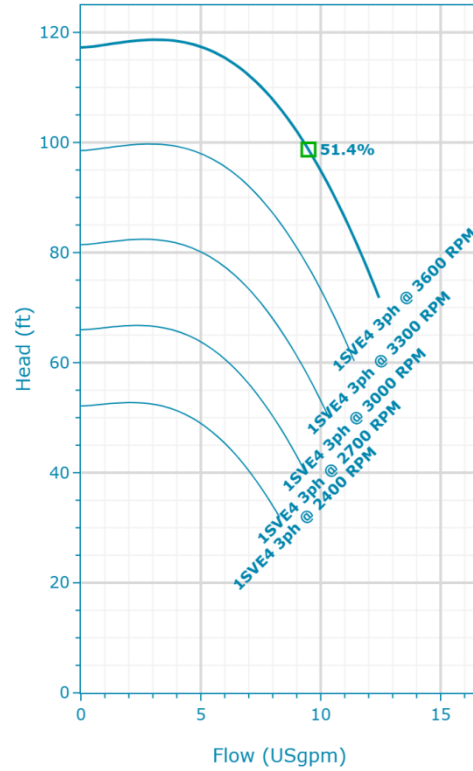

Performance according to ISO 9906:2012

PUMP

Installation
Complete Pump

MATERIALS

| | |
|--|--|
| Pump Body Material Cast Iron (ASTM Class 35/40B) | Impeller Material Stainless Steel (AISI 304) |
|--|--|

SEAL

| | |
|---|---|
| Type of Seal Mechanical Seals | Rotating Face Carbon |
| | Stationary Face Silicon Carbide Graphite Filled |
| | Elastomers Viton |
| | Spring 316 SS |
| | Metal Component 316 SS |

STANDARD OPTIONS

Special Configuration
Please Select

MOTOR

| | |
|--------------------------|-------------------------------------|
| Poles 2 | Power 0.5 hp |
| Enclosure TEFC | Phase (~) 3 |
| | Voltage 208-240/380-460 V |

FLANGE

Flange
[G] = Round Flanges (AISI 304/Cast Iron)

1SVE4GA4YM0 | Product Details

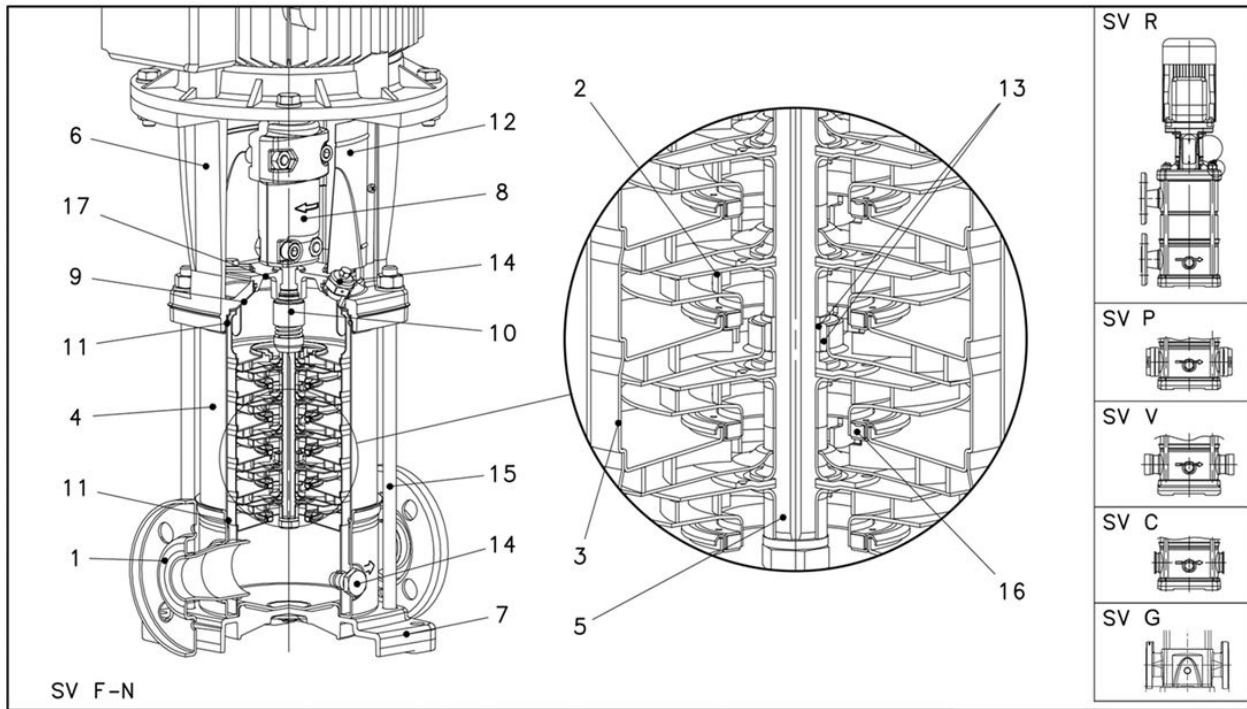

Construction Materials

| | | | |
|---|---|--|--|
| Pump Body (1) Cast Iron (ASTM Class 35/40B) | Shaft (5) Stainless Steel (AISI 316) | Seal Plate (9) Stainless Steel (AISI 316L) | Fill/Drain Plugs (14) Stainless Steel (AISI 316) |
| Impeller (2) Stainless Steel (AISI 304) | Adapter (6) Cast Iron (ASTM Class 35/40B) | Elastomers (11) Refer Mechanical Seals | Tie Rods (15) Carbon Steel / Zinc Plated (A29 Gr.1045) |
| Diffuser (3) Stainless Steel (AISI 304) | Base (7) N/A | Coupling Guard (12) Stainless Steel (AISI 304) | Wear Ring (16) PPS |
| Casing (4) Stainless Steel (AISI 316L) | Coupling (8) Aluminum (A384.0-F) | Shaft Sleeve and Bushing (13) Tungsten Carbide | Seal Gland (17) Stainless Steel (AISI 316) |

Motor

| | | | |
|----------------------------|---|-----------------------------------|-----------------------------------|
| Enclosure TEFC | Rated Power 0.5 Hp | Phase 3 | SLA 2.13-1.83/1.43-1.33 |
| Speed 3600.0 rpm | Rated Voltage 208-240/380-460 V | FLA 2.13-1.83/1.43-1.33 | |

1SVE4GA4YM0 | Hydraulic Data & Performance Curve

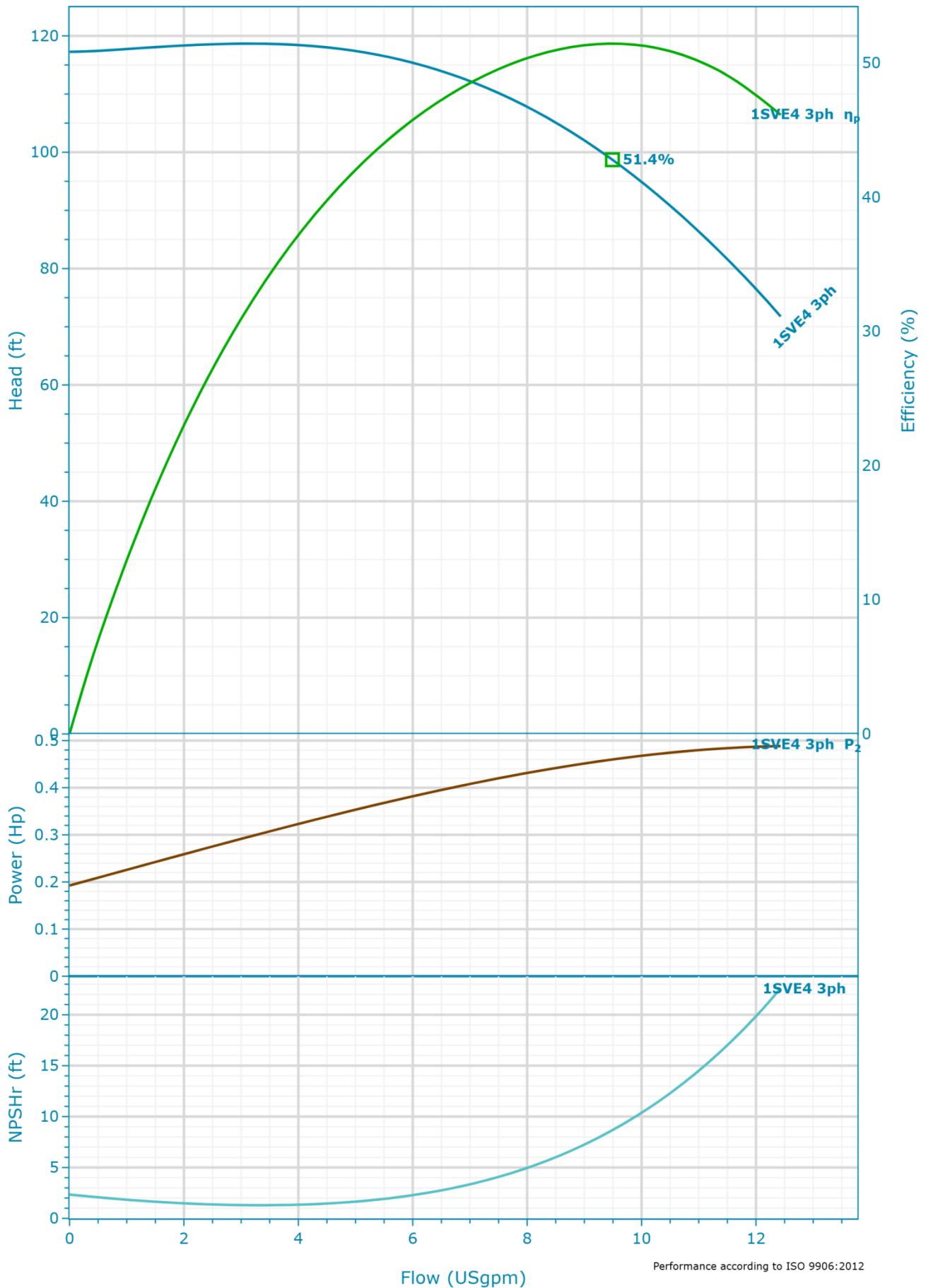

Selection

| | |
|-------------------------|-----------------|
| Series | Standby Pumps |
| e-SVE | No Standby Pump |
| Name | |
| 1SVE4 3ph 3600rpm | |
| Stages | |
| 4 | |
| Frequency | |
| 60 Hz | |
| Acceptance Grade | |
| Manufacturer's Standard | |
| System Type | |
| Single Pump | |
| Operating Pumps | |
| 1 | |

Fluid and Operating Conditions

| | |
|--------------------------|--------------------------|
| Fluid Type | Density |
| Water | 62.43 lb/ft ³ |
| Fluid Temperature | Dynamic Viscosity |
| 39.2 °F | 1.57 cP |
| Specific Gravity | Fluid Vapor Pressure |
| 1 | 0.12 psi |
| | Atmospheric Pressure |
| | 14.7 psi |
| | Elevation |
| | 0 ft |
| | Ambient Temperature |
| | 68 °F |
| | NPSH Available |
| | 33.68 ft |
| | Submergence |
| | 0 ft |

Design Curve

| | |
|--------------------|------------------------|
| Rated Speed | BEP Flow |
| 3,600 RPM | 9.49 USgpm |
| Max Flow | BEP Head |
| 12.43 USgpm | 98.71 ft |
| H@QMin | Max Operating Pressure |
| 117.26 ft | 51.37 psi |
| H@QMax | Max P2 |
| 71.78 ft | 0.49 Hp |
| BEP | |
| 51.45 % | |

1SVE4GA4YM0 | Variable Speed Curve

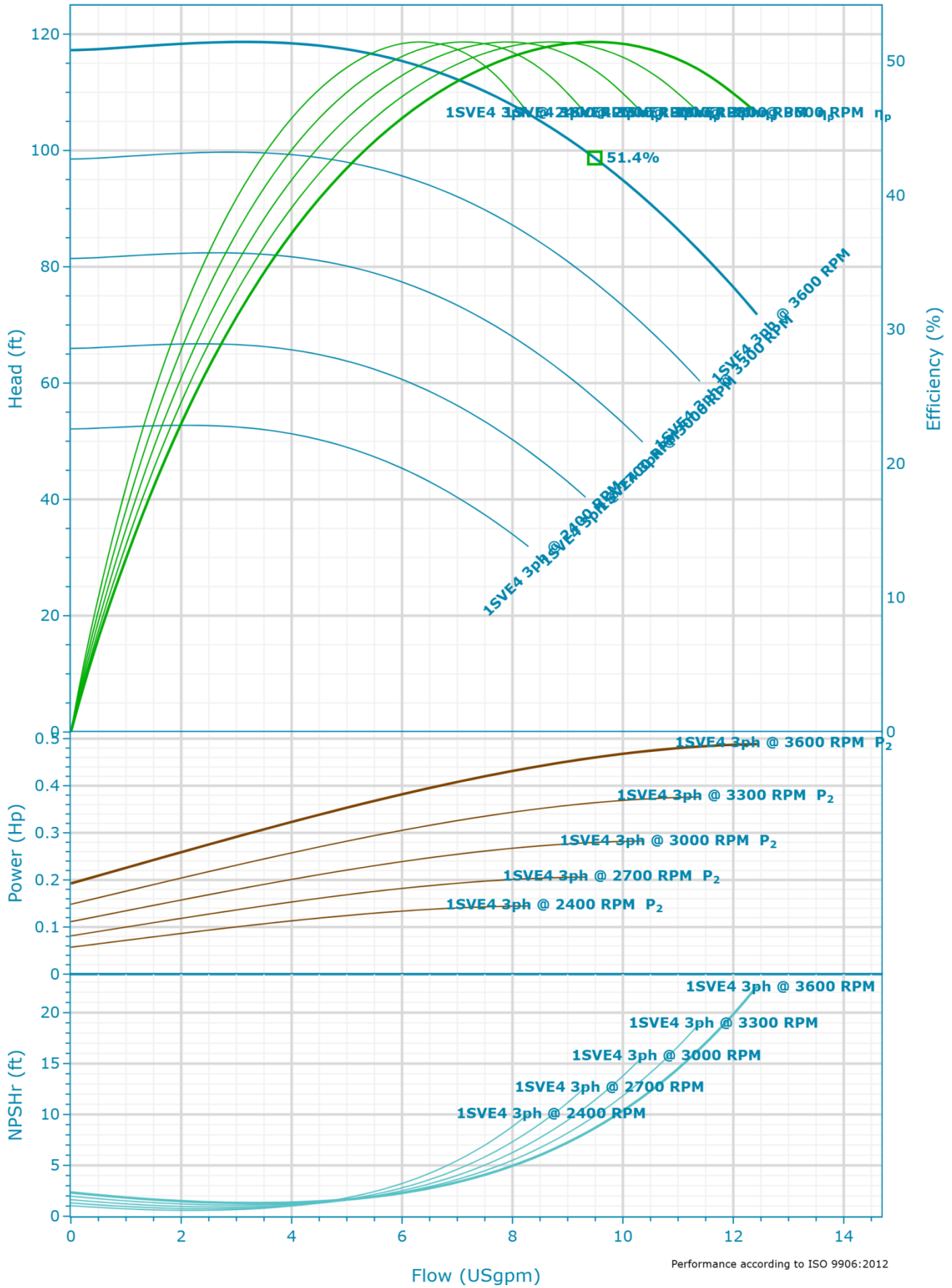

1SVE4GA4YM0 | Dimensional Data & Drawing

**1, 3, 5SVE SERIES - THREE PHASE VERSION
DIMENSIONS AND WEIGHTS**

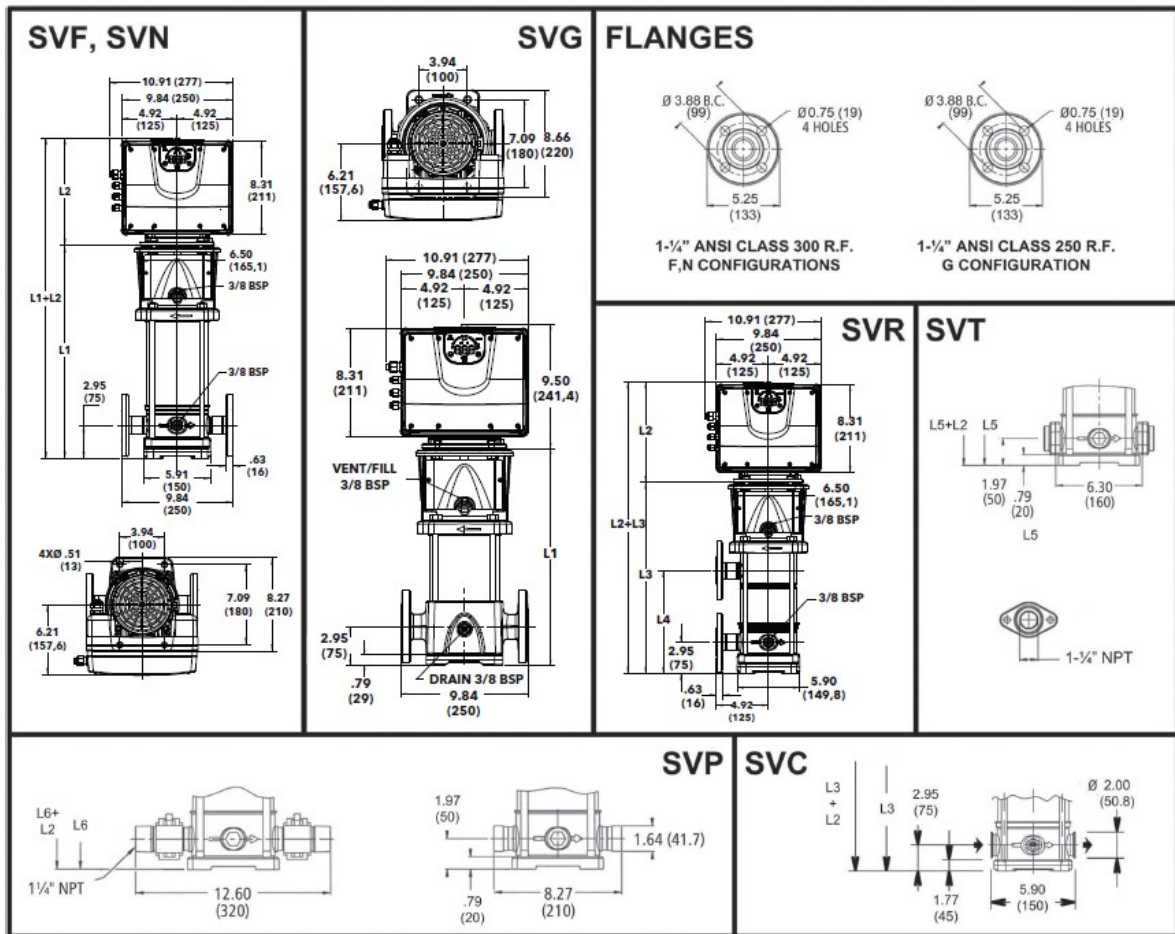

All dimensions are in inches (mm).

Drawing is preliminary and is subject to change.

Dimensions

| Dimension | Description | Value |
|-----------|---------------------|---------------------|
| L1 | D1 (MAX.) | 14.28 in / 5.2 in |
| L2 | NEMA Frame | 9.53 in / 90R |
| L5 | Weight (Pump Only) | 13.1 in / 27 lbs |
| L6 | Weight (Motor Only) | 13.1 in / 27.78 lbs |
| | Total Weight | 55 lbs |

| | |
|------------------|--------------------|
| Company | PFC Equipment |
| Contact | Corey Nath |
| Phone No. | 7634257890 |
| Email | cnath@pfcequip.com |